

AGENDA

HIGHWAY, INFRASTRUCTURE & RECREATION COMMITTEE

DATE: Thursday, April 7, 2022
TIME: 9:00 a.m.
PLACE: Wood County Highway Dept.
555 17th Ave North
Wisconsin Rapids, WI 54495

1. Call meeting to order
2. Declaration of quorum
3. Public comments
4. Correspondence
5. Approve minutes from previous committee meetings
6. ATV Trail/Route system update
 - a. Town of Port Edwards – Batterman Road
 - b. Route Designations
7. **HIGHWAY**
 - a. Highway staff reports
 - b. Highway revenue report
 - c. Highway vouchers
 - d. Mailbox Policy
 - e. Quotes
 - i. Asphalt Roller
 - ii. Milling and Pulverizing
 - iii. Aluminum Box Culverts
 - f. Recognize Work Zone Safety Awareness Week
 - g. CIP
 - h. Project updates
 - i. 2022-2027 STP Local Program Approved Projects
 - ii. CTH U Resolution with Village of Biron
8. **PARKS AND FORESTRY**
 - a. Parks & Forestry staff reports
 - b. Special Use permits
 - c. Powers Bluff bike trail construction project bid
 - d. Funding Powers Bluff trail construction project
 - e. Draft CIP summary
 - f. Timber Sale Contract Extensions : #741, #744, #775
 - g. Parks and Forestry revenue reports
 - h. Parks & Forestry vouchers
9. Future Agenda Items
10. Set Organizational meeting date and time
11. Set next regular meeting date: May 5, 2022 at 9:00 am at Wood County Highway Department,
555 17th Ave North, Wisconsin Rapids, WI 54495
12. Adjournment

Join by phone

+1-408-418-9388 United States Toll
Meeting number (access code): 2493 807 6510

Join by WebEx App or Web

<https://woodcountywi.webex.com/woodcountywi/j.php?MTID=mdca62319974845b86385455c8cfaf831>

Meeting number (access code): 2493 807 6510

Meeting password: 04072022

MINUTES OF THE HIGHWAY, INFRASTRUCTURE & RECREATION COMMITTEE

DAY AND DATE: Thursday, March 3, 2022
PLACE: Highway Department, 555 17th Ave N, Wisconsin Rapids, WI 54495
MEETING TIME: 9:00 a.m.
ADJOURNMENT TIME: 10:35 a.m.
MEMBERS PRESENT: Chairperson Jake Hahn, Supervisor Dave LaFontaine, Supervisor Lee Thao, Supervisor John Hokamp

COMMITTEE MEMBERS PRESENT VIA WEBEX: Supervisor Al Breu

OTHERS PRESENT: Roland Hawk, Highway Commissioner; Chad Schooley, Parks & Forestry Director; Fritz Schubert, Forest Administrator; Supervisor Dennis Polach, Sandra Green, Wood County Parks & Forestry Office Supervisor; Gavin Hutchinson, WI DNR, Bill Hatch, Cranberry Creek Cranberries; Lyle Eiden, WI DNR; Curt Pluke, Wood County Wildlife Area Committee Member; Kathleen Plucinski, Town Chairman for Remington and Joel Ortman, Wood County Hwy. Dept., Engineer.

OTHERS PRESENT VIA WEBEX: John Moder, Cranberry Creek Campground; Dawn Schmutzer, Wood County Wildlife Area Secretary; Lance Pliml, Wood County Board Chairman; Supervisor Bill Clendenning;

1. Call meeting to order. Meeting called to order at 9:00 am.
2. Declaration of quorum. Declared.
3. Public comments. Supervisor Clendenning wanted to state that he attended the Richfield meeting last night and was very impressed with the number of attendees, which included 12 Towns, 3 Villages and 28 officials present.
R. Hawk stated that road postings will most likely begin the week of March 14.
4. Correspondence. None.
5. Approve minutes from previous committee meetings. **Motion to approve minutes by D. LaFontaine and second by A. Breu. Motion carried.**
6. ATV Trail/Route system update
 - a. Route Updates. R. Hawk stated signs are ordered and will begin placing by mid-to late March and completed mid-April. A map of all new routes that will open will be generated between the Hwy. Dept. and P&Z and posted on the Parks and Hwy. websites.
 - b./c. Town of Remington Trail Request in County/State Forest & ATV access on Wood County Wildlife Area property:
Kathy Plucinski, Chair for the Town of Remington is present with a request to assist the Cranberry Creek Campground regarding ATV trail/route access directly from the campground to Hwy. X. R. Hawk, provided his input and agreed at this point in time, the DOT is against opening up State Hwy. 173/80 for access. However, if we really want to push this request, he would reach out to them again see if something can be done. Chair, J. Hahn asked R. Hawk to do that and keep the committee apprised of his progress. F. Schubert and C. Pluke offered comments on the request and why it would or would not work. R. Hawk is going to inquire to the DOT whether there is a location that can be utilized off-road or off-pavement, possibly the Right-of-Way or ditches in order to get to where they need to go. Board Chairman Pliml also agreed that this issue could be pushed as much as possible as the traffic there is very limited and we should explore all other options in order to accommodate this campground. F. Schubert's comment is that if this moves forward and approved, there will surely be some maintenance and signage expenses. This would need to be discussed as to who would be responsible for these

costs. K. Plucinski also commented that possibly the Juneau County/Wood County line at 173 will be worked on yet this year, possibly they could widen the shoulder a little at 173 and 80.

7. HIGHWAY

- a. Highway staff reports. R. Hawk commented that Highway's Program Assistant, Rachel Krause put together a report that showed accidents on County Highways, how much time staff put in for accidents, traffic control, repairs, etc. as a way of tracking expenses. Once they send out an invoice to recoup these reimbursements, if they are not paid, they go through the TRIP (Tax Revenue Intercept Process) through the IRS; those costs are garnished from that person's tax refund and paid to the county. So far, over \$26k has been paid back through this process and there is more dollars coming in the near future.
- b. Highway revenue report. Doing well and the accountant should have final 2021 numbers by the end of this month.
- c. Highway vouchers. **Motion by D. LaFontaine and second by J. Hokamp to approve Highway bills. Motion carried.**
- d. Out of State Travel for Commissioner. R. Hawk is requesting permission to attend a WCHA conference in Buffalo, NY. The expenses will be paid by WCHA. **Motion to allow out of state travel for R. Hawk by D. LaFontaine and second by Lee Thao. Motion carried.**
- e. IJJA Funded Project. This is an opportunity by the Village of Biron to take back a local road. R. Hawk will meet with P. Kastenholz to draft a resolution regarding County Trunk U along the River to Hwy. 54/County Line.
- f. ARPA Fund Request. Projects include rebuilding of CTY A, CTH F, BB & 10 and K & P. If applied for, would all need to be completed by EOY, 2027. Chair Hahn, encouraged R. Hawk to apply for all the 80/20 grants he is able to and we go from there. R. Hawk said he would do this.
- g. Bituminous Bids. Bid information handed out. R. Hawk stated that they save a lot of money by doing their own recycling. Only eight counties in the State of WI have their own asphalt plants and Wood County is one of them. **Motion by D. LaFontaine and second by A. Breu to accept the bid that is most advantageous to Wood County. Motion carried.**
- h. Sand and Aggregates Quotes. There is a slight increase this year in quotes. **Motion by D. LaFontaine and second by L. Thao to accept the quote that is most advantageous to Wood County. Motion carried.**
- i. Future Wetland Mitigation and Material Storage Sites. There is a 20-acre site on Hwy. C in the Town of Sigel they have. R. Hawk explained this information as credits and debits for wetland mitigation and how it works. He is asking for permission to keep options open for a future location and to watch the market to create a site in the future to sell to local municipalities. The price for something like this is around \$75k. It would benefit the county in every way. **Motion by J. Hahn and second by A. Breu to bring information to the HIRC when this opportunity opens up for discussion. Motion carried.**
- j. Engineering Position. Joel Ortman, current Engineer has submitted his resignation. R. Hawk would like to post this open position as soon as possible so qualified candidates can be interviewed, someone hired and hopefully brought in to train with Joel if at all possible before his last day, which is sometime at the end of July. We wish you the best of luck Joel in your future endeavors!
- k. Mailbox Reimbursement Policy. Currently, there is not a formal or written policy for this. R. Hawk is requesting to develop a policy on the cap of dollars for reimbursement. It was agreed and approved the cap would be \$100 for purchase and installation of the mailbox. In order to have a landowner's mailbox replace, it has to have been physically "struck" by a county vehicle or entity. The written policy will be developed and brought back to HIRC for approval. **Motion by D. LaFontaine and second by L. Thao to move forward with writing and developing a Mailbox Replacement Policy for the Highway Dept. not to exceed \$100 for purchase and installation Motion carried.**

8. PARKS AND FORESTRY

- a. Parks & Forestry staff reports. C. Schooley added that today they made a decision to close Powers Bluff for the season due to the weather coming on Saturday. The snowmobile trails are also closed. The multi-use trails remain open but are in poor/fair condition at this time. The CEED committee approved funding a promotional video to be done out at Powers Bluff but due to the company not being able to get out there while the Bluff was open, it may now be pushed back to next season.
- b. Special Use permits.
 - ✚ Midwest Disc Golf Association, NP, May 7, 2022, full closure, 7am-7pm.
 - ✚ Annual Dairy Fest, Disc Golf Event, full closure, June 4, 2022, 7am-7pm.
 - ✚ Yellow River Rendezvous, Disc Golf Event, September 10, 2022, 7am-7pm.
 - ✚ Blue Grass at the Lake Event, SP, June 9 – June 12, 2022. Use of shelters.

Motion by D. LaFontaine and second by J. Hokamp to accept the Special Use Permits. Motion carried.
- c. Ditch Cleaning Project/Request – Bill Hatch, Cranberry Creek Cranberries. F. Schubert commented that drainage ditches are an issue that come to the committee from time to time. Ditch cleaning projects in the past have been somewhat complicated and potentially controversial, but more recently have seemed easier to accomplish. Typically major concerns are: 1) What to do with timber that has grown on the ditch banks and how the county is to be compensated for their value. 2) Environmental issues and obtaining proper permitting from agencies having jurisdiction. Past Committees have been in favor of working with cranberry growers to clean sections of ditches as long as the county doesn't incur expenses, and necessary permits are obtained. Ditch bank timber in relation to this project is located in areas convenient for decking and hauling to park sites for use as firewood. F. Schubert has contacted a logger about harvesting the timber and the logger is willing to cut and skid the wood for the same rate as other loggers who have cut wood for use in our campgrounds. Bill Hatch has also indicated he would be willing to bring in an excavator to assist the logger in removing difficult trees. Trees will only be cleared from one side of the ditch. Once wood is removed, cranberry grower would use his own machinery to remove sediment and debris from the ditch in order to improve flow. Mr. Hatch has contacted the Army Corps of Engineers and Wisconsin DNR in order to begin the process of obtaining necessary permits. Schubert just wanted to make the committee aware of this process and is seeking approval to allow Bill Hatch from Cranberry Creek Cranberries to work with Wood County Forest Administrator on this project. **Motion to allow Cranberry Creek Cranberries and Forest Administrator, Fritz Schubert to work together on this project by J. Hokamp and second by D. LaFontaine. Motion carried.** Comment by F. Schubert that it will be necessary to close Hazelnut Trail for a short time.
- d. County Forest Land withdrawal request. Discussion led by F. Schubert, Forest Administrator and G. Hutchinson, DNR Forester regarding an individual who has made an application to the county to withdraw a small parcel and transfer ownership/sell the land to him. The parcel in question is located in the Town of Dexter, and is situated adjacent to a section of Goose Lane that was previously abandoned by the Township. Schubert referred the committee to packet items dealing with procedures and requirements relating to land withdrawals from the County Forest program. Hutchinson gave some insight and relayed some information gained from preliminary questions to DNR personnel who would be involved in the process. The likelihood of this particular proposal gaining DNR approval is slim. Additionally it could bring into question how the section of Goose Lane was abandoned many years ago. Land withdrawals are a time consuming process involving several individuals from both state and county. Those proposals that have little chance of passing may not be worth the effort. Chairman Hahn advised F. Schubert not to invest any more effort on this withdrawal at this time. Additionally Chairman Hahn will contact the individual and provide further direction as necessary.

- e. Parks and Forestry revenue reports. Reviewed.
 - f. Parks & Forestry vouchers. **Motion to approve Parks & Forestry revenue reports by D. LaFontaine and second by J. Hokamp. Motion carried.**
 - 9. Future Agenda Items
 - 10. Set next regular meeting date: April 7, 2022 at 9:00 am at Wood County Highway Department, 555 17th Ave North, Wisconsin Rapids, WI 54495
 - 11. Adjournment. Meeting adjourned at 10:35 am.
-

Recording Secretary, Sandra Green, Wood County Parks & Forestry Office Supervisor



Wood County

WISCONSIN

OFFICE OF
HIGHWAY COMMISSION

Roland Hawk
COMMISSIONER

March 30, 2022

To: Highway, Infrastructure & Recreation Committee

From: Roland Hawk, Highway Commissioner

Subject: Commissioner Report for April 7, 2022 HIRC meeting

Department Activities

Personnel/Administration

The Highway Department currently has a mechanic position open. HR has posted the position and interviews will be conducted as applicants become available. Offers have been made and accepted for two vacant truck operator openings.

The engineer position has been advertised for two weeks and an interview will be conducted March 31.

Commissioner is scheduled to attend the National Association of County Engineers (NACE) conference in Buffalo, NY April 24 – 27. As WCHA President, expenses including airfare, lodging, meals, and registration are reimbursed by the WCHA.

Commissioner met with the Town of Grand Rapids March 8 to discuss impacts, cost sharing, and schedule for proposed round-about projects at CTH W & 48th St and CTH Z & 48th Street.

Commissioner conducted a Traffic Safety Committee meeting on March 9. During this meeting the TSC introduced a Grant Proposal for a Predictive Analytics Traffic Safety Project for Wood County.

Commissioner attended the NC Region Commissioner meeting in Lincoln County on March 16.

Several training dates and opportunities are scheduled in April & May:

- April 12 Pesticide Application Certification
- April 12 Chainsaw Safety Training
- April 14 Department Spring Training
- May 2 – 4 Work Zone Certification Training
- May 10 County Mutual Safety Days

Highway/Facility Projects

2022 Construction Projects:

- CTH X from STH 54 to STH 73
 - The comment period for Individual (wetland) Permit concluded on 3/13/2022 and WDNR did not receive any public comments or requests for a public hearing. The permit should be issued in the next 30 days.
 - Contractor is anticipating a June 15 start date.

- CTH O & CTH PP

- Bids for pulverizing will be approved at April HIRC and work is scheduled to begin in July.

CTH U – Village of Biron: Commissioner was notified by WisDOT that the STP-Urban Grant submitted in December for a segment of CTH U (referred to as Segment 2) in the “CTH U - Village of Biron” resolution, was not approved. However, there will be additional opportunities to request funding in the coming months. Commissioner and Village President with assistance from Corporation Council have developed a resolution that lays out a plan to reconstruct CTH U within the village and jurisdictional transfer that roadway to the village as a local road. See attached resolution and map.

Commissioner is scheduled to meet with Marshfield Public Works Director to continue discussions and develop next steps in the Marshfield Shared Campus Study. Due to scheduling conflicts in March, no meetings between Highway and Marshfield PWs were held.

Projects approved in the 2022 – 2027 STP-Rural program submitted in December include:

CTH N Bridge replacement (located 0.1 miles east of STH 186) FY 2024

CTH HH & CTH F Intersection (recommended improvement is a roundabout) FY 2026

Wood County has been awarded Tribal Transportation Funding from Ho-Chunk Roads Division for the following:

CTH Z (from STH 73 – STH 13) FY 2024

CTH F (from CTH HH – 17th Ave) FY 2025

Highway Maintenance

Work in March included:

- clearing brush and vegetation from R/W on both County and Local roads
- repairing cracks, dips and potholes on State, County & Local highways
- removing snow fence
- thawing a few frozen/plugged driveway culverts
- restoring drainage in ditches
- plowing, salting & applying brine

ATV Plan/Development

Crews will begin installing new signs as outlined in the adopted ATV ordinance as soon as frost conditions permit.

The Town of Port Edwards has contacted the commissioner to see if the County would provide the town with some maintenance of Batterman Road where ATV traffic has caused some damage to the gravel surface.

Commissioner recommends the discontinuance of official Wood County ATV routes. With the new ATV ordinance opening the majority of County Highways, and with the majority of most Town Roads open to ATV traffic, a designated route is no longer necessary for guiding riders through the county. This will eliminate the need for the County to make repairs to local roads open to ATV traffic.

Equipment/Machinery

Bids for a new asphalt roller will be presented to the HIRC on April 7 for approval. The Department purchased a used flatbed truck and water tank for the asphalt paving crew to use with the new asphalt roller. This truck will also be used as the primary tow vehicle for the second truck mounted attenuator.

Accounting Supervisor Report

By John Peckham, Wood County Highway Department Accounting Supervisor

HIRC Meeting

Revenues

Revenues are as anticipated in most areas. State Charges are down a bit, likely due to the relatively mild winter.

Expenses

Expenses are as anticipated in most areas.

Snow budget appears to be in good shape at this time. It is about 50% expended.

Other

I have completed the audit workpapers and forwarded them to Finance. Rachel Krause has completed Finance's Capital Improvement Plan worksheets and they will be forwarded to Finance. The HIRC previously approved the Highway Department Capital Improvement Plan.

County of Wood
 DETAILED INCOME STATEMENT W/SUBTOTALS
 Highway Departmentwide
 Thursday, March 31, 2022

	Actual	2022 Budget	Variance	Variance %
REVENUES				
Intergovernmental Revenues				
43531 State Aid-Transportation	\$624,440.51	\$2,497,341.00	(\$1,872,900.49)	(75.00%)
43534 State Aid-LRIP	218,258.31	995,000.00	(776,741.69)	(78.06%)
Total Intergovernmental	842,698.82	3,492,341.00	(2,649,642.18)	(75.87%)
Licenses and Permits				
44101 Utility Permits	5,800.00	16,000.00	(10,200.00)	(63.75%)
Total Licenses and Permits	5,800.00	16,000.00	(10,200.00)	(63.75%)
Intergovernmental Charges for Services				
47230 State Charges	168,595.58	982,087.00	(813,491.42)	(82.83%)
47231 State Charges-Highway	86,197.05	579,812.00	(493,614.95)	(85.13%)
47232 State Charges-Machinery	13,226.70		13,226.70	0.00%
47300 Local Gov Chgs	89,066.85	510,567.00	(421,500.15)	(82.56%)
47330 Local Gov Chgs-Transp	122,276.14	1,102,945.00	(980,668.86)	(88.91%)
47332 Local Gov Chgs-Roads		416,344.00	(416,344.00)	(100.00%)
47333 Local Gov Chgs-Bridges		80,996.00	(80,996.00)	(100.00%)
Total Charges to Other Governments	479,362.32	3,672,751.00	(3,193,388.68)	(86.95%)
Interdepartmental Charges for Services				
47470 Dept Charges-Highway	5,524.87	2,231,470.00	(2,225,945.13)	(99.75%)
Total Interdepartmental Charges	5,524.87	2,231,470.00	(2,225,945.13)	(99.75%)
Total Intergovernmental Charges for Services	484,887.19	5,904,221.00	(5,419,333.81)	(91.79%)
Miscellaneous				
48340 Gain/Loss-Sale of Salvage and Waste	2,095.12	6,700.00	(4,604.88)	(68.73%)
48500 Donations	1.15		1.15	0.00%
48520 Grants/Contribution-ATV Route Signage		20,000.00	(20,000.00)	(100.00%)
Total Miscellaneous	2,096.27	26,700.00	(24,603.73)	(92.15%)
Other Financing Sources				
49110 Proceeds from Long-Term Debt		2,500,000.00	(2,500,000.00)	(100.00%)
Total Other Financing Sources		2,500,000.00	(2,500,000.00)	(100.00%)
TOTAL REVENUES	1,335,482.28	11,939,262.00	(10,603,779.72)	(88.81%)
EXPENDITURES				
Public Works-Highway				
53110 Hwy-Administration	82,858.24	370,297.59	287,439.35	77.62%
53120 Hwy-Engineer	43,276.30	262,643.14	219,366.84	83.52%
53191 Hwy-Other Administration	89,490.34	333,997.09	244,506.75	73.21%
53210 Hwy-Employee Taxes & Benefits	(683,988.43)		683,988.43	0.00%
53220 Hwy-Field Tools	(17,989.67)		17,989.67	0.00%
53230 Hwy-Shop Operations	67,586.06	309,473.49	241,887.43	78.16%
53232 Hwy-Fuel Handling	(3,212.01)	(23,105.00)	(19,892.99)	86.10%
53240 Hwy-Machinery Operations	(328,740.03)	(152,968.72)	175,771.31	(114.91%)
53260 Hwy-Bituminous Ops	20,102.67	228,435.29	208,332.62	91.20%
53262 Hwy-Bituminous Ops	474.89		(474.89)	0.00%
53266 Hwy-Bituminous Ops	1,393.26	1,983,034.65	1,981,641.39	99.93%
53270 Hwy-Buildings & Grounds	47,969.48	273,351.67	225,382.19	82.45%
53290 Hwy-Salt Brine Operations	(7,169.29)		7,169.29	0.00%
53291 Hwy-Salt Brine Operations	(22,979.34)		22,979.34	0.00%
53281 Hwy-Acquisition of Capital Assets	347,777.51		(347,777.51)	0.00%
53310 Hwy-Maintenance CTHS		22,193.52	22,193.52	100.00%
53311 Hwy-Maint CTHS Patrol Sectn	379,880.21	2,861,610.77	2,481,730.56	86.72%
53312 Hwy-Snow Remov	412,378.78	907,384.83	495,006.05	54.55%
53313 Hwy-Maintenance Gang	24,443.14	106,422.57	81,979.43	77.03%
53314 Hwy-Maint Gang-Materials	17,708.69	2,900.00	(14,808.69)	(510.64%)
53320 Hwy-Maint STHS	396,857.07	982,087.43	585,230.36	59.59%
53330 Hwy-Local Roads	142,174.68	1,102,944.74	960,770.06	87.11%
53340 Hwy-County-Aid Road Construction		469,914.74	469,914.74	100.00%
53341 Hwy-County-Aid Bridge Construction		130,995.91	130,995.91	100.00%
53490 Hwy-State & Local Other Services	89,571.23	550,567.08	460,995.85	83.73%
53491 Hwy-ATV Route Signage	11,204.78		(11,204.78)	0.00%
Total Public Works-Highway	1,111,068.56	10,722,180.79	9,611,112.23	89.64%
Capital Outlay				
57310 Highway Capital Projects	26,685.09	2,472,164.57	2,445,479.48	98.92%

County of Wood
 DETAILED INCOME STATEMENT W/SUBTOTALS
 Highway Departmentwide
 Thursday, March 31, 2022

	Actual	2022 Budget	Variance	Variance %
Total Capital Outlay	26,685.09	2,472,164.57	2,445,479.48	98.92%
TOTAL EXPENDITURES	1,137,753.65	13,194,345.36	12,056,591.71	91.38%
NET INCOME (LOSS) *	197,728.63	(1,255,083.36)	1,452,811.99	(115.75%)

Committee Report

County of Wood

Report of claims for: HIGHWAY

For the period of: FEBRUARY

For the range of vouchers: 16220243 - 16220467

Voucher	Vendor Name	Nature of Claim	Doc Date	Amount	Paid
16220243	AMAZON CAPITAL SERVICES	OFFICE SUPPLIES	01/24/2022	\$20.09	P
16220244	COMPASS MINERALS	SALT FOR SNOW AND ICE CONTROL	02/08/2022	\$42,146.58	P
16220245	WESTWOOD INFRASTRUCTURE	CTH U EXTENSION	02/17/2022	\$2,230.49	P
16220246	US BANK	PROCUREMENT CARD PURCHASES	02/17/2022	\$1,649.35	P
16220247	TOWN OF RICHFIELD	HALL RENTAL	02/23/2022	\$200.00	P
16220248	ADVANCE JANITORIAL SERVICE & SUPPLY	CARPET/FLOOR & CLEANING SVC	02/25/2022	\$597.50	P
16220249	AT&T-ATLANTA	TELEPHONE (MFLD)	02/21/2022	\$42.39	P
16220250	RON'S REFRIGERATION & AC INC	HVAC REPAIR	02/24/2022	\$1,045.00	P
16220251	SHERWIN INDUSTRIES INC	ROADSAVER RUBBER CRACKFILL	02/23/2022	\$26,032.84	P
16220252	SOLARUS	TELEPHONE - WR & HOT MIX	03/01/2022	\$142.98	P
16220253	WATER WORKS & LIGHTING COMM	UTILITIES - WR & HOT MIX	02/24/2022	\$28.02	P
16220254	WATER WORKS & LIGHTING COMM	UTILITIES - WR & HOT MIX	02/24/2022	\$3,461.05	P
16220255	WATER WORKS & LIGHTING COMM	UTILITIES - WR & HOT MIX	02/24/2022	\$13.89	P
16220256	WATER WORKS & LIGHTING COMM	UTILITIES - WR & HOT MIX	02/24/2022	\$921.44	P
16220257	WATER WORKS & LIGHTING COMM	UTILITIES - WR & HOT MIX	02/24/2022	\$717.37	P
16220258	WI COUNTY HIGHWAY ASSOCIATION	WORK ZONE CERTIFICATION	02/28/2022	\$1,235.00	P
16220259	ACE HARDWARE	PARTS	02/23/2022	\$149.42	P
16220260	ACE HARDWARE	PARTS	02/14/2022	\$22.36	P
16220261	AMERICAN STATE EQUIPMENT CO INC	PARTS	02/24/2022	\$673.24	P
16220262	ADVANCE AUTO PARTS (Wis Rapids)	PARTS	02/01/2022	(\$36.97)	P
16220263	ADVANCE AUTO PARTS (Wis Rapids)	PARTS	02/02/2022	\$298.94	P
16220264	ADVANCE AUTO PARTS (Wis Rapids)	PARTS	02/02/2022	\$686.46	P
16220265	ADVANCE AUTO PARTS (Wis Rapids)	PARTS	02/02/2022	\$13.78	P
16220266	ADVANCE AUTO PARTS (Wis Rapids)	PARTS	02/03/2022	(\$60.00)	P
16220267	ADVANCE AUTO PARTS (Wis Rapids)	PARTS	02/03/2022	\$32.19	P
16220268	ADVANCE AUTO PARTS (Wis Rapids)	PARTS	02/03/2022	\$116.57	P
16220269	ADVANCE AUTO PARTS (Wis Rapids)	PARTS	02/03/2022	\$30.38	P
16220270	ADVANCE AUTO PARTS (Wis Rapids)	PARTS	02/03/2022	\$22.38	P
16220271	ADVANCE AUTO PARTS (Wis Rapids)	PARTS	02/03/2022	\$97.58	P
16220272	ADVANCE AUTO PARTS (Wis Rapids)	PARTS	02/03/2022	\$26.11	P
16220273	ADVANCE AUTO PARTS (Wis Rapids)	PARTS	02/03/2022	\$81.68	P
16220274	ADVANCE AUTO PARTS (Wis Rapids)	PARTS	02/04/2022	\$93.79	P
16220275	ADVANCE AUTO PARTS (Wis Rapids)	PARTS	02/04/2022	\$44.10	P
16220276	ADVANCE AUTO PARTS (Wis Rapids)	PARTS	02/04/2022	\$115.04	P

HIGHWAY - FEBRUARY

16220243 - 16220467

Voucher	Vendor Name	Nature of Claim	Doc Date	Amount	Paid
16220277	ADVANCE AUTO PARTS (Wis Rapids)	PARTS	02/04/2022	\$53.27	P
16220278	ADVANCE AUTO PARTS (Wis Rapids)	PARTS	02/07/2022	(\$127.96)	P
16220279	ADVANCE AUTO PARTS (Wis Rapids)	PARTS	02/07/2022	\$8.38	P
16220280	ADVANCE AUTO PARTS (Wis Rapids)	PARTS	02/07/2022	\$205.21	P
16220281	ADVANCE AUTO PARTS (Wis Rapids)	PARTS	02/07/2022	\$107.89	P
16220282	ADVANCE AUTO PARTS (Wis Rapids)	PARTS	02/08/2022	\$39.19	P
16220283	ADVANCE AUTO PARTS (Wis Rapids)	PARTS	02/09/2022	(\$104.18)	P
16220284	ADVANCE AUTO PARTS (Wis Rapids)	PARTS	02/09/2022	(\$27.00)	P
16220285	ADVANCE AUTO PARTS (Wis Rapids)	PARTS	02/09/2022	\$307.27	P
16220286	ADVANCE AUTO PARTS (Wis Rapids)	PARTS	02/09/2022	\$51.34	P
16220287	ADVANCE AUTO PARTS (Wis Rapids)	PARTS	02/09/2022	\$34.98	P
16220288	ADVANCE AUTO PARTS (Wis Rapids)	PARTS	02/10/2022	(\$307.27)	P
16220289	ADVANCE AUTO PARTS (Wis Rapids)	PARTS	02/10/2022	\$31.32	P
16220290	ADVANCE AUTO PARTS (Wis Rapids)	PARTS	02/10/2022	\$31.01	P
16220291	ADVANCE AUTO PARTS (Wis Rapids)	PARTS	02/10/2022	\$27.57	P
16220292	ADVANCE AUTO PARTS (Wis Rapids)	PARTS	02/11/2022	\$37.66	P
16220293	ADVANCE AUTO PARTS (Wis Rapids)	PARTS	02/11/2022	\$77.16	P
16220294	ADVANCE AUTO PARTS (Wis Rapids)	PARTS	02/11/2022	\$17.58	P
16220295	ADVANCE AUTO PARTS (Wis Rapids)	PARTS	02/11/2022	\$20.78	P
16220296	ADVANCE AUTO PARTS (Wis Rapids)	PARTS	02/11/2022	\$93.76	P
16220297	ADVANCE AUTO PARTS (Wis Rapids)	PARTS	02/11/2022	\$76.45	P
16220298	ADVANCE AUTO PARTS (Wis Rapids)	PARTS	02/14/2022	(\$8.44)	P
16220299	ADVANCE AUTO PARTS (Wis Rapids)	PARTS	02/14/2022	(\$17.58)	P
16220300	ADVANCE AUTO PARTS (Wis Rapids)	PARTS	02/14/2022	\$92.47	P
16220301	ADVANCE AUTO PARTS (Wis Rapids)	PARTS	02/15/2022	\$8.04	P
16220302	ADVANCE AUTO PARTS (Wis Rapids)	PARTS	02/16/2022	(\$44.36)	P
16220303	ADVANCE AUTO PARTS (Wis Rapids)	PARTS	02/16/2022	\$13.28	P
16220304	ADVANCE AUTO PARTS (Wis Rapids)	PARTS	02/16/2022	\$168.82	P
16220305	ADVANCE AUTO PARTS (Wis Rapids)	PARTS	02/17/2022	\$24.44	P
16220306	ADVANCE AUTO PARTS (Wis Rapids)	PARTS	02/17/2022	\$9.72	P
16220307	ADVANCE AUTO PARTS (Wis Rapids)	PARTS	02/21/2022	\$7.38	P
16220308	ADVANCE AUTO PARTS (Wis Rapids)	PARTS	02/21/2022	\$6.48	P
16220309	ADVANCE AUTO PARTS (Wis Rapids)	PARTS	02/23/2022	\$6.48	P
16220310	ADVANCE AUTO PARTS (Wis Rapids)	PARTS	02/23/2022	\$48.35	P
16220311	ADVANCE AUTO PARTS (Wis Rapids)	PARTS	02/24/2022	\$243.47	P
16220312	ADVANCE AUTO PARTS (Wis Rapids)	PARTS	02/24/2022	\$5.24	P
16220313	ADVANCE AUTO PARTS (Wis Rapids)	PARTS	02/24/2022	\$23.42	P
16220314	ADVANCE AUTO PARTS (Wis Rapids)	PARTS	02/24/2022	\$29.39	P
16220315	ADVANCE AUTO PARTS (Wis Rapids)	PARTS	02/28/2022	\$210.34	P
16220316	ADVANCE AUTO PARTS (Wis Rapids)	PARTS	02/28/2022	\$20.72	P
16220317	ADVANCE AUTO PARTS (Wis Rapids)	PARTS	02/28/2022	\$64.36	P
16220318	APPLIED INDUSTRIAL TECHNOLOGY	PARTS	02/10/2022	\$74.83	P
16220319	APPLIED MAINTENANCE SUPPLIES & SOLUTIONS	PARTS	02/18/2022	\$118.76	P
16220320	APPLIED MAINTENANCE SUPPLIES & SOLUTIONS	PARTS	02/22/2022	\$10.09	P

HIGHWAY - FEBRUARY

16220243 - 16220467

Voucher	Vendor Name	Nature of Claim	Doc Date	Amount	Paid
16220321	APPLIED MAINTENANCE SUPPLIES & SOLUTIONS	PARTS	02/25/2022	\$22.78	P
16220322	AMERICAN TRAFFIC SAFETY MATER	PARTS	02/18/2022	\$568.35	P
16220323	BADGER SCALE	ANNUAL SCALE INSPECTIONS	02/28/2022	\$400.00	P
16220324	NORTH CENTRAL UTILITY OF WI	PARTS	02/08/2022	\$1,187.16	P
16220325	NORTH CENTRAL UTILITY OF WI	PARTS	02/10/2022	\$79.24	P
16220326	NORTH CENTRAL UTILITY OF WI	PARTS	02/15/2022	\$26.52	P
16220327	NORTH CENTRAL UTILITY OF WI	PARTS	02/17/2022	\$30.82	P
16220328	NORTH CENTRAL UTILITY OF WI	PARTS	02/17/2022	\$196.74	P
16220329	NORTH CENTRAL UTILITY OF WI	PARTS	02/21/2022	\$440.00	P
16220330	NORTH CENTRAL UTILITY OF WI	PARTS	02/21/2022	\$156.14	P
16220331	NORTH CENTRAL UTILITY OF WI	PARTS	02/24/2022	\$69.88	P
16220332	NORTH CENTRAL UTILITY OF WI	PARTS	02/24/2022	\$30.40	P
16220333	BAUER BUILT INC	TIRES	02/08/2022	\$410.00	P
16220334	BAUER BUILT INC	TIRES	02/14/2022	\$80.82	P
16220335	BAUER BUILT INC	TIRES	02/21/2022	\$713.04	P
16220336	BROOKS TRACTOR COMPANY	PARTS	02/25/2022	\$371.65	P
16220337	BURNS INDUSTRIAL SUPPLY CO INC	PARTS	02/14/2022	\$28.60	P
16220338	CMK STARTER AND ALTERNATOR REBUILD LLC	PARTS	02/01/2022	\$115.00	P
16220339	CMK STARTER AND ALTERNATOR REBUILD LLC	PARTS	02/01/2022	\$220.00	P
16220340	CENTRAL WIS TOOL SOLUTIONS INC	PARTS	02/17/2022	\$208.36	P
16220341	D.W. DAVIES & CO INC	PARTS	02/17/2022	\$63.28	P
16220342	FARRELL EQUIPMENT & SUPPLY CO	PARTS	02/07/2022	\$899.90	P
16220343	FASTENAL COMPANY	PARTS	02/02/2022	\$7.23	P
16220344	FASTENAL COMPANY	PARTS	02/09/2022	\$326.59	P
16220345	FASTENAL COMPANY	PARTS	02/16/2022	\$23.67	P
16220346	FASTENAL COMPANY	PARTS	02/23/2022	\$17.79	P
16220347	FASTENAL COMPANY	PARTS	02/23/2022	\$334.52	P
16220348	FERGUSON ENTERPRISES LLC	PARTS	02/01/2022	\$796.52	P
16220349	FLEETPRIDE	PARTS	02/11/2022	\$2,734.86	P
16220350	FLEETPRIDE	PARTS	02/23/2022	(\$1,920.00)	P
16220351	FRONTIER	TELEPHONE - MFLD	02/28/2022	\$59.96	P
16220352	HALRON LUBRICANTS INC	PARTS	02/04/2022	\$124.24	P
16220353	HALRON LUBRICANTS INC	PARTS	02/04/2022	\$286.22	P
16220354	HALRON LUBRICANTS INC	PARTS	02/07/2022	\$695.13	P
16220355	HALRON LUBRICANTS INC	PARTS	02/08/2022	\$486.90	P
16220356	HALRON LUBRICANTS INC	PARTS	02/07/2022	(\$40.00)	P
16220357	HALRON LUBRICANTS INC	PARTS	02/07/2022	(\$20.00)	P
16220358	HALRON LUBRICANTS INC	PARTS	02/10/2022	\$1,253.00	P
16220359	HALRON LUBRICANTS INC	PARTS	02/09/2022	\$80.94	P
16220360	HALRON LUBRICANTS INC	PARTS	02/28/2022	\$758.79	P
16220361	HIGHWAY CONSTRUCTION PRODUCTS LLC	PARTS	02/07/2022	\$959.40	P
16220362	HIGHWAY CONSTRUCTION PRODUCTS LLC	PARTS	02/07/2022	\$751.84	P
16220363	HIGHWAY CONSTRUCTION PRODUCTS LLC	PARTS	02/07/2022	\$57.24	P
16220364	INSIGHT FS	LP GAS	02/10/2022	\$318.48	P

HIGHWAY - FEBRUARY

16220243 - 16220467

Voucher	Vendor Name	Nature of Claim	Doc Date	Amount	Paid
16220365	INSIGHT FS	LP GAS	02/24/2022	\$54.03	P
16220366	JFTCO INC	PARTS	02/15/2022	\$44.55	P
16220367	JX ENTERPRISES INC	PARTS	02/01/2022	\$60.44	P
16220368	JX ENTERPRISES INC	PARTS	02/03/2022	\$217.90	P
16220369	JX ENTERPRISES INC	PARTS	02/21/2022	\$187.98	P
16220370	JX ENTERPRISES INC	PARTS	02/25/2022	\$21.14	P
16220371	LUBRICATION ENGINEERS INC	PARTS	02/15/2022	\$124.02	P
16220372	LUBRICATION TECHNOLOGIES INC	PARTS	02/10/2022	\$825.34	P
16220373	MARSHFIELD UTILITIES	UTILITIES - MFLD	02/28/2022	\$175.14	P
16220374	MARSHFIELD UTILITIES	UTILITEIS - MFLD	02/28/2022	\$375.18	P
16220375	MARSHFIELD UTILITIES	UTILITIES - MFLD	02/28/2022	\$67.00	P
16220376	MENARDS - PLOVER	PARKS - HEMLOCK TRAIL BRIDGE	01/04/2022	\$1,504.86	P
16220377	MENARDS - PLOVER	PARKS - HEMLOCK TRAIL BRIDGE	02/02/2022	(\$578.14)	P
16220378	MID-STATE TRUCK SERVICE INC	PARTS	02/14/2022	\$1,222.70	P
16220379	MID-STATE TRUCK SERVICE INC	PARTS	02/14/2022	(\$1,222.07)	P
16220380	MID-STATE TRUCK SERVICE INC	PARTS	02/01/2022	\$86.07	P
16220381	MID-STATE TRUCK SERVICE INC	PARTS	02/14/2022	\$1,197.72	P
16220382	MID-STATE TRUCK SERVICE INC	PARTS	02/22/2022	\$189.41	P
16220383	MID-STATE TRUCK SERVICE INC	PARTS	02/24/2022	\$18.68	P
16220384	MID-STATE TRUCK SERVICE INC	PARTS	02/25/2022	\$16.88	P
16220385	MILES TRUCK INC	3137 04' FREIGHTLINER TRUCK	03/01/2022	\$38,169.50	P
16220386	MISSISSIPPI WELDERS SUPPLY CO INC	WELDING SUPPLIES	02/02/2022	\$213.44	P
16220387	MISSISSIPPI WELDERS SUPPLY CO INC	WELDING SUPPLIES	02/18/2022	\$114.40	P
16220388	MISSISSIPPI WELDERS SUPPLY CO INC	PARTS	02/23/2022	\$372.30	P
16220389	MISSISSIPPI WELDERS SUPPLY CO INC	WELDING SUPPLIES	02/28/2022	\$211.68	P
16220390	MONROE TRUCK EQUIPMENT	PARTS	02/02/2022	\$483.11	P
16220391	MONROE TRUCK EQUIPMENT	PARTS	02/23/2022	\$666.12	P
16220392	NAPA CENTRAL WI AUTO PARTS	PARTS	02/04/2022	\$91.64	P
16220393	NAPA CENTRAL WI AUTO PARTS	PARTS	02/21/2022	\$37.68	P
16220394	NAPA CENTRAL WI AUTO PARTS	PARTS	02/08/2022	(\$45.82)	P
16220395	NAPA CENTRAL WI AUTO PARTS	PARTS	02/07/2022	(\$45.82)	P
16220396	NAPA CENTRAL WI AUTO PARTS	PARTS	02/24/2022	\$427.95	P
16220397	NIEMAN'S SERVICE INC	TOWING	02/10/2022	\$50.00	P
16220398	NIEMAN'S SERVICE INC	TOWING	02/16/2022	\$150.00	P
16220399	PETROTECH LLC	FUEL PUMP REPAIR	02/12/2022	\$192.63	P
16220400	PINE RIVER GROUP	SIGN SUPPLIES	02/17/2022	\$11,556.00	P
16220401	POMP'S TIRE SERVICE INC - Milw	TIRES	02/10/2022	\$251.44	P
16220402	PRECISE MRM LLC	FLAT PLAN USA&GPRS NAF & SOFT	02/28/2022	\$702.00	P
16220403	PROVISION PARTNERS	DIESEL FUEL AND GASOLINE	02/28/2022	\$42,511.55	P
16220404	RAPIDS FORD LINCOLN MERCURY	PARTS	02/07/2022	\$39.96	P
16220405	RAPIDS RENTAL & SUPPLY	PARTS	02/10/2022	\$28.99	P
16220406	RENT-A-FLASH INC	ATV SIGNAGE	02/23/2022	\$10,681.25	P
16220407	RTVISION	ONEGOV ANNUAL SUPPORT	03/01/2022	\$1,500.00	P
16220408	KRIETE TRUCK CENTER	PARTS	02/23/2022	\$78.07	P

HIGHWAY - FEBRUARY

16220243 - 16220467

Voucher	Vendor Name	Nature of Claim	Doc Date	Amount	Paid
16220409	SCHILLING SUPPLY COMPANY	PARTS	02/15/2022	\$482.12	P
16220410	SCHILLING SUPPLY COMPANY	PARTS	02/15/2022	\$26.28	P
16220411	SCHILLING SUPPLY COMPANY	PARTS	02/15/2022	\$29.21	P
16220412	SHERWIN INDUSTRIES INC	PARTS	02/08/2022	\$938.72	P
16220413	SHERWIN INDUSTRIES INC	PARTS	02/15/2022	\$229.36	P
16220414	SHERWIN INDUSTRIES INC	PARTS	02/17/2022	\$49.03	P
16220415	SKARLUPKA SERVICE INC	PARTS	02/01/2022	\$263.42	P
16220416	SNODEPOT	PARTS	02/01/2022	\$1,004.00	P
16220417	SNODEPOT	PARTS	02/15/2022	\$1,004.00	P
16220418	STAINLESS & REPAIR INC	PARTS	02/14/2022	\$133.70	P
16220419	STAINLESS & REPAIR INC	PARTS	02/18/2022	\$38.16	P
16220420	STAINLESS & REPAIR INC	PARTS	02/28/2022	\$104.58	P
16220421	STERLING WATER INC	WATER FOR HOT MIX	02/28/2022	\$10.55	P
16220422	TAPCO INC	SIGNS	02/15/2022	\$2,090.00	P
16220423	TRUCK COUNTRY OF WISCONSIN	PARTS	02/03/2022	\$37.32	P
16220424	TRUCK COUNTRY OF WISCONSIN	PARTS	02/11/2022	(\$23.75)	P
16220425	TRUCK COUNTRY OF WISCONSIN	PARTS	02/18/2022	\$146.87	P
16220426	TRUCK COUNTRY OF WISCONSIN	PARTS	02/23/2022	\$215.76	P
16220427	TRUCK EQUIPMENT INC	PARTS	02/07/2022	\$1,284.13	P
16220428	VAN KEPPEL COMPANY	PARTS	02/27/2022	\$1,361.70	P
16220429	WHEELERS OF WISCONSIN RAPIDS	PARTS	02/07/2022	\$59.89	P
16220430	WHEELERS OF WISCONSIN RAPIDS	AUTO REPAIR	02/28/2022	\$252.85	P
16220431	WISCONSIN METALS	BLACKSMITH STEEL	02/09/2022	\$275.00	P
16220432	WISCONSIN METALS	BLACKSMITH STEEL	02/07/2022	\$1,624.00	P
16220433	WISCONSIN METALS	BLACKSMITH STEEL	02/11/2022	\$275.00	P
16220434	WISCONSIN METALS	BLACKSMITH STEEL	02/28/2022	\$1,500.00	P
16220435	WISCONSIN VALLEY BUILDING PRODUCTS	SHOP SUPPLIES	02/08/2022	\$299.30	P
16220436	WISCONSIN VALLEY BUILDING PRODUCTS	SHOP SUPPLIES	02/21/2022	\$34.73	P
16220437	WE ENERGIES	NATURAL GAS - HOT MIX	03/03/2022	\$476.00	P
16220438	WOOD COUNTY REGISTER OF DEEDS	COPY FEE	03/02/2022	\$2.00	P
16220439	ALTMANN JOHN	RETURN OF PERMIT DEPOSIT	03/02/2022	\$300.00	
16220440	BADGER LABORATORIES & ENGIN	AIR EMISSION REPORT	03/07/2022	\$2,500.00	
16220441	CASPER BENNETT	LUMBER	03/10/2022	\$518.40	
16220442	CINTAS CORPORATION	CLEANING RUGS & UNIFORMS	02/07/2022	\$363.68	
16220443	CINTAS CORPORATION	CLEANING RUGS & UNIFORMS	02/14/2022	\$363.68	
16220444	CINTAS CORPORATION	CLEANING RUGS & UNIFORMS	02/14/2022	\$365.41	
16220445	CINTAS CORPORATION	CLEANING RUGS & UNIFORMS	02/28/2022	\$365.41	
16220446	CINTAS CORPORATION	CLEANING RUGS & UNIFORMS	02/02/2022	\$813.18	
16220447	CINTAS CORPORATION	CLEANING RUGS & UNIFORMS	02/09/2022	\$811.41	
16220448	CINTAS CORPORATION	CLEANING RUGS & UNIFORMS	02/10/2022	\$126.69	
16220449	CINTAS CORPORATION	CLEANING RUGS & UNIFORMS	02/16/2022	\$813.18	
16220450	CINTAS CORPORATION	CLEANING RUGS & UNIFORMS	02/23/2022	\$811.41	
16220451	CINTAS CORPORATION	CLEANING RUGS & UNIFORMS	02/24/2022	\$126.69	
16220452	HOME DEPOT CREDIT SERV (Highway)	PARTS	03/04/2022	\$71.82	

HIGHWAY - FEBRUARY

16220243 - 16220467

Voucher	Vendor Name	Nature of Claim	Doc Date	Amount	Paid
16220453	INSIGHT FS	LP GAS	03/10/2022	\$26.54	
16220454	INSIGHT FS	LP GAS	03/14/2022	\$46.44	
16220455	MENARDS-MARSHFIELD	PARTS	01/13/2022	\$428.70	
16220456	MENARDS-MARSHFIELD		02/03/2022	(\$171.48)	
16220457	MENARDS-MARSHFIELD	PARTS	02/03/2022	\$64.55	
16220458	MENARDS-MARSHFIELD	PARTS	02/03/2022	\$33.67	
16220459	RON'S REFRIGERATION & AC INC	HVAC REPAIR/SERVICE	03/05/2022	\$295.00	
16220460	STAINLESS & REPAIR INC	4793 4888 3865 4689	03/15/2022	\$156,291.00	
16220461	STAPLES ADVANTAGE	OFFICE SUPPLIES	09/14/2021	\$32.89	
16220462	STAPLES ADVANTAGE	OFFICE SUPPLIES	03/07/2022	\$64.80	
16220463	STAPLES ADVANTAGE	OFFICE SUPPLIES	03/10/2022	\$9.28	
16220464	WASTE MANAGEMENT	GARBAGE DISPOSAL	03/01/2022	\$146.22	
16220465	WE ENERGIES	NATURAL GAS - BRINE PLANT	03/28/2022	\$170.38	
16220466	WE ENERGIES	NATURAL GAS - WR SHOP	03/04/2022	\$4,114.88	
16220467	WE ENERGIES	NATURAL GAS - WR SHOP	03/04/2022	\$172.39	
Grand Total:				\$396,400.20	

Signatures

Committee Chair:

Committee Member:

Committee Member:

Committee Member:

Committee Member:

Committee Member:

Committee Member:

Committee Member:

Committee Member:

Policy #5

Mailbox Policy

Rural mailboxes have been and are allowed on the highway right-of-way as a matter of convenience to the land owners or occupants and not as a matter of right. Encroachments upon the highway right-of-way are governed by Section 86.04 of the Wisconsin Statutes which states, in part, as follows:

“If any highway right-of-way shall be encroached upon, under or over by any fence, stand, building or any other structure or object, ...the County Highway Committee (in the case of a County Trunk Highway), ...may order the occupant or owner of the land through or by which such highway runs, and to which the encroachment shall be appurtenant, to remove the same beyond the limits of such highway within 30 days”

Thus, it is the intention of this policy that, if a mailbox is accidentally damaged in the process of removing snow, mowing the right-of-way, graveling the shoulder, or any other act of maintaining the right-of-way, it is the land owner's or occupant's obligation to repair or replace the mailbox.

It is further the intention that the above policy shall also be applicable to tubes or boxes for newspaper delivery and it is also required that such tubes or boxes be located adjacent to the mailbox, if any.

Should, for some reason, there be no mailbox for a particular residence, then the tube or box shall be located on the same side of the roadway as are the mailboxes which serve other residences along the route.

Mailbox installations that present hazards to trucks, cars, motorcycles, and bicycles include those mounted on massive supports such as plowshares, concrete pillars, horizontal planks, and concrete-filled milk cans. The owner may be liable to others for personal injury or property damage resulting from such hazards and should be so informed during contact by the engineer.

(Adopted February 9, 1990)

Due to the large amount of telephone calls in regard to mailbox damage and to eliminate the question as to whether the plow or snow damaged the mailbox, we are, therefore, placing in effect today the following policy:

Plow and wing operators shall plow no closer than two feet to mailboxes, unless directed by a supervisor to plow closer. This does not mean that you should stay four or five feet away, either. Just do the best you can to plow two feet away from the mailboxes.

(Adopted January 12, 1994)

If a mailbox owner believes their mailbox was damaged by County equipment, the owner must fill out a Claim and Injury form and submit it to the County Clerk. A Patrol Superintendent will investigate the claim and if damaged is deemed to have been caused by County equipment, the owner of the mailbox would be reimbursed up to \$100 for the damages.

(Revised March 29,2022)

NOTICE OF QUOTES

The Wood County Highway Infrastructure and Recreation Committee will accept sealed quotes only (no faxed quotes accepted) up until 11:00 A.M. (CST) - (WARNING- Mail delivery is after 11:00 A.M.) on Tuesday, April 5, 2022 at the Highway Commissioner's Office, 555 - 17th Avenue North, Wisconsin Rapids, WI 54495-1966 for the following:

2022 Department's Requirements of Aluminum Box Culverts

Specifications, Quoting Procedure and Forms may be had by applying at the above office.

The Committee reserves the right to reject any or all quotes or to accept any quote they deem most advantageous to Wood County.

By Order of the Wood County Highway Infrastructure and Recreation Committee:

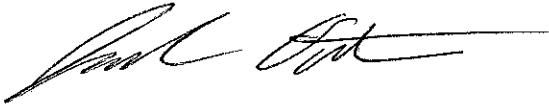
A handwritten signature in black ink, appearing to read 'Joel Ortman', with a long horizontal flourish extending to the right.

Joel Ortman, P.E., Highway Engineer

for

Roland Hawk, P.E., Commissioner
Wood County Highway Department

GENERAL QUOTING PROCEDURE

QUOTE OPENING: Tuesday, April 5, 2022, 11:00 AM at the office of the Wood County Highway Commissioner, 555 – 17th Avenue North, Wisconsin Rapids WI 54495

To comply with the NOTICE OF QUOTES, the following General Quoting Procedure and Specifications are to govern:

All quotes must be in the Office of the County Highway Commissioner, 555- 17th Avenue North, Wisconsin Rapids, WI by 11:00 A.M. (CST), Tuesday, April 5, 2022. Quotes must be sealed and properly identified giving the name and address of the quoter. Each quote must be in a separate container or envelope and marked **QUOTE ON ALUMINUM BOX CULVERTS**. All quotes will be publicly opened and read at the specified time by the County Highway Infrastructure and Recreation Committee or its authorized representatives and only TOTAL quotes will be read.

All quotes must be entered and submitted on the specified form of Proposal prepared by the Highway Commission and only quotes submitted on these forms will be considered for award purposes by the Commissioner. The General Quoting Procedure, Specifications and Proposal shall constitute the quote of each quoter and must be attached in the above order. Quoters shall attach such additional information to their proposal, as they deem advisable and necessary for the benefit of the Committee in assembling comparative specifications.

The Committee reserves the right to consider all proposals for a period not to exceed thirty (30) days from the date of opening. The Committee will either award the contract or reject all quotes within that time. Each quoter will be allowed to have a representative appear before the Committee to explain his quote and specifications of the product as quoted. A time limit for each quoter will be established by the Committee at the day of letting. All quotes are to be NET, FOB WISCONSIN RAPIDS, WISCONSIN.

The Wood County Highway Infrastructure and Recreation Committee reserves the right to reject any or all quotes or parts, thereof, and to WAIVE any technicality in any quote submitted and to make such award as they deem most advantageous to Wood County.

By Order of the Wood County Highway Infrastructure and Recreation Committee:



Joel Ortman, P.E., Highway Engineer

for

Roland Hawk, P.E., Commissioner
Wood County Highway Department

Request for Quotation:

Wood County Culvert Pipes

Wood County Highway Department is requesting quotes on the following items:

- Item A: 1 – 10'0" x 4'10" x 36' Aluminum Bottomless Box Culvert
HS25 Minimum Loading, 30" footing pads
Minimum 2' cover plus asphaltic surface
Maximum assumed 2,500 psf soil bearing capacity
- Item B: 1 – 10'11" x 6'4" x 36' Aluminum Bottomless Box Culvert
HS25 Minimum Loading, 30" footing pads
Minimum 2' of cover plus asphaltic surface
Maximum assumed 2,500 psf soil bearing capacity
- Item C: 1 – 15'9" x 8'0" x 36' Aluminum Bottomless Box Culvert
HS25 Minimum Loading, 30" footing pads
Minimum 2' of cover plus asphaltic surface
Maximum assumed 2,500 psf soil bearing capacity
Full headwall plus wing-walls on one side, minimum 1 corner panel and 1 wing panel
- Item D: 1 – 24'8" x 10'6" x 58.5' Aluminum Bottomless Box Culvert
HS93 Minimum Loading, 34" footing pads
Minimum 2' of cover plus asphaltic surface
Maximum assumed 2,500 psf soil bearing capacity

An Engineers Certification and Manufacturers installation instructions shall be submitted with final plans.

Please submit prices using your own format and include this page as a cover page.

Item A: 10'0" x 4'10" x 36' ABLC \$ _____

Item B: 10'11" x 6'4" x 36' ALBC \$ _____

Item C: 15'9" x 8'0" x 36' ALBC \$ _____

Item D: 24'8" x 10'6" x 58.5' ALBC \$ _____

Quoted By: _____

Title: _____

Company Name: _____

Address: _____

City, State, ZIP: _____

Phone: _____

FAX: _____

E-mail: _____

NOTICE OF QUOTES

The Wood County Highway Infrastructure and Recreation Committee will accept sealed quotes only (no faxed quotes accepted) up until 9:00 A.M. (CST) - (WARNING- Mail delivery is after 10:00 A.M.) on Tuesday, April 5, 2022 at the Highway Commissioner's Office, 555 - 17th Avenue North, Wisconsin Rapids, WI 54495-1966 for the following:

Dual Drum Compactor

Specifications, Quoting Procedure and Forms may be had by applying at the above office.

The Committee reserves the right to reject any or all quotes or to accept any quote they deem most advantageous to Wood County.

By Order of the Wood County Highway Infrastructure and Recreation Committee:

A handwritten signature in black ink, appearing to read 'Roland Hawk', is written over a horizontal line.

Roland Hawk, Commissioner

GENERAL QUOTING PROCEDURE

QUOTE OPENING: Tuesday, April 5, 2022, 9:00 AM at the office of the Wood County Highway Commissioner, 555 – 17th Avenue North, Wisconsin Rapids WI 54495

To comply with the NOTICE OF QUOTES, the following General Quoting Procedure and Specifications are to govern:

All quotes must be in the Office of the County Highway Commissioner, 555- 17th Avenue North, Wisconsin Rapids, WI by 9:00 A.M. (CST), Tuesday, April 5, 2022. Quotes must be sealed and properly identified giving the name and address of the quoter. Each quote must be in a separate container or envelope and marked **QUOTE ON DUAL DRUM COMPACTOR**. All quotes will be publicly opened and read at the specified time by the County Highway Infrastructure and Recreation Committee or its authorized representatives and only TOTAL quotes will be read.

All quotes must be entered and submitted on the specified form of Proposal prepared by the Highway Commission and only quotes submitted on these forms will be considered for award purposes by the Commissioner. The General Quoting Procedure, Specifications and Proposal shall constitute the quote of each quoter and must be attached in the above order. Quoters shall attach such additional information to their proposal, as they deem advisable and necessary for the benefit of the Committee in assembling comparative specifications.

The Committee reserves the right to consider all proposals for a period not to exceed thirty (30) days from the date of opening. The Committee will either award the contract or reject all quotes within that time. Each quoter will be allowed to have a representative appear before the Committee to explain his quote and specifications of the product as quoted. A time limit for each quoter will be established by the Committee at the day of letting. All quotes are to be NET, FOB WISCONSIN RAPIDS, WISCONSIN.

The Wood County Highway Infrastructure and Recreation Committee reserves the right to reject any or all quotes or parts, thereof, and to WAIVE any technicality in any quote submitted and to make such award as they deem most advantageous to Wood County.

By Order of the Wood County Highway Infrastructure and Recreation Committee:



Roland Hawk, Commissioner

**Request for Quotation:
Dual Drum Compactor**

Wood County Dual Drum Compactor Minimum Specification
Compactor must be a 2019 or newer model year with 500 hrs or less.

<u>Description</u>	<u>Meets Specifications</u>		
	<u>Yes</u>	<u>No</u>	<u>Deviations</u>
<u>Engine:</u>			
Engine shall meet US EPA Tier 4 final emissions	_____	_____	_____
Heavy duty liquid cooled diesel	_____	_____	_____
Minimum 25HP	_____	_____	_____
45 – Amp (min) alternator	_____	_____	_____
Master electrical disconnect	_____	_____	_____
Min. 10.5 gallon fuel tank	_____	_____	_____
<u>Drum:</u>			
47” wide	_____	_____	_____
28” diameter	_____	_____	_____
Shall have a nominal thickness of not less than .50”	_____	_____	_____
The drum edges at ground contact point must be visible to the operator on either side of the unit.	_____	_____	_____
A flexible, adjustable, non-metallic drum surface wiping device to be mounted on the frame structure that surrounds each drum.	_____	_____	_____
<u>Sprayer system:</u>			
Shall be equipped with a water tank of not less than 65 gallon capacity.	_____	_____	_____
Water tank shall be equipped with a drain plug.	_____	_____	_____
Shall have an electric, externally mounted water pump to provide pressurized water to the sprinkler bars mounted at each drum.	_____	_____	_____
Water spray system must have three modes: on, off and automatic.	_____	_____	_____
Water filtration is to be provided by an in-line filter and individual mesh screens in the spray nozzles.	_____	_____	_____
Each spray bar to have four (4) hand-serviceable spray nozzles.	_____	_____	_____
<u>Propulsion system:</u>			
Shall be fully hydrostatic, closed-circuit type with single lever control of both speed and direction.	_____	_____	_____
Shall be independent of the vibration system.	_____	_____	_____
Shall have provision for bypassing the hydraulic propulsion system and releasing the spring applied brake to allow towing of the unit in the event of a mechanical or hydraulic failure.	_____	_____	_____
The drums shall be directly driven by a low speed, high torque hydrostatic motor, chain, belt or other types are not permitted.	_____	_____	_____
Shall have infinitely variable travel speed with a minimum top Speed of 6-mph in both forward and reverse.	_____	_____	_____

Vibratory system:

Shall consist of a fixed-displacement hydraulic pump driving
a fixed displacement hydraulic motor directly coupled to an internal, shaft-type
eccentric mechanism.

Shall have dual frequencies of not less than 3300 vpm and 4000 vpm

Minimum centrifugal force shall be 5,500lb. low and 8,000lb high.

Vibration shall cease below 0.5mph in automatic mode.

Manual and automatic means for cutout of the vibrators shall be provided.

Brakes:

Shall be equipped with a Spring-applied hydraulically
released parking brake system on each drum conforming
to SAE J1472 standards.

Weights:

Operating weight: 5500lbs min.

Cab:

Strobe light mounted on cab, visible from 360 degrees

Open ROPS structure shall include FOPS

Shall be equipped with a four way sliding seat.

Manuals:

One complete set of manuals supplied with unit. Operator, parts and
Service manual shall include schematics for: engine, drivetrain, chassis,
And electrical. Manuals on disc is option.

Warranty:

All warranty work will be picked up and returned to Wood County

Highway Department at selling dealers expense

1 year 1000 hours warranty

Delivery:

Date of delivery will be considered prior to award, failure to deliver

By agreed upon date will result in a \$100.00 per day penalty

Wood County Dual Drum Compactor

Package Price as per specifications \$ _____

Estimated Delivery Date _____

Quoted By: _____

Company Name: _____

Address: _____

City, State, ZIP: _____

Phone: _____

FAX: _____

E-mail: _____

NOTICE OF QUOTES

The Wood County Highway Infrastructure and Recreation Committee will accept sealed quotes only (no faxed quotes accepted) up until 10:00 AM (CST) on Tuesday, April 5, 2022 at the Highway Commissioner's Office, 555 - 17th Avenue North, Wisconsin Rapids, WI 54495-1966 for the furnishing and delivering of the following:

Department's Requirements of Milling and Pulverizing Wood County Highways for 2022, approximate quantities are 9,500 SY of milling 2 inches, 25,800 SY of pulverizing 3 inches, 89,900 SY of pulverizing 6 inches.

Specifications, Quoting Procedure and Forms may be obtained by applying at the above office.

The Committee reserves the right to reject any or all quotes or to accept any quote they deem most advantageous to Wood County.

By Order of the Wood County Highway Infrastructure and Recreation Committee:

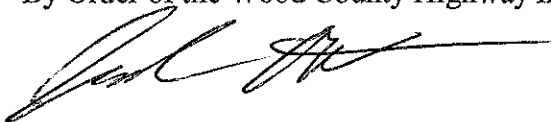
A handwritten signature in black ink, appearing to read 'Joel Ortman', with a long horizontal flourish extending to the right.

Joel Ortman P.E., Highway Engineer
for
Roland Hawk, Commissioner
Wood County Highway Department

GENERAL QUOTING PROCEDURE

QUOTE OPENING: April 5, 2022 at the Wood County Highway Department,
10:00 AM (CST)

To comply with the NOTICE OF QUOTES, the following General Quoting Procedure and Specifications are to govern:

All quotes must be in the Office of the County Highway Commissioner, 555 - 17th Avenue North, Wisconsin Rapids, WI by 10:00 AM (CST), Tuesday, April 5, 2022. Quotes must be sealed and properly identified giving the name and address of the quoter. Each quote must be in a separate container or envelope and marked **QUOTE ON MILLING AND PULVERIZING**. All quotes will be publicly opened and read at the Wood County Highway Department at 10:00 AM (CST), Tuesday, April 5, 2022 by the County Highway Infrastructure and Recreation Committee or its authorized representatives and only TOTAL quotes will be read.

All quotes must be entered and submitted on the specified form of Proposal prepared by the Highway Commission and only quotes submitted on these forms will be considered for award purposes by the Commissioner. The General Quoting Procedure, Specifications and Proposal shall constitute the quote of each quoter and must be attached in the above order. Quoters shall attach such additional information to their proposal as they deem advisable and necessary for the benefit of the Committee in assembling comparative specifications.

No Certified Cashier's checks or Bidder's Bonds will be required with quote, but quoter must submit satisfactory evidence of ability to make delivery of the work as specified and as agreed to by both parties. The successful quoter will not be required to deposit a "CERTIFIED" check to guarantee delivery of same on or before specified date.

The Committee reserves the right to consider all proposals for a period not to exceed sixty (60) days from the date of opening. Each contractor will be allowed to have a representative appear before the Committee to explain his quote and specifications of the product as quoted. A time limit for each quoter will be established by the Committee at the day of letting. This request for quotes does not guarantee work to the contractor with the lowest quote. Wood County intends to honor the low quote and if the contractor with the lowest quote is not able to perform the work in time frame Wood County schedules the work, then Wood County has the choice to select the second lowest quote contractor, and so forth.

The Wood County Highway Infrastructure and Recreation Committee reserves the right to reject any or all quotes or parts, thereof and to WAIVE any technicality in any quote submitted and to make such award as they deem most advantageous to Wood County.

By Order of the Wood County Highway Infrastructure and Recreation COMMITTEE:



Joel Ortman P.E., Highway Engineer

for

Roland Hawk, Commissioner

Wood County Highway Department

DEPARTMENT'S REQUIREMENTS OF MILLING AND PULVERIZING FOR 2021

REQUEST FOR SEALED QUOTES

Work includes the following:

Milling 2" Approximately 13,000 S.Y. Asphalt Pavement

Pulverizing 3" Depth Approximately 25,800 S.Y. Asphalt Pavement

Pulverizing 6" Depth Approximately 65,900 S.Y. Asphalt Pavement

The following special provisions apply for **Milling**:

1. General. All materials and workmanship must be in accordance with the most recent edition of the Wisconsin Department of Transportation, Division of Highways Standards and Specifications. The existing asphalt surface shall be milled as directed by the engineer.
2. Measurement. The removal of asphalt pavement by milling will be measured by the square yard of existing asphalt surface.
3. Payment. The removal of asphalt pavement by milling will be paid at the contract unit price per square yard which shall be full compensation for milling and all labor, tools, equipment, and incidentals necessary to complete the work in accordance with the contract.
4. Wood County shall provide trucking for asphalt milling and traffic control.
5. Wood County will retain ownership of all asphalt milling material.
6. The contractor shall furnish to Wood County Highway Department a Certificate of Insurance for Worker's Compensation and an Umbrella Certificate of Liability and Property Insurance in the minimum amount of one million dollars, (\$1,000,000.00) before beginning work and shall notify Wood County Highway Department of any changes or cancellations in insurance coverage.
7. Wood County Highway hours of operation from April 25, 2022 to September 1, 2022 is 6:00 AM – 4:00 PM Monday – Thursday. Only with permission from the Highway Commissioner or County Engineer will work be performed on days outside these hours of operation. The Highway Department can extend the hours Monday – Thursday in most cases to meet the contractor's needs. Work on Friday, Saturday, Sunday and Holidays will be approved on a case by case basis. Contractors should not count on working Fridays.
8. Tentative date of contract award is April 8, 2022.
9. Tentative start date April 25, 2022 or possibly sooner depending on weather.

The following special provisions apply for **Pulverizing**:

1. General. All materials and workmanship must be in accordance with the latest edition of the Wisconsin Department of Transportation, Division of Highways Standards and Specifications. The existing asphalt surface shall be pulverized full depth and to a minimum of 97 percent passing a 2-inch screen. The depth of the pulverizing shall be adequate to ensure a sufficient depth of the existing crushed aggregate base course shall also be pulverized and mixed with the asphalt material.
2. Measurement. Pulverized asphalt pavement and base course will be measured by the square yard of existing asphalt surface.
3. Payment. Pulverized asphalt pavement and base course will be paid at the contract unit price per square yard which shall be full compensation for pulverizing and all labor, tools, equipment, and incidentals necessary to complete the work in accordance with the contract.
4. Wood County shall provide all shaping and traffic control.
5. The contractor shall furnish to Wood County Highway Department a Certificate of Insurance for Worker's Compensation and an Umbrella Certificate of Liability and Property Insurance in the minimum amount of one million dollars, (\$1,000,000.00) before beginning work and shall notify Wood County Highway Department of any changes or cancellations in insurance coverage.
6. Wood County Highway hours of operation from April 25, 2022 to September 1, 2022 is 6:00 AM – 4:00 PM Monday – Thursday. Only with permission from the Highway Commissioner or County Engineer will work be performed on days outside these hours of operation. The Highway Department can extend the hours Monday – Thursday in most cases to meet the contractor's needs. Work on Friday, Saturday, Sunday and Holidays will be approved on a case by case basis. Contractors should not count on working Fridays.
7. Tentative date of contract award is March 8, 2022.
8. Tentative start date April 25, 2022 or possibly sooner depending on weather.

The following are the proposed projects in Wood County to be milled &/or pulverized:
(Quantities in Square Yards)

Wood County has the right to vary the quantity based on field conditions.

COUNTY TRUNK	LOCATION	COMMENTS	DISTANCE		Mill 2"	Mill 4"	Pulverize 3"	Pulverize 6"	Pulverize 8"
CTH O	STH 66–Portage Co Line	Pulverize Full Depth (6")	4.1	Miles	-	-	-	77,000	-
CTH PP	CTH O - Portage Co Line	Pulverize Full Depth (6")	1.0	Miles	-	-	-	12,900	-
Hemlock Rd	CTH D – west 2 miles	Pulverize Full Depth (3")	2.0	Miles	-	-	25,800	-	-
4 th St	Bruener Ave - Seneca Rd	Village of Port Edwards	.75	Miles	9,500	-	-	-	-
VARIOUS*	YTBD	Undetermined Town Rds			-	-	-	-	-

*There may be additional local government projects, but it is unknown at this time how many S.Y. at unknown depths.

DEPARTMENT'S REQUIREMENTS OF MILLING AND PULVERIZING FOR 2022

April 5, 2022

TO: Wood County Highway Infrastructure and Recreation Committee
555 – 17th Avenue North
Wisconsin Rapids, WI 54495-1966

We, the undersigned, propose to furnish to the Wood County Highway Commission, Wisconsin Rapids, WI the following as herein specified by us in accordance with the Notice of Quotes, Bidding Procedure and Specifications hereto attached:

Department's Requirements for 2022 of:

Milling 2 inches	\$ _____	per S.Y.
Milling 4 inches *YTBD	\$ _____	per S.Y.
Milling Mobilization – To the County	\$ _____	
Milling Mobilization – From Project to Project	\$ _____	
Pulverizing 3 inches	\$ _____	per S.Y.
Pulverizing 6 inches	\$ _____	per S.Y.
Pulverizing 8 inches *YTBD	\$ _____	per S.Y.
Pulverizing Mobilization – To the County	\$ _____	
Pulverizing Mobilization – From Project to Project	\$ _____	

COMPANY NAME OF BIDDER _____

REPRESENTATIVE _____

TITLE _____

ADDRESS _____

PHONE NO. / CELL _____

E-MAIL _____

*YTBD – Yet to be determined.

WOOD COUNTY

NATIONAL WORK ZONE AWARENESS WEEK

APRIL 11 – 15, 2022

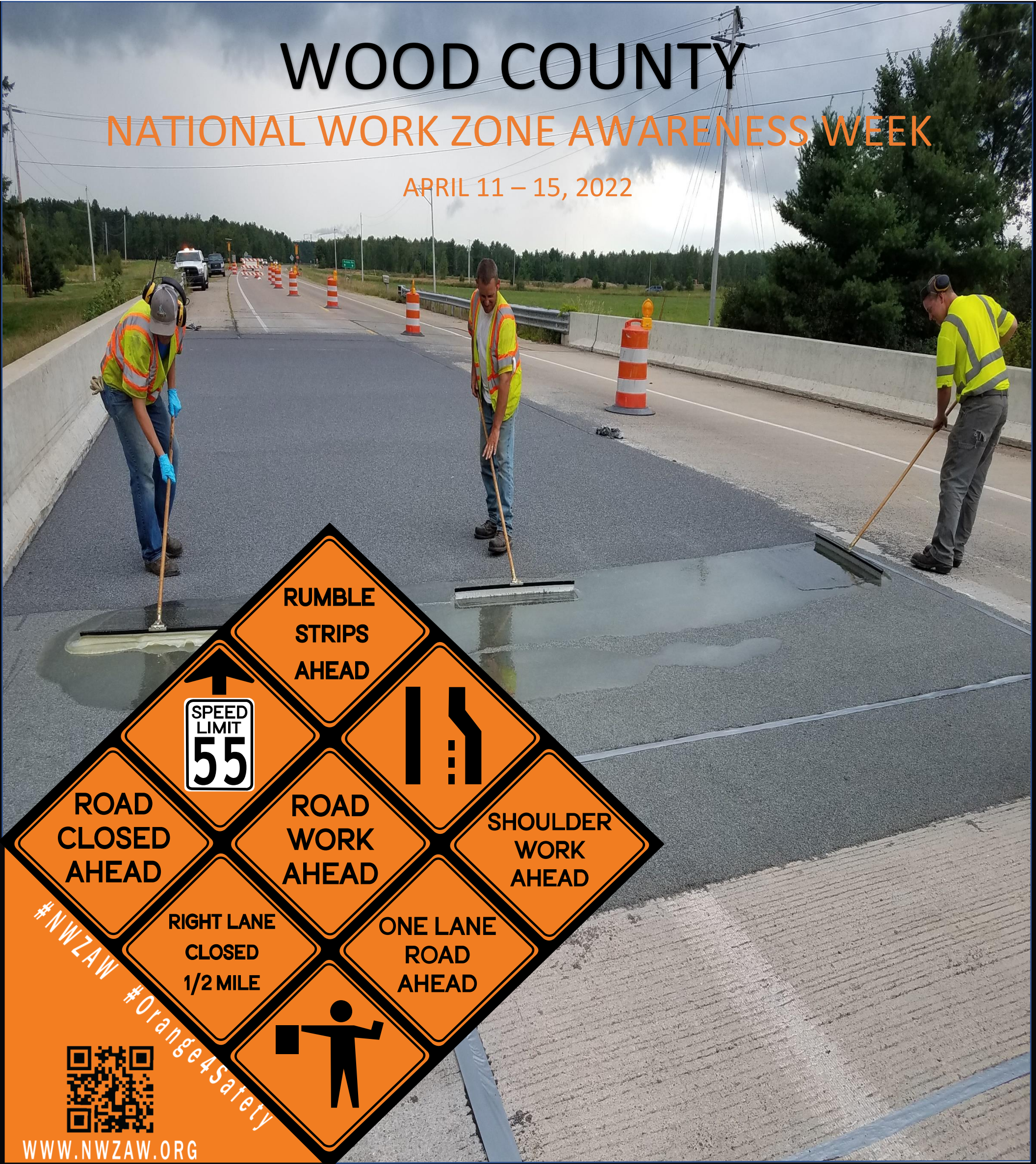

WORK ZONES ARE A **SIGN** TO **SLOW** DOWN



DEDICATED TO SAFE TRANSPORTATION.

RECOGNITION OF WORK ZONE SAFETY AWARENESS WEEK APRIL 11-15, 2022

WHEREAS, in 1999, the Federal Highway Administration partnered with the American Association of State Highway Officials and more recently the American Traffic Safety Services Association to create the National Work Zone Safety Awareness campaign which is held annually in April prior to construction season in much of the nation; and

WHEREAS, the Wisconsin County Highway Association is asking all seventy-two counties in the state to unite and kick off “Work Zone Safety Awareness Week” with recognition and campaign to raise awareness for its workers, the traveling public, public safety workers, and those of various highway contractors performing work for the counties; and

WHEREAS, construction and maintenance activities on our streets and highways periodically require that work zones be established; and

WHEREAS, there has been a yearly average of 2,743 work zones crashes in Wisconsin from 2015 through 2020; and

WHEREAS, in 2020, Wisconsin had 1,805 crashes in road construction and maintenance zones, resulting in 655 injuries and 16 fatalities; and

WHEREAS, between 2015 and 2020, there were 71 fatalities recorded as a result of crashes in Wisconsin work zones including three Wisconsin County Highway workers which were killed in work zones in 2015; and

WHEREAS, through their enforcement activities and other participation, the Wood County Sheriff’s Office, Wisconsin State Patrol, and Wood County Highway Department are committed to working together in 2022 to make Work Zone Awareness Week a success; and

WHEREAS, the Federal Highway Administration has designated April 11 through April 15, 2022 as National Work Zone Awareness Week

NOW, THEREFORE, the Wood County Board of Supervisors recognizes that the week of April 11 through April 15, 2022 be designated as Work Zone Safety Awareness Week in Wood County.

**WOOD COUNTY
CAPITAL IMPROVEMENT PLAN
2023-2027**

#1	Department #	Year	Project #	
	PROJECT #	16	-23	-001
	PROJECT NAME: Bituminous Overlays/Construction			
	START DATE: 1/1/2023			
	END DATE: 12/31/2023			

TOTAL PROJECT COSTS: \$ 4,262,500

#2	DEPARTMENT	16	Highway
	CONTACT PERSON	Roland Hawk	
	TYPE	Other	
	USEFUL LIFE	Beyond 20	
	CATEGORY	Other	
	PRIORITY	Necessary	

PROJECT DESCRIPTION:

Bituminous Overlay/Construction

PROJECT ALTERNATIVES:

None

RELATIONSHIP TO OTHER PROJECTS:

PROJECT JUSTIFICATION Priority from Above Necessary

Replacement of worn driving surfaces

Expenditure Schedule

PRIOR TOTAL

	2023	2024	2025	2026	2027	TOTAL
Planning/Design						-
Land Improvement						-
Construction/Maintenance						-
Equip/Vehicles/Furniture						-
Other	4,262,500					4,262,500
	\$ 4,262,500	\$ -	\$ -	\$ -	\$ -	\$ 4,262,500

FUTURE TOTAL

Funding Sources

PRIOR TOTAL

	2023	2024	2025	2026	2027	TOTAL
Tax Levy						-
Debt	3,189,403					3,189,403
State/Federal Grant	1,073,097					1,073,097
Departmental Rent						-
User Fees						-
Donations & Contributions						-
Other						-
	\$ 4,262,500	\$ -	\$ -	\$ -	\$ -	\$ 4,262,500

FUTURE TOTAL

OPERATIONAL IMPACT/OTHER

Operating Budget Impact

PRIOR TOTAL

	2023	2024	2025	2026	2027	TOTAL
Salaries & Fringes						-
Professional Services						-
Supplies/Materials						-
Depreciation						-
Other (Insurance, Utilities)						-
Principal & Interest						-
	\$ -	\$ -	\$ -	\$ -	\$ -	\$ -

FUTURE TOTAL

**WOOD COUNTY
CAPITAL IMPROVEMENT PLAN
2023-2027**

#1	Department #	Year	Project #	
	PROJECT #	16	-23	-002
	PROJECT NAME: Bridge Rehabilitation/Engineering			
	START DATE:	1/1/2023		
	END DATE:	12/31/2023		

TOTAL PROJECT COSTS: \$ 65,000

#2	DEPARTMENT	16	Highway
	CONTACT PERSON	Roland Hawk	
	TYPE	Other	
	USEFUL LIFE	Beyond 20	
	CATEGORY	Other	
	PRIORITY	Necessary	

PROJECT DESCRIPTION:

Bridge Rehabilitation/Engineering

PROJECT ALTERNATIVES:

None

RELATIONSHIP TO OTHER PROJECTS:

PROJECT JUSTIFICATION Priority from Above **Necessary**

Rehabilitation of worn bridge structure

Expenditure Schedule

PRIOR TOTAL

	2023	2024	2025	2026	2027	TOTAL
Planning/Design						-
Land Improvement						-
Construction/Maintenance						-
Equip/Vehicles/Furniture						-
Other	65,000					65,000
	\$ 65,000	\$ -	\$ -	\$ -	\$ -	\$ 65,000

FUTURE TOTAL

Funding Sources

PRIOR TOTAL

	2023	2024	2025	2026	2027	TOTAL
Tax Levy						-
Debt	65,000					65,000
State/Federal Grant						-
Departmental Rent						-
User Fees						-
Donations & Contributions						-
Other						-
	\$ 65,000	\$ -	\$ -	\$ -	\$ -	\$ 65,000

FUTURE TOTAL

OPERATIONAL IMPACT/OTHER

Operating Budget Impact

PRIOR TOTAL

	2023	2024	2025	2026	2027	TOTAL
Salaries & Fringes						-
Professional Services						-
Supplies/Materials						-
Depreciation						-
Other (Insurance, Utilities)						-
Principal & Interest						-
	\$ -	\$ -	\$ -	\$ -	\$ -	\$ -

FUTURE TOTAL

**WOOD COUNTY
CAPITAL IMPROVEMENT PLAN
2023-2027**

#1	Department #	Year	Project #	
PROJECT #	16	-23	-003	16-23-003
PROJECT NAME:	Asphalt Plant Drum (2nd Half)			
START DATE:	1/1/2023			
END DATE:	12/31/2023			

TOTAL PROJECT COSTS: \$ 200,000

#2	DEPARTMENT	16	Highway
	CONTACT PERSON	Roland Hawk	
	TYPE	Equipment	
	USEFUL LIFE	10- 20	
	CATEGORY	Major Equipment	
	PRIORITY	Necessary	

PROJECT DESCRIPTION:

Installation of Asphalt Plant Drum

PROJECT ALTERNATIVES:

None

RELATIONSHIP TO OTHER PROJECTS:

PROJECT JUSTIFICATION Priority from Above **Necessary**

Necessary to continue the operation of the Asphalt Plant

Expenditure Schedule

PRIOR TOTAL

	2023	2024	2025	2026	2027	TOTAL
Planning/Design						-
Land Improvement						-
Construction/Maintenance						-
Equip/Vehicles/Furniture						-
Other	200,000					200,000
	\$ 200,000	\$ -	\$ -	\$ -	\$ -	\$ 200,000

FUTURE TOTAL

Funding Sources

PRIOR TOTAL

	2023	2024	2025	2026	2027	TOTAL
Tax Levy						-
Debt						-
State/Federal Grant						-
Departmental Rent						-
User Fees	200,000					200,000
Donations & Contributions						-
Other						-
	\$ 200,000	\$ -	\$ -	\$ -	\$ -	\$ 200,000

FUTURE TOTAL

OPERATIONAL IMPACT/OTHER

Maintenance expenses may decrease

Operating Budget Impact

PRIOR TOTAL

	2023	2024	2025	2026	2027	TOTAL
Salaries & Fringes						-
Professional Services						-
Supplies/Materials						-
Depreciation						-
Other (Insurance, Utilities)						-
Principal & Interest						-
	\$ -	\$ -	\$ -	\$ -	\$ -	\$ -

FUTURE TOTAL

**WOOD COUNTY
CAPITAL IMPROVEMENT PLAN
2023-2027**

#1	Department #	Year	Project #	
PROJECT #	16	-23	-004	16-23-004
PROJECT NAME:	Roof for Heated Storage			
START DATE:	1/1/2023			
END DATE:	12/31/2023			

TOTAL PROJECT COSTS: \$ 150,000

#2	DEPARTMENT	16	Highway
	CONTACT PERSON	Roland Hawk	
	TYPE	Building Improvements	
	USEFUL LIFE	10- 20	
	CATEGORY	Building	
	PRIORITY	Necessary	

PROJECT DESCRIPTION:

Replacement of heated storage roof

PROJECT ALTERNATIVES:

None

RELATIONSHIP TO OTHER PROJECTS:

PROJECT JUSTIFICATION Priority from Above Necessary

Replacement of leaking roof

Expenditure Schedule

PRIOR TOTAL

	2023	2024	2025	2026	2027	TOTAL
Planning/Design						-
Land Improvement						-
Construction/Maintenance	150,000					150,000
Equip/Vehicles/Furniture						-
Other						-
	\$ 150,000	\$ -	\$ -	\$ -	\$ -	\$ 150,000

FUTURE TOTAL

Funding Sources

PRIOR TOTAL

	2023	2024	2025	2026	2027	TOTAL
Tax Levy						-
Debt						-
State/Federal Grant						-
Departmental Rent						-
User Fees	150,000					150,000
Donations & Contributions						-
Other						-
	\$ 150,000	\$ -	\$ -	\$ -	\$ -	\$ 150,000

FUTURE TOTAL

OPERATIONAL IMPACT/OTHER

Heating expenses may decrease

Operating Budget Impact

PRIOR TOTAL

	2023	2024	2025	2026	2027	TOTAL
Salaries & Fringes						-
Professional Services						-
Supplies/Materials						-
Depreciation						-
Other (Insurance, Utilities)						-
Principal & Interest						-
	\$ -	\$ -	\$ -	\$ -	\$ -	\$ -

FUTURE TOTAL

**WOOD COUNTY
CAPITAL IMPROVEMENT PLAN
2023-2027**

#1	Department #	Year	Project #	
PROJECT #	16	-23	-005	16-23-005
PROJECT NAME:	One Patrol Truck			
START DATE:	1/1/2023			
END DATE:	12/31/2023			

TOTAL PROJECT COSTS: \$ 250,000

#2	DEPARTMENT	16	Highway
	CONTACT PERSON	Roland Hawk	
	TYPE	Vehicles-Highway	
	USEFUL LIFE	5 - 10	
	CATEGORY	Vehicle	
	PRIORITY	Necessary	

PROJECT DESCRIPTION:

One patrol truck

PROJECT ALTERNATIVES:

None

RELATIONSHIP TO OTHER PROJECTS:

PROJECT JUSTIFICATION Priority from Above **Necessary**

Replacement of equipment

Expenditure Schedule

PRIOR TOTAL

	2023	2024	2025	2026	2027	TOTAL
Planning/Design						-
Land Improvement						-
Construction/Maintenance						-
Equip/Vehicles/Furniture	250,000					250,000
Other						-
	\$ 250,000	\$ -	\$ -	\$ -	\$ -	\$ 250,000

FUTURE TOTAL

Funding Sources

PRIOR TOTAL

	2023	2024	2025	2026	2027	TOTAL
Tax Levy						-
Debt						-
State/Federal Grant						-
Departmental Rent						-
User Fees	250,000					250,000
Donations & Contributions						-
Other						-
	\$ 250,000	\$ -	\$ -	\$ -	\$ -	\$ 250,000

FUTURE TOTAL

OPERATIONAL IMPACT/OTHER

Maintenance expenses may decrease

Operating Budget Impact

PRIOR TOTAL

	2023	2024	2025	2026	2027	TOTAL
Salaries & Fringes						-
Professional Services						-
Supplies/Materials						-
Depreciation						-
Other (Insurance, Utilities)						-
Principal & Interest						-
	\$ -	\$ -	\$ -	\$ -	\$ -	\$ -

FUTURE TOTAL

**WOOD COUNTY
CAPITAL IMPROVEMENT PLAN
2023-2027**

#1	Department #	Year	Project #	
PROJECT #	16	-23	-006	16-23-006
PROJECT NAME:	Quad Axle Truck			
START DATE:	1/1/2023			
END DATE:	12/31/2023			

TOTAL PROJECT COSTS: \$ 150,000

#2	DEPARTMENT	16	Highway
	CONTACT PERSON	Roland Hawk	
	TYPE	Vehicles-Highway	
	USEFUL LIFE	5 - 10	
	CATEGORY	Vehicle	
	PRIORITY	Necessary	

PROJECT DESCRIPTION:

Quad axle truck

PROJECT ALTERNATIVES:

None

RELATIONSHIP TO OTHER PROJECTS:

PROJECT JUSTIFICATION Priority from Above Necessary

Replacement of equipment

Expenditure Schedule

PRIOR TOTAL

	2023	2024	2025	2026	2027	TOTAL
Planning/Design						-
Land Improvement						-
Construction/Maintenance						-
Equip/Vehicles/Furniture	150,000					150,000
Other						-
	\$ 150,000	\$ -	\$ -	\$ -	\$ -	\$ 150,000

FUTURE TOTAL

Funding Sources

PRIOR TOTAL

	2023	2024	2025	2026	2027	TOTAL
Tax Levy						-
Debt						-
State/Federal Grant						-
Departmental Rent						-
User Fees	150,000					150,000
Donations & Contributions						-
Other						-
	\$ 150,000	\$ -	\$ -	\$ -	\$ -	\$ 150,000

FUTURE TOTAL

OPERATIONAL IMPACT/OTHER

Maintenance expenses may decrease

Operating Budget Impact

PRIOR TOTAL

	2023	2024	2025	2026	2027	TOTAL
Salaries & Fringes						-
Professional Services						-
Supplies/Materials						-
Depreciation						-
Other (Insurance, Utilities)						-
Principal & Interest						-
	\$ -	\$ -	\$ -	\$ -	\$ -	\$ -

FUTURE TOTAL

**WOOD COUNTY
CAPITAL IMPROVEMENT PLAN
2023-2027**

#1	Department #	Year	Project #	
	PROJECT #	16	-24	-001
	PROJECT NAME: Bituminous Overlay/Constructon			
	START DATE: 1/1/2024			
	END DATE: 12/31/2024			

TOTAL PROJECT COSTS: \$ 3,100,000

#2	DEPARTMENT	16	Highway
	CONTACT PERSON	Roland Hawk	
	TYPE	Other	
	USEFUL LIFE	Beyond 20	
	CATEGORY	Other	
PRIORITY	Necessary		

PROJECT DESCRIPTION:

Bituminous overlay/construction

PROJECT ALTERNATIVES:

None

RELATIONSHIP TO OTHER PROJECTS:

PROJECT JUSTIFICATION Priority from Above Necessary

Replacement of worn driving surfaces

Expenditure Schedule

PRIOR TOTAL

	2023	2024	2025	2026	2027	TOTAL
Planning/Design						-
Land Improvement						-
Construction/Maintenance						-
Equip/Vehicles/Furniture						-
Other		3,100,000				3,100,000
	\$ -	\$ 3,100,000	\$ -	\$ -	\$ -	\$ 3,100,000

FUTURE TOTAL

Funding Sources

PRIOR TOTAL

	2023	2024	2025	2026	2027	TOTAL
Tax Levy						-
Debt		2,243,391				2,243,391
State/Federal Grant		856,609				856,609
Departmental Rent						-
User Fees						-
Donations & Contributions						-
Other						-
	\$ -	\$ 3,100,000	\$ -	\$ -	\$ -	\$ 3,100,000

FUTURE TOTAL

OPERATIONAL IMPACT/OTHER

Operating Budget Impact

PRIOR TOTAL

	2023	2024	2025	2026	2027	TOTAL
Salaries & Fringes						-
Professional Services						-
Supplies/Materials						-
Depreciation						-
Other (Insurance, Utilities)						-
Principal & Interest						-
	\$ -	\$ -	\$ -	\$ -	\$ -	\$ -

FUTURE TOTAL

**WOOD COUNTY
CAPITAL IMPROVEMENT PLAN
2023-2027**

#1	Department #	Year	Project #	
	PROJECT #	16	-24	-002
	PROJECT NAME: Bridge Deck Rehabilitation			
	START DATE: 1/1/2024			
	END DATE: 12/31/2024			

TOTAL PROJECT COSTS: \$ 750,000

#2	DEPARTMENT	16	Highway
	CONTACT PERSON	Roland Hawk	
	TYPE	Other	
	USEFUL LIFE	Beyond 20	
	CATEGORY	Other	
	PRIORITY	Necessary	

PROJECT DESCRIPTION:

Bridge deck rehabilitation

PROJECT ALTERNATIVES:

None

RELATIONSHIP TO OTHER PROJECTS:

PROJECT JUSTIFICATION Priority from Above Necessary

Replacement of worn bridge deck

Expenditure Schedule

PRIOR TOTAL

	2023	2024	2025	2026	2027	TOTAL
Planning/Design						-
Land Improvement						-
Construction/Maintenance						-
Equip/Vehicles/Furniture						-
Other		750,000				750,000
	\$ -	\$ 750,000	\$ -	\$ -	\$ -	\$ 750,000

FUTURE TOTAL

Funding Sources

PRIOR TOTAL

	2023	2024	2025	2026	2027	TOTAL
Tax Levy						-
Debt		490,000				490,000
State/Federal Grant		260,000				260,000
Departmental Rent						-
User Fees						-
Donations & Contributions						-
Other						-
	\$ -	\$ 750,000	\$ -	\$ -	\$ -	\$ 750,000

FUTURE TOTAL

OPERATIONAL IMPACT/OTHER

Operating Budget Impact

PRIOR TOTAL

	2023	2024	2025	2026	2027	TOTAL
Salaries & Fringes						-
Professional Services						-
Supplies/Materials						-
Depreciation						-
Other (Insurance, Utilities)						-
Principal & Interest						-
	\$ -	\$ -	\$ -	\$ -	\$ -	\$ -

FUTURE TOTAL

**WOOD COUNTY
CAPITAL IMPROVEMENT PLAN
2023-2027**

#1	Department #	Year	Project #	
	PROJECT #	16	-24	-003
	PROJECT NAME: Two (2) Patrol Trucks			
	START DATE: 1/1/2024			
	END DATE: 12/31/2024			

TOTAL PROJECT COSTS: \$ 375,000

#2	DEPARTMENT	16	Highway
	CONTACT PERSON	Roland Hawk	
	TYPE	Equipment-Moveable	
	USEFUL LIFE	5 - 10	
	CATEGORY	Vehicle	
PRIORITY	Necessary		

PROJECT DESCRIPTION:

Two (2) Patrol Trucks

PROJECT ALTERNATIVES:

None

RELATIONSHIP TO OTHER PROJECTS:

PROJECT JUSTIFICATION Priority from Above Necessary

Replacement of Equipment

Expenditure Schedule

PRIOR TOTAL

	2023	2024	2025	2026	2027	TOTAL
Planning/Design						-
Land Improvement						-
Construction/Maintenance						-
Equip/Vehicles/Furniture		375,000				375,000
Other						-
	\$ -	\$ 375,000	\$ -	\$ -	\$ -	\$ 375,000

FUTURE TOTAL

Funding Sources

PRIOR TOTAL

	2023	2024	2025	2026	2027	TOTAL
Tax Levy						-
Debt						-
State/Federal Grant						-
Departmental Rent						-
User Fees		375,000				375,000
Donations & Contributions						-
Other						-
	\$ -	\$ 375,000	\$ -	\$ -	\$ -	\$ 375,000

FUTURE TOTAL

OPERATIONAL IMPACT/OTHER

Maintenance expenses may decrease

Operating Budget Impact

PRIOR TOTAL

	2023	2024	2025	2026	2027	TOTAL
Salaries & Fringes						-
Professional Services						-
Supplies/Materials						-
Depreciation						-
Other (Insurance, Utilities)						-
Principal & Interest						-
	\$ -	\$ -	\$ -	\$ -	\$ -	\$ -

FUTURE TOTAL

**WOOD COUNTY
CAPITAL IMPROVEMENT PLAN
2023-2027**

#1	Department #	Year	Project #	
PROJECT #	16	-24	-004	16-24-004
PROJECT NAME:	Patrol Superintendent Truck			
START DATE:				
END DATE:				

TOTAL PROJECT COSTS: \$ 50,000

#2	DEPARTMENT	16	Highway
	CONTACT PERSON	Roland Hawk	
	TYPE	Vehicles-Highway	
	USEFUL LIFE	5 - 10	
	CATEGORY	Vehicle	
	PRIORITY	Necessary	

PROJECT DESCRIPTION:

Patrol Superintendent truck

PROJECT ALTERNATIVES:

None

RELATIONSHIP TO OTHER PROJECTS:

PROJECT JUSTIFICATION Priority from Above **Necessary**

Replacement of equipment

Expenditure Schedule

PRIOR TOTAL

	2023	2024	2025	2026	2027	TOTAL
Planning/Design						-
Land Improvement						-
Construction/Maintenance						-
Equip/Vehicles/Furniture		50,000				50,000
Other						-
	\$ -	\$ 50,000	\$ -	\$ -	\$ -	\$ 50,000

FUTURE TOTAL

Funding Sources

PRIOR TOTAL

	2023	2024	2025	2026	2027	TOTAL
Tax Levy						-
Debt						-
State/Federal Grant						-
Departmental Rent						-
User Fees		50,000				50,000
Donations & Contributions						-
Other						-
	\$ -	\$ 50,000	\$ -	\$ -	\$ -	\$ 50,000

FUTURE TOTAL

OPERATIONAL IMPACT/OTHER

Maintenance expenses may decrease

Operating Budget Impact

PRIOR TOTAL

	2023	2024	2025	2026	2027	TOTAL
Salaries & Fringes						-
Professional Services						-
Supplies/Materials						-
Depreciation						-
Other (Insurance, Utilities)						-
Principal & Interest						-
	\$ -	\$ -	\$ -	\$ -	\$ -	\$ -

FUTURE TOTAL

**WOOD COUNTY
CAPITAL IMPROVEMENT PLAN
2023-2027**

#1	Department #	Year	Project #	
	PROJECT #	16	-24	-005
	PROJECT NAME: Two (2) Rubber Tire Excavators			
	START DATE: 1/1/2024			
	END DATE: 12/31/2024			

TOTAL PROJECT COSTS: \$ 300,000

#2	DEPARTMENT	16	Highway
	CONTACT PERSON	Roland Hawk	
	TYPE	Equipment-Moveable	
	USEFUL LIFE	5 - 10	
	CATEGORY	Major Equipment	
PRIORITY	Necessary		

PROJECT DESCRIPTION:

Two (2) Rubber Tire Excavators

PROJECT ALTERNATIVES:

None

RELATIONSHIP TO OTHER PROJECTS:

PROJECT JUSTIFICATION Priority from Above Necessary

Replacement of Equipment

Expenditure Schedule

PRIOR TOTAL

	2023	2024	2025	2026	2027	TOTAL
Planning/Design						-
Land Improvement						-
Construction/Maintenance						-
Equip/Vehicles/Furniture		300,000				300,000
Other						-
	\$ -	\$ 300,000	\$ -	\$ -	\$ -	\$ 300,000

FUTURE TOTAL

Funding Sources

PRIOR TOTAL

	2023	2024	2025	2026	2027	TOTAL
Tax Levy						-
Debt						-
State/Federal Grant						-
Departmental Rent						-
User Fees		300,000				300,000
Donations & Contributions						-
Other						-
	\$ -	\$ 300,000	\$ -	\$ -	\$ -	\$ 300,000

FUTURE TOTAL

OPERATIONAL IMPACT/OTHER

Maintenance expenses may decrease

Operating Budget Impact

PRIOR TOTAL

	2023	2024	2025	2026	2027	TOTAL
Salaries & Fringes						-
Professional Services						-
Supplies/Materials						-
Depreciation						-
Other (Insurance, Utilities)						-
Principal & Interest						-
	\$ -	\$ -	\$ -	\$ -	\$ -	\$ -

FUTURE TOTAL

**WOOD COUNTY
CAPITAL IMPROVEMENT PLAN
2023-2027**

#1	Department #	Year	Project #	
PROJECT #	16	-25	-001	16-25-001
PROJECT NAME:	Bridge Replacement			
START DATE:	1/1/2025			
END DATE:	12/31/2025			

TOTAL PROJECT COSTS: \$ 1,100,000

#2	DEPARTMENT	16	Highway
	CONTACT PERSON	Roland Hawk	
	TYPE	Other	
	USEFUL LIFE	Beyond 20	
	CATEGORY	Other	
	PRIORITY	Necessary	

PROJECT DESCRIPTION:

Bridge Replacement

PROJECT ALTERNATIVES:

None

RELATIONSHIP TO OTHER PROJECTS:

PROJECT JUSTIFICATION Priority from Above Necessary

Replacement of worn bridges

Expenditure Schedule

PRIOR TOTAL

	2023	2024	2025	2026	2027	TOTAL
Planning/Design						-
Land Improvement						-
Construction/Maintenance						-
Equip/Vehicles/Furniture						-
Other			1,100,000			1,100,000
	\$ -	\$ -	\$ 1,100,000	\$ -	\$ -	\$ 1,100,000

FUTURE TOTAL

Funding Sources

PRIOR TOTAL

	2023	2024	2025	2026	2027	TOTAL
Tax Levy						-
Debt			1,100,000			1,100,000
State/Federal Grant						-
Departmental Rent						-
User Fees						-
Donations & Contributions						-
Other						-
	\$ -	\$ -	\$ 1,100,000	\$ -	\$ -	\$ 1,100,000

FUTURE TOTAL

OPERATIONAL IMPACT/OTHER

Operating Budget Impact

PRIOR TOTAL

	2023	2024	2025	2026	2027	TOTAL
Salaries & Fringes						-
Professional Services						-
Supplies/Materials						-
Depreciation						-
Other (Insurance, Utilities)						-
Principal & Interest						-
	\$ -	\$ -	\$ -	\$ -	\$ -	\$ -

FUTURE TOTAL

**WOOD COUNTY
CAPITAL IMPROVEMENT PLAN
2023-2027**

#1	Department #	Year	Project #		
	PROJECT #	16	-25	-002	16-25-002
	PROJECT NAME:	Bituminous Overlay/Construction			
	START DATE:	1/1/2025			
	END DATE:	12/31/2025			

TOTAL PROJECT COSTS: \$ 3,600,000

#2	DEPARTMENT	16	Highway
	CONTACT PERSON	Roland Hawk	
	TYPE	Other	
	USEFUL LIFE	Beyond 20	
	CATEGORY	Other	
PRIORITY	Necessary		

PROJECT DESCRIPTION:

Bituminous overlay/construction

PROJECT ALTERNATIVES:

None

RELATIONSHIP TO OTHER PROJECTS:

PROJECT JUSTIFICATION Priority from Above Necessary

Replacement of worn driving surfaces

Expenditure Schedule

PRIOR TOTAL

	2023	2024	2025	2026	2027	TOTAL
Planning/Design						-
Land Improvement						-
Construction/Maintenance						-
Equip/Vehicles/Furniture						-
Other			3,600,000			3,600,000
	\$ -	\$ -	\$ 3,600,000	\$ -	\$ -	\$ 3,600,000

FUTURE TOTAL

Funding Sources

PRIOR TOTAL

	2023	2024	2025	2026	2027	TOTAL
Tax Levy						-
Debt			3,100,000			3,100,000
State/Federal Grant			500,000			500,000
Departmental Rent						-
User Fees						-
Donations & Contributions						-
Other						-
	\$ -	\$ -	\$ 3,600,000	\$ -	\$ -	\$ 3,600,000

FUTURE TOTAL

OPERATIONAL IMPACT/OTHER

Operating Budget Impact

PRIOR TOTAL

	2023	2024	2025	2026	2027	TOTAL
Salaries & Fringes						-
Professional Services						-
Supplies/Materials						-
Depreciation						-
Other (Insurance, Utilities)						-
Principal & Interest						-
	\$ -	\$ -	\$ -	\$ -	\$ -	\$ -

FUTURE TOTAL

**WOOD COUNTY
CAPITAL IMPROVEMENT PLAN
2023-2027**

#1	Department #	Year	Project #	
PROJECT #	16	-25	-003	16-25-003
PROJECT NAME:	One (1) Patrol Truck			
START DATE:	1/1/2025			
END DATE:	12/31/2025			

TOTAL PROJECT COSTS: \$ 375,000

#2	DEPARTMENT	16	Highway
	CONTACT PERSON	Roland Hawk	
	TYPE	Equipment-Moveable	
	USEFUL LIFE	5 - 10	
	CATEGORY	Major Equipment	
	PRIORITY	Necessary	

PROJECT DESCRIPTION:

One (1) Patrol Truck

PROJECT ALTERNATIVES:

None

RELATIONSHIP TO OTHER PROJECTS:

PROJECT JUSTIFICATION Priority from Above Necessary

Replacement of equipment

Expenditure Schedule

PRIOR TOTAL

	2023	2024	2025	2026	2027	TOTAL
Planning/Design						-
Land Improvement						-
Construction/Maintenance						-
Equip/Vehicles/Furniture			375,000			375,000
Other						-
	\$ -	\$ -	\$ 375,000	\$ -	\$ -	\$ 375,000

FUTURE TOTAL

Funding Sources

PRIOR TOTAL

	2023	2024	2025	2026	2027	TOTAL
Tax Levy						-
Debt						-
State/Federal Grant						-
Departmental Rent						-
User Fees			375,000			375,000
Donations & Contributions						-
Other						-
	\$ -	\$ -	\$ 375,000	\$ -	\$ -	\$ 375,000

FUTURE TOTAL

OPERATIONAL IMPACT/OTHER

Maintenance expenses may decrease

Operating Budget Impact

PRIOR TOTAL

	2023	2024	2025	2026	2027	TOTAL
Salaries & Fringes						-
Professional Services						-
Supplies/Materials						-
Depreciation						-
Other (Insurance, Utilities)						-
Principal & Interest						-
	\$ -	\$ -	\$ -	\$ -	\$ -	\$ -

FUTURE TOTAL

**WOOD COUNTY
CAPITAL IMPROVEMENT PLAN
2023-2027**

#1	Department #	Year	Project #	
PROJECT #	16	-25	-004	16-25-004
PROJECT NAME:	Asphalt Plant Loader			
START DATE:	1/1/2025			
END DATE:	12/31/2025			

TOTAL PROJECT COSTS: \$ 250,000

#2	DEPARTMENT	16	Highway
	CONTACT PERSON	Roland Hawk	
	TYPE	Equipment-Moveable	
	USEFUL LIFE	5 - 10	
	CATEGORY	Major Equipment	
	PRIORITY	Necessary	

PROJECT DESCRIPTION:

Asphalt plant loader

PROJECT ALTERNATIVES:

None

RELATIONSHIP TO OTHER PROJECTS:

PROJECT JUSTIFICATION Priority from Above Necessary

Replacement of equipment

Expenditure Schedule

PRIOR TOTAL

	2023	2024	2025	2026	2027	TOTAL
Planning/Design						-
Land Improvement						-
Construction/Maintenance						-
Equip/Vehicles/Furniture			250,000			250,000
Other						-
	\$ -	\$ -	\$ 250,000	\$ -	\$ -	\$ 250,000

FUTURE TOTAL

Funding Sources

PRIOR TOTAL

	2023	2024	2025	2026	2027	TOTAL
Tax Levy						-
Debt						-
State/Federal Grant						-
Departmental Rent						-
User Fees			250,000			250,000
Donations & Contributions						-
Other						-
	\$ -	\$ -	\$ 250,000	\$ -	\$ -	\$ 250,000

FUTURE TOTAL

OPERATIONAL IMPACT/OTHER

Maintenance expenses may decrease

Operating Budget Impact

PRIOR TOTAL

	2023	2024	2025	2026	2027	TOTAL
Salaries & Fringes						-
Professional Services						-
Supplies/Materials						-
Depreciation						-
Other (Insurance, Utilities)						-
Principal & Interest						-
	\$ -	\$ -	\$ -	\$ -	\$ -	\$ -

FUTURE TOTAL

**WOOD COUNTY
CAPITAL IMPROVEMENT PLAN
2023-2027**

#1	Department #	Year	Project #	
	PROJECT #	16	-25	-005
	PROJECT NAME: Pressure Washer			
	START DATE: 1/1/2025			
	END DATE: 12/31/2025			

TOTAL PROJECT COSTS: \$ 50,000

#2	DEPARTMENT	16	Highway
	CONTACT PERSON	Roland Hawk	
	TYPE	Equipment-Moveable	
	USEFUL LIFE	5 - 10	
	CATEGORY	Major Equipment	
PRIORITY	Necessary		

PROJECT DESCRIPTION:

Pressure washer

PROJECT ALTERNATIVES:

None

RELATIONSHIP TO OTHER PROJECTS:

PROJECT JUSTIFICATION Priority from Above Necessary

Replacement of equipment

Expenditure Schedule

PRIOR TOTAL

	2023	2024	2025	2026	2027	TOTAL
Planning/Design						-
Land Improvement						-
Construction/Maintenance						-
Equip/Vehicles/Furniture			50,000			50,000
Other						-
	\$ -	\$ -	\$ 50,000	\$ -	\$ -	\$ 50,000

FUTURE TOTAL

Funding Sources

PRIOR TOTAL

	2023	2024	2025	2026	2027	TOTAL
Tax Levy						-
Debt						-
State/Federal Grant						-
Departmental Rent						-
User Fees			50,000			50,000
Donations & Contributions						-
Other						-
	\$ -	\$ -	\$ 50,000	\$ -	\$ -	\$ 50,000

FUTURE TOTAL

OPERATIONAL IMPACT/OTHER

Maintenance expenses may decrease

Operating Budget Impact

PRIOR TOTAL

	2023	2024	2025	2026	2027	TOTAL
Salaries & Fringes						-
Professional Services						-
Supplies/Materials						-
Depreciation						-
Other (Insurance, Utilities)						-
Principal & Interest						-
	\$ -	\$ -	\$ -	\$ -	\$ -	\$ -

FUTURE TOTAL

**WOOD COUNTY
CAPITAL IMPROVEMENT PLAN
2023-2027**

#1	Department #	Year	Project #	
PROJECT #	16	-25	-006	16-25-006
PROJECT NAME:	Grader			
START DATE:	1/1/2025			
END DATE:	12/31/2025			

TOTAL PROJECT COSTS: \$ 350,000

#2	DEPARTMENT	16	Highway
	CONTACT PERSON	Roland Hawk	
	TYPE	Equipment-Moveable	
	USEFUL LIFE	5 - 10	
	CATEGORY	Major Equipment	
	PRIORITY	Necessary	

PROJECT DESCRIPTION:

Grader

PROJECT ALTERNATIVES:

None

RELATIONSHIP TO OTHER PROJECTS:

PROJECT JUSTIFICATION Priority from Above **Necessary**

Replacement of equipment

Expenditure Schedule

PRIOR TOTAL

	2023	2024	2025	2026	2027	TOTAL
Planning/Design						-
Land Improvement						-
Construction/Maintenance						-
Equip/Vehicles/Furniture			350,000			350,000
Other						-
	\$ -	\$ -	\$ 350,000	\$ -	\$ -	\$ 350,000

FUTURE TOTAL

Funding Sources

PRIOR TOTAL

	2023	2024	2025	2026	2027	TOTAL
Tax Levy						-
Debt						-
State/Federal Grant						-
Departmental Rent						-
User Fees			350,000			350,000
Donations & Contributions						-
Other						-
	\$ -	\$ -	\$ 350,000	\$ -	\$ -	\$ 350,000

FUTURE TOTAL

OPERATIONAL IMPACT/OTHER

Maintenance expenses may decrease

Operating Budget Impact

PRIOR TOTAL

	2023	2024	2025	2026	2027	TOTAL
Salaries & Fringes						-
Professional Services						-
Supplies/Materials						-
Depreciation						-
Other (Insurance, Utilities)						-
Principal & Interest						-
	\$ -	\$ -	\$ -	\$ -	\$ -	\$ -

FUTURE TOTAL

**WOOD COUNTY
CAPITAL IMPROVEMENT PLAN
2023-2027**

#1	Department #	Year	Project #	
	PROJECT #	16	-26	-001
	PROJECT NAME: Bridge Replacement			
	START DATE: 1/1/2026			
	END DATE: 12/31/2026			

TOTAL PROJECT COSTS: \$ 360,000

#2	DEPARTMENT	16	Highway
	CONTACT PERSON	Roland Hawk	
	TYPE	Other	
	USEFUL LIFE	Beyond 20	
	CATEGORY	Other	
	PRIORITY	Necessary	

PROJECT DESCRIPTION:

Bridge Replacement

PROJECT ALTERNATIVES:

None

RELATIONSHIP TO OTHER PROJECTS:

PROJECT JUSTIFICATION Priority from Above Necessary

Replacement of worn bridge structure

Expenditure Schedule

PRIOR TOTAL

	2023	2024	2025	2026	2027	TOTAL
Planning/Design						-
Land Improvement						-
Construction/Maintenance						-
Equip/Vehicles/Furniture						-
Other				360,000		360,000
	\$ -	\$ -	\$ -	\$ 360,000	\$ -	\$ 360,000

FUTURE TOTAL

Funding Sources

PRIOR TOTAL

	2023	2024	2025	2026	2027	TOTAL
Tax Levy						-
Debt				360,000		360,000
State/Federal Grant						-
Departmental Rent						-
User Fees						-
Donations & Contributions						-
Other						-
	\$ -	\$ -	\$ -	\$ 360,000	\$ -	\$ 360,000

FUTURE TOTAL

OPERATIONAL IMPACT/OTHER

Operating Budget Impact

PRIOR TOTAL

	2023	2024	2025	2026	2027	TOTAL
Salaries & Fringes						-
Professional Services						-
Supplies/Materials						-
Depreciation						-
Other (Insurance, Utilities)						-
Principal & Interest						-
	\$ -	\$ -	\$ -	\$ -	\$ -	\$ -

FUTURE TOTAL

**WOOD COUNTY
CAPITAL IMPROVEMENT PLAN
2023-2027**

#1	Department #	Year	Project #	
	PROJECT #	16	-26	-002
	PROJECT NAME: Bituminous Overlay/Construction			
	START DATE: 1/1/2026			
	END DATE: 12/31/2026			

TOTAL PROJECT COSTS: \$ 2,830,000

#2	DEPARTMENT	16	Highway
	CONTACT PERSON	Roland Hawk	
	TYPE	Other	
	USEFUL LIFE	Beyond 20	
	CATEGORY	Other	
	PRIORITY	Necessary	

PROJECT DESCRIPTION:

Bituminous Overlay/Construction

PROJECT ALTERNATIVES:

None

RELATIONSHIP TO OTHER PROJECTS:

PROJECT JUSTIFICATION Priority from Above Necessary

Replacement of worn driving surfaces

Expenditure Schedule

PRIOR TOTAL

	2023	2024	2025	2026	2027	TOTAL
Planning/Design						-
Land Improvement						-
Construction/Maintenance						-
Equip/Vehicles/Furniture						-
Other				2,830,000		2,830,000
	\$ -	\$ -	\$ -	\$ 2,830,000	\$ -	\$ 2,830,000

FUTURE TOTAL

Funding Sources

PRIOR TOTAL

	2023	2024	2025	2026	2027	TOTAL
Tax Levy						-
Debt				2,610,000		2,610,000
State/Federal Grant				220,000		220,000
Departmental Rent						-
User Fees						-
Donations & Contributions						-
Other						-
	\$ -	\$ -	\$ -	\$ 2,830,000	\$ -	\$ 2,830,000

FUTURE TOTAL

OPERATIONAL IMPACT/OTHER

Operating Budget Impact

PRIOR TOTAL

	2023	2024	2025	2026	2027	TOTAL
Salaries & Fringes						-
Professional Services						-
Supplies/Materials						-
Depreciation						-
Other (Insurance, Utilities)						-
Principal & Interest						-
	\$ -	\$ -	\$ -	\$ -	\$ -	\$ -

FUTURE TOTAL

**WOOD COUNTY
CAPITAL IMPROVEMENT PLAN
2023-2027**

#1	Department #	Year	Project #	
PROJECT #	16	-26	-003	16-26-003
PROJECT NAME:	Two (2) Patrol Trucks			
START DATE:	1/1/2026			
END DATE:	12/31/2026			

TOTAL PROJECT COSTS: \$ 500,000

#2	DEPARTMENT	16	Highway
	CONTACT PERSON	Roland Hawk	
	TYPE	Equipment-Moveable	
	USEFUL LIFE	5 - 10	
	CATEGORY	Major Equipment	
	PRIORITY	Necessary	

PROJECT DESCRIPTION:

Two (2) Patrol Trucks

PROJECT ALTERNATIVES:

None

RELATIONSHIP TO OTHER PROJECTS:

PROJECT JUSTIFICATION Priority from Above **Necessary**

Replacement of equipment

Expenditure Schedule

PRIOR TOTAL

	2023	2024	2025	2026	2027	TOTAL
Planning/Design						-
Land Improvement						-
Construction/Maintenance						-
Equip/Vehicles/Furniture				500,000		500,000
Other						-
	\$ -	\$ -	\$ -	\$ 500,000	\$ -	\$ 500,000

FUTURE TOTAL

Funding Sources

PRIOR TOTAL

	2023	2024	2025	2026	2027	TOTAL
Tax Levy						-
Debt						-
State/Federal Grant						-
Departmental Rent						-
User Fees				500,000		500,000
Donations & Contributions						-
Other						-
	\$ -	\$ -	\$ -	\$ 500,000	\$ -	\$ 500,000

FUTURE TOTAL

OPERATIONAL IMPACT/OTHER

Maintenance expenses may decrease.

Operating Budget Impact

PRIOR TOTAL

	2023	2024	2025	2026	2027	TOTAL
Salaries & Fringes						-
Professional Services						-
Supplies/Materials						-
Depreciation						-
Other (Insurance, Utilities)						-
Principal & Interest						-
	\$ -	\$ -	\$ -	\$ -	\$ -	\$ -

FUTURE TOTAL

**WOOD COUNTY
CAPITAL IMPROVEMENT PLAN
2023-2027**

#1	Department #	Year	Project #	
PROJECT #	16	-26	-004	16-26-004
PROJECT NAME:	Two Quad Axle Trucks			
START DATE:	1/1/2026			
END DATE:	12/31/2026			

TOTAL PROJECT COSTS: \$ -

#2	DEPARTMENT	16	Highway
	CONTACT PERSON	Roland Hawk	
	TYPE	Equipment-Moveable	
	USEFUL LIFE	5 - 10	
	CATEGORY	Major Equipment	
	PRIORITY	Necessary	

PROJECT DESCRIPTION:

Two Quad Axle Trucks

PROJECT ALTERNATIVES:

None

RELATIONSHIP TO OTHER PROJECTS:

PROJECT JUSTIFICATION Priority from Above **Necessary**

Replacement of equipment

Expenditure Schedule

PRIOR TOTAL

	2023	2024	2025	2026	2027	TOTAL
Planning/Design						-
Land Improvement						-
Construction/Maintenance						-
Equip/Vehicles/Furniture						-
Other						-
	\$ -	\$ -	\$ -	\$ -	\$ -	\$ -

FUTURE TOTAL

Funding Sources

PRIOR TOTAL

	2023	2024	2025	2026	2027	TOTAL
Tax Levy						-
Debt						-
State/Federal Grant						-
Departmental Rent						-
User Fees						-
Donations & Contributions						-
Other						-
	\$ -	\$ -	\$ -	\$ -	\$ -	\$ -

FUTURE TOTAL

OPERATIONAL IMPACT/OTHER

Maintenance expenses may decrease.

Operating Budget Impact

PRIOR TOTAL

	2023	2024	2025	2026	2027	TOTAL
Salaries & Fringes						-
Professional Services						-
Supplies/Materials						-
Depreciation						-
Other (Insurance, Utilities)						-
Principal & Interest						-
	\$ -	\$ -	\$ -	\$ -	\$ -	\$ -

FUTURE TOTAL

**WOOD COUNTY
CAPITAL IMPROVEMENT PLAN
2023-2027**

#1	Department #	Year	Project #	
PROJECT #	16	-27	-001	16-27-001
PROJECT NAME:	Bridge Replacement			
START DATE:	1/1/2027			
END DATE:	12/31/2027			

TOTAL PROJECT COSTS: \$ 450,000

#2	DEPARTMENT	16	Highway
	CONTACT PERSON	Roland Hawk	
	TYPE	Other	
	USEFUL LIFE	Beyond 20	
	CATEGORY	Other	
	PRIORITY	Necessary	

PROJECT DESCRIPTION:

Bridge Replacement

PROJECT ALTERNATIVES:

None

RELATIONSHIP TO OTHER PROJECTS:

PROJECT JUSTIFICATION Priority from Above **Necessary**

Replacement of worn driving surfaces

Expenditure Schedule

PRIOR TOTAL

	2023	2024	2025	2026	2027	TOTAL
Planning/Design						-
Land Improvement						-
Construction/Maintenance						-
Equip/Vehicles/Furniture						-
Other					450,000	450,000
	\$ -	\$ -	\$ -	\$ -	\$ 450,000	\$ 450,000

FUTURE TOTAL

Funding Sources

PRIOR TOTAL

	2023	2024	2025	2026	2027	TOTAL
Tax Levy						-
Debt					450,000	450,000
State/Federal Grant						-
Departmental Rent						-
User Fees						-
Donations & Contributions						-
Other						-
	\$ -	\$ -	\$ -	\$ -	\$ 450,000	\$ 450,000

FUTURE TOTAL

OPERATIONAL IMPACT/OTHER

Operating Budget Impact

PRIOR TOTAL

	2023	2024	2025	2026	2027	TOTAL
Salaries & Fringes						-
Professional Services						-
Supplies/Materials						-
Depreciation						-
Other (Insurance, Utilities)						-
Principal & Interest						-
	\$ -	\$ -	\$ -	\$ -	\$ -	\$ -

FUTURE TOTAL

**WOOD COUNTY
CAPITAL IMPROVEMENT PLAN
2023-2027**

#1	Department #	Year	Project #	
PROJECT #	16	-27	-002	16-27-002
PROJECT NAME:	Bridge Epoxy			
START DATE:	1/1/2027			
END DATE:	12/31/2027			

TOTAL PROJECT COSTS: \$ 100,000

#2	DEPARTMENT	16	Highway
	CONTACT PERSON	Roland Hawk	
	TYPE	Other	
	USEFUL LIFE	Beyond 20	
	CATEGORY	Other	
	PRIORITY	Necessary	

PROJECT DESCRIPTION:

Bridge epoxy overlay

PROJECT ALTERNATIVES:

None

RELATIONSHIP TO OTHER PROJECTS:

PROJECT JUSTIFICATION Priority from Above **Necessary**

Protect bridge structures

Expenditure Schedule

PRIOR TOTAL

	2023	2024	2025	2026	2027	TOTAL
Planning/Design						-
Land Improvement						-
Construction/Maintenance						-
Equip/Vehicles/Furniture						-
Other					100,000	100,000
	\$ -	\$ -	\$ -	\$ -	\$ 100,000	\$ 100,000

FUTURE TOTAL

Funding Sources

PRIOR TOTAL

	2023	2024	2025	2026	2027	TOTAL
Tax Levy						-
Debt					100,000	100,000
State/Federal Grant						-
Departmental Rent						-
User Fees						-
Donations & Contributions						-
Other						-
	\$ -	\$ -	\$ -	\$ -	\$ 100,000	\$ 100,000

FUTURE TOTAL

OPERATIONAL IMPACT/OTHER

Operating Budget Impact

PRIOR TOTAL

	2023	2024	2025	2026	2027	TOTAL
Salaries & Fringes						-
Professional Services						-
Supplies/Materials						-
Depreciation						-
Other (Insurance, Utilities)						-
Principal & Interest						-
	\$ -	\$ -	\$ -	\$ -	\$ -	\$ -

FUTURE TOTAL

**WOOD COUNTY
CAPITAL IMPROVEMENT PLAN
2023-2027**

#1	Department #	Year	Project #	
PROJECT #	16	-27	-003	16-27-003
PROJECT NAME:	Bituminous Overlay/Construction			
START DATE:	1/1/2027			
END DATE:	12/31/2027			

TOTAL PROJECT COSTS: \$ 2,295,000

#2	DEPARTMENT	16	Highway
	CONTACT PERSON	Roland Hawk	
	TYPE	Other	
	USEFUL LIFE	Beyond 20	
	CATEGORY	Other	
	PRIORITY	Necessary	

PROJECT DESCRIPTION:

Bituminous Overlay/Construction

PROJECT ALTERNATIVES:

None

RELATIONSHIP TO OTHER PROJECTS:

PROJECT JUSTIFICATION Priority from Above Necessary

Replacement of worn driving surfaces

Expenditure Schedule

PRIOR TOTAL

	2023	2024	2025	2026	2027	TOTAL
Planning/Design						-
Land Improvement						-
Construction/Maintenance						-
Equip/Vehicles/Furniture						-
Other					2,295,000	2,295,000
	\$ -	\$ -	\$ -	\$ -	\$ 2,295,000	\$ 2,295,000

FUTURE TOTAL

Funding Sources

PRIOR TOTAL

	2023	2024	2025	2026	2027	TOTAL
Tax Levy						-
Debt					2,295,000	2,295,000
State/Federal Grant						-
Departmental Rent						-
User Fees						-
Donations & Contributions						-
Other						-
	\$ -	\$ -	\$ -	\$ -	\$ 2,295,000	\$ 2,295,000

FUTURE TOTAL

OPERATIONAL IMPACT/OTHER

Operating Budget Impact

PRIOR TOTAL

	2023	2024	2025	2026	2027	TOTAL
Salaries & Fringes						-
Professional Services						-
Supplies/Materials						-
Depreciation						-
Other (Insurance, Utilities)						-
Principal & Interest						-
	\$ -	\$ -	\$ -	\$ -	\$ -	\$ -

FUTURE TOTAL

**WOOD COUNTY
CAPITAL IMPROVEMENT PLAN
2023-2027**

#1	Department #	Year	Project #	
PROJECT #	16	-27	-004	16-27-004
PROJECT NAME:	One (1) Patrol Truck			
START DATE:	1/1/2027			
END DATE:	12/31/2027			

TOTAL PROJECT COSTS: \$ 275,000

#2	DEPARTMENT	16	Highway
	CONTACT PERSON	Roland Hawk	
	TYPE	Equipment-Moveable	
	USEFUL LIFE	5 - 10	
	CATEGORY	Major Equipment	
	PRIORITY	Necessary	

PROJECT DESCRIPTION:

One (1) Patrol Truck

PROJECT ALTERNATIVES:

None

RELATIONSHIP TO OTHER PROJECTS:

PROJECT JUSTIFICATION Priority from Above Necessary

Replacement of equipment

Expenditure Schedule

PRIOR TOTAL

	2023	2024	2025	2026	2027	TOTAL
Planning/Design						-
Land Improvement						-
Construction/Maintenance						-
Equip/Vehicles/Furniture					275,000	275,000
Other						-
	\$ -	\$ -	\$ -	\$ -	\$ 275,000	\$ 275,000

FUTURE TOTAL

Funding Sources

PRIOR TOTAL

	2023	2024	2025	2026	2027	TOTAL
Tax Levy						-
Debt						-
State/Federal Grant						-
Departmental Rent						-
User Fees					275,000	275,000
Donations & Contributions						-
Other						-
	\$ -	\$ -	\$ -	\$ -	\$ 275,000	\$ 275,000

FUTURE TOTAL

OPERATIONAL IMPACT/OTHER

Maintenance expenses may decrease

Operating Budget Impact

PRIOR TOTAL

	2023	2024	2025	2026	2027	TOTAL
Salaries & Fringes						-
Professional Services						-
Supplies/Materials						-
Depreciation						-
Other (Insurance, Utilities)						-
Principal & Interest						-
	\$ -	\$ -	\$ -	\$ -	\$ -	\$ -

FUTURE TOTAL

**WOOD COUNTY
CAPITAL IMPROVEMENT PLAN
2023-2027**

#1	Department #	Year	Project #	
PROJECT #	16	-27	-005	16-27-005
PROJECT NAME:	End Loader			
START DATE:	1/1/2027			
END DATE:	12/31/2027			

TOTAL PROJECT COSTS: \$ 250,000

#2	DEPARTMENT	16	Highway
	CONTACT PERSON	Roland Hawk	
	TYPE	Equipment-Moveable	
	USEFUL LIFE	5 - 10	
	CATEGORY	Major Equipment	
	PRIORITY	Necessary	

PROJECT DESCRIPTION:

End Loader

PROJECT ALTERNATIVES:

None

RELATIONSHIP TO OTHER PROJECTS:

PROJECT JUSTIFICATION Priority from Above Necessary

Replacement of equipment

Expenditure Schedule

PRIOR TOTAL

	2023	2024	2025	2026	2027	TOTAL
Planning/Design						-
Land Improvement						-
Construction/Maintenance						-
Equip/Vehicles/Furniture					250,000	250,000
Other						-
	\$ -	\$ -	\$ -	\$ -	\$ 250,000	\$ 250,000

FUTURE TOTAL

Funding Sources

PRIOR TOTAL

	2023	2024	2025	2026	2027	TOTAL
Tax Levy						-
Debt						-
State/Federal Grant						-
Departmental Rent						-
User Fees					250,000	250,000
Donations & Contributions						-
Other						-
	\$ -	\$ -	\$ -	\$ -	\$ 250,000	\$ 250,000

FUTURE TOTAL

OPERATIONAL IMPACT/OTHER

Maintenance expenses may decrease

Operating Budget Impact

PRIOR TOTAL

	2023	2024	2025	2026	2027	TOTAL
Salaries & Fringes						-
Professional Services						-
Supplies/Materials						-
Depreciation						-
Other (Insurance, Utilities)						-
Principal & Interest						-
	\$ -	\$ -	\$ -	\$ -	\$ -	\$ -

FUTURE TOTAL

**WOOD COUNTY
CAPITAL IMPROVEMENT PLAN
2023-2027**

#1	Department #	Year	Project #	
PROJECT #	16	-27	-006	16-27-006
PROJECT NAME:	Tractor/Mower			
START DATE:	1/1/2027			
END DATE:	12/31/2027			

TOTAL PROJECT COSTS: \$ 300,000

#2	DEPARTMENT	16	Highway
	CONTACT PERSON	Roland Hawk	
	TYPE	Equipment-Moveable	
	USEFUL LIFE	5 - 10	
	CATEGORY	Major Equipment	
	PRIORITY	Necessary	

PROJECT DESCRIPTION:

Tractor/Mower

PROJECT ALTERNATIVES:

None

RELATIONSHIP TO OTHER PROJECTS:

PROJECT JUSTIFICATION Priority from Above Necessary

Replacement of Equipment

Expenditure Schedule

PRIOR TOTAL

	2023	2024	2025	2026	2027	TOTAL
Planning/Design						-
Land Improvement						-
Construction/Maintenance						-
Equip/Vehicles/Furniture					300,000	300,000
Other						-
	\$ -	\$ -	\$ -	\$ -	\$ 300,000	\$ 300,000

FUTURE TOTAL

Funding Sources

PRIOR TOTAL

	2023	2024	2025	2026	2027	TOTAL
Tax Levy						-
Debt						-
State/Federal Grant						-
Departmental Rent						-
User Fees					300,000	300,000
Donations & Contributions						-
Other						-
	\$ -	\$ -	\$ -	\$ -	\$ 300,000	\$ 300,000

FUTURE TOTAL

OPERATIONAL IMPACT/OTHER

Maintenance expenses may decrease

Operating Budget Impact

PRIOR TOTAL

	2023	2024	2025	2026	2027	TOTAL
Salaries & Fringes						-
Professional Services						-
Supplies/Materials						-
Depreciation						-
Other (Insurance, Utilities)						-
Principal & Interest						-
	\$ -	\$ -	\$ -	\$ -	\$ -	\$ -

FUTURE TOTAL

WOOD COUNTY
PRIOR CAPITAL IMPROVEMENT PLAN COMPLETION REPORT
For the Year Ended 2020

#1	PROJECT #	16	-21	-001	16-21-001
	PROJECT NAME:	Bituminous Overlays/Construction			
	START DATE:	1/1/2021			
	END DATE:	12/31/2021			

#2	DEPARTMENT	16	Highway
	CONTACT PERSON	Roland Hawk	
	TYPE	Other	
	USEFUL LIFE	Beyond 20	
	CATEGORY	Other	
	PRIORITY	Necessary	

PROJECT COMPLETED? ☒ Yes ☐ If no please provide a reason this was not completed

#3	
----	--

#4	Expenditure Schedule		
	Estimated Cost	Actual Cost	Difference
Planning/Design			-
Land Acquisition			-
Construction/Maintenance			-
Equip/Vehicles/Furniture			-
Other	2,975,000	\$ 2,635,456	339,544
	<u>\$ 2,975,000</u>	<u>\$ 2,635,456</u>	<u>\$ 339,544</u>

#5	Funding Sources		
	Estimated Cost	Actual Cost	Difference
Tax Levy	-	-	-
Debt	2,000,000	1,945,269	54,731
State/Federal Grant	975,000	218,258	756,742
User Fees			-
Other		471,928	(471,928)
	<u>\$ 2,975,000</u>	<u>\$ 2,635,455</u>	<u>\$ 339,545</u>

WOOD COUNTY
PRIOR CAPITAL IMPROVEMENT PLAN COMPLETION REPORT
For the Year Ended 2020

#1	PROJECT #	16	-21	-002	16-21-002
	PROJECT NAME:	Marshfield Salt Shed			
	START DATE:	1/1/2021			
	END DATE:	12/31/2021			

#2	DEPARTMENT	16	Highway
	CONTACT PERSON	Roland Hawk	
	TYPE	Other	
	USEFUL LIFE	5 - 10	
	CATEGORY	Major Equipment	
	PRIORITY	Necessary	

PROJECT COMPLETED? ☒ Yes ☐ If no please provide a reason this was not completed

#3	
----	--

#4	Expenditure Schedule			
	Estimated Cost	Actual Cost	Difference	
Planning/Design			-	
Land Acquisition			-	
Construction/Maintenance			-	
Equip/Vehicles/Furniture			-	
Other	700,000	429,731	270,269	
	<u>\$ 700,000</u>	<u>\$ 429,731</u>	<u>\$</u>	<u>270,269</u>

#5	Funding Sources			
	Estimated Cost	Actual Cost	Difference	
Tax Levy			-	
Debt	350,000	429,731	(79,731)	
State/Federal Grant			-	
User Fees			-	
Other	350,000		350,000	
	<u>\$ 700,000</u>	<u>\$ 429,731</u>	<u>\$</u>	<u>270,269</u>

WOOD COUNTY
PRIOR CAPITAL IMPROVEMENT PLAN COMPLETION REPORT
For the Year Ended 2020

#1	PROJECT #	16	-21	-003	16-21-003
	PROJECT NAME:	Paving Roller (Small)			
	START DATE:	1/1/2021			
	END DATE:	12/31/2021			

#2	DEPARTMENT	16	Highway
	CONTACT PERSON	Roland Hawk	
	TYPE	Equipment-Moveable	
	USEFUL LIFE	5 - 10	
	CATEGORY	Major Equipment	
	PRIORITY	Necessary	

PROJECT COMPLETED? If no please provide a reason this was not completed

#3	Management Decision
-----------	---------------------

	Expenditure Schedule		
	Estimated Cost	Actual Cost	Difference
Planning/Design			-
Land Acquisition			-
Construction/Maintenance			-
Equip/Vehicles/Furniture	80,000		80,000
Other			-
	<u>\$ 80,000</u>	<u>\$ -</u>	<u>\$ 80,000</u>

	Funding Sources		
	Estimated Cost	Actual Cost	Difference
Tax Levy			-
Debt			-
State/Federal Grant			-
User Fees	80,000		80,000
Other			-
	<u>\$ 80,000</u>	<u>\$ -</u>	<u>\$ 80,000</u>

WOOD COUNTY
PRIOR CAPITAL IMPROVEMENT PLAN COMPLETION REPORT
For the Year Ended 2020

#1	PROJECT #	16	-21	-004	16-21-004
	PROJECT NAME:	Two (2) Patrol Trucks			
	START DATE:	1/1/2021			
	END DATE:	12/31/2021			

#2	DEPARTMENT	16	Highway
	CONTACT PERSON	Roland Hawk	
	TYPE	Equipment-Moveable	
	USEFUL LIFE	5 - 10	
	CATEGORY	Major Equipment	
	PRIORITY	Necessary	

PROJECT COMPLETED? ☒ Yes ☐ If no please provide a reason this was not completed

#3	
----	--

#4	Expenditure Schedule		
	Estimated Cost	Actual Cost	Difference
Planning/Design			-
Land Acquisition			-
Construction/Maintenance			-
Equip/Vehicles/Furniture	500,000	260,511	239,489
Other			-
	<u>\$ 500,000</u>	<u>\$ 260,511</u>	<u>\$ 239,489</u>

#5	Funding Sources		
	Estimated Cost	Actual Cost	Difference
Tax Levy			-
Debt			-
State/Federal Grant			-
User Fees	500,000	260,511	239,489
Other			-
	<u>\$ 500,000</u>	<u>\$ 260,511</u>	<u>\$ 239,489</u>

WOOD COUNTY
PRIOR CAPITAL IMPROVEMENT PLAN COMPLETION REPORT
For the Year Ended 2020

#1	PROJECT #	16	-21	-005	16-21-005
	PROJECT NAME:	Small Loader			
	START DATE:	1/1/2021			
	END DATE:	12/31/2021			

#2	DEPARTMENT	16	Highway
	CONTACT PERSON	Roland Hawk	
	TYPE	Equipment-Moveable	
	USEFUL LIFE	5 - 10	
	CATEGORY	Major Equipment	
	PRIORITY	Necessary	

PROJECT COMPLETED? If no please provide a reason this was not completed

#3		
	Management Decision	

#4	Expenditure Schedule		
	Estimated Cost	Actual Cost	Difference
Planning/Design			-
Land Acquisition			-
Construction/Maintenance			-
Equip/Vehicles/Furniture	150,000		150,000
Other			-
	<u>\$ 150,000</u>	<u>\$ -</u>	<u>\$ 150,000</u>

#5	Funding Sources		
	Estimated Cost	Actual Cost	Difference
Tax Levy			-
Debt			-
State/Federal Grant			-
User Fees	150,000		150,000
Other			-
	<u>\$ 150,000</u>	<u>\$ -</u>	<u>\$ 150,000</u>

WOOD COUNTY
PRIOR CAPITAL IMPROVEMENT PLAN COMPLETION REPORT
For the Year Ended 2020

#1	PROJECT #	16	-21	-006	16-21-006
	PROJECT NAME:	Grader			
	START DATE:	1/1/2021			
	END DATE:	12/31/2021			

#2	DEPARTMENT	16	Highway
	CONTACT PERSON	Roland Hawk	
	TYPE	Equipment-Moveable	
	USEFUL LIFE	5 - 10	
	CATEGORY	Major Equipment	
	PRIORITY	Necessary	

PROJECT COMPLETED? If no please provide a reason this was not completed

#3	Management Decision
----	---------------------

#4	Expenditure Schedule		
	Estimated Cost	Actual Cost	Difference
Planning/Design			-
Land Acquisition			-
Construction/Maintenance			-
Equip/Vehicles/Furniture	200,000	-	200,000
Other			-
	<u>\$ 200,000</u>	<u>\$ -</u>	<u>\$ 200,000</u>

#5	Funding Sources		
	Estimated Cost	Actual Cost	Difference
Tax Levy			-
Debt			-
State/Federal Grant			-
User Fees	200,000	-	200,000
Other			-
	<u>\$ 200,000</u>	<u>\$ -</u>	<u>\$ 200,000</u>

WOOD COUNTY
PRIOR CAPITAL IMPROVEMENT PLAN COMPLETION REPORT
For the Year Ended 2020

#1	PROJECT #	16	21	-007	1621-007
	PROJECT NAME:	Rubber Tar Pot			
	START DATE:	1/1/2021			
	END DATE:	12/31/2021			

#2	DEPARTMENT	16	Highway
	CONTACT PERSON	Roland Hawk	
	TYPE	Equipment-Moveable	
	USEFUL LIFE	5 - 10	
	CATEGORY	Major Equipment	
	PRIORITY	Necessary	

PROJECT COMPLETED? If no please provide a reason this was not completed

#3			
	Management Decision		

#4	Expenditure Schedule		
	Estimated Cost	Actual Cost	Difference
Planning/Design			-
Land Acquisition			-
Construction/Maintenance			-
Equip/Vehicles/Furniture	75,000		75,000
Other			-
	<u>\$ 75,000</u>	<u>\$ -</u>	<u>\$ 75,000</u>

#5	Funding Sources		
	Estimated Cost	Actual Cost	Difference
Tax Levy			-
Debt			-
State/Federal Grant			-
User Fees	75,000		75,000
Other			-
	<u>\$ 75,000</u>	<u>\$ -</u>	<u>\$ 75,000</u>

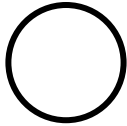

RESOLUTION#

Introduced by Highway Infrastructure and Recreation Committee
Page 1 of 2

ITEM# 6-
DATE April 19, 2022
Effective Date April 19, 2022

Motion:

Adopted:

1st

Lost:

2nd

Tabled:

No:

Yes:

Absent:

Number of votes required:

X

 Majority

Two-thirds

Reviewed by:

PAK

, Corp Counsel

Reviewed by:

, Finance Dir.

LAD

INTENT & SYNOPSIS: To verify the intention of Wood County to transfer jurisdiction of a portion of CTH U to the Village of Biron. This resolution does not authorize the expenditure of funds to improve roads, rather it explains what has happened and is proposed to happen in relation to those roads and the ultimate intent of the County to transfer portions of those roads to the Village of Biron.

FISCAL NOTE: This is not a funding resolution but there will be financial consequences to the jurisdictional transfer. These would include a possible loss of state road aids and the commensurate transfer of responsibility to maintain those sections of road.

WHEREAS, the County has reconstructed a portion of CTH U (Segment 1 as shown on attached map) and intends to reconstruct additional portions of CTH U between STH 54, Eagle Road intersection and STH 54, 80th Street intersection (as labeled Segment 2, 3A, & 4 on the attached map). In addition, a portion (labeled Segment 3B on the attached map) has already been reconstructed as part of the Bridge Water Development, and

WHEREAS, Wood County has submitted a STP-Urban Grant to WisDOT for funds to reconstruct Segment 2. The intent is to replace pavement, curb & gutter, storm sewer, and sidewalk from the north end of Segment 1 to Fox Street. The plan is to include on-street bike accommodations with the project. Wood County will pay the matching 20% funds to the WisDOT for construction costs and pay 100% of engineering costs, and

WHEREAS, Wood County in good faith has worked with the Village of Biron to develop a preliminary design for Segment 3A. The design includes a 10-foot multiuse trail separated from CTH U roadway by a cable guard system. The roadway would be reconstructed to include 11-foot lanes, 2-foot shoulders, a 5-foot buffer would be installed between the edge of the multiuse trail and the top of bank (top of riprap) along the riverbank. The County intends to apply for a STP-Urban Grant under the Bi-partisan Infrastructure Law (BIL) for 80% of the construction costs. The County is requesting the Village of Biron to match 5% of the County’s construction cost, split R/W costs 50/50 as well as utility relocation costs at 50/50. Wood County will pay for the engineering costs, and

WHEREAS, Wood County intends to reconstruct Segment 4 between N. Biron Drive and STH 54 with County funds as part of the Highway Department’s 5-year plan, and

WHEREAS, upon completion of reconstruction of Segments 2, 3, and 4, the Village agrees to accept jurisdiction of CTH U from South Biron Drive easterly along the river to 80th Street and south to the intersection of STH 54 which includes Segments 2, 3A & 3B, and 4. If Wood County is not successful in obtaining a STP-Urban Grant for Segment 2 & 3A, the County and the Village will consider other options that are affordable to both parties that may still achieve the purpose of transferring CTH U to the village.

{ }

JAKE HAHN (Chair)

AL BREU

JOHN HOKAMP

DAVE LAFONTAINE

LEE THAO

Adopted by the County Board of Wood County, this day of 20 .

County Clerk

County Board Chairman

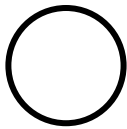

RESOLUTION#

Introduced by Highway Infrastructure and Recreation Committee
Page 2 of 2

NOW, THEREFORE, THE WOOD COUNTY BOARD OF SUPERVISORS HEREBY RESOLVES to authorize the Wood County Highway Commissioner to execute the necessary documents to transfer to the Village of Biron jurisdiction of CTH U from South Biron Drive easterly along the river to 80th Street and south to the intersection of STH 54 which includes Segments 2, 3A & 3B, and 4. However, if the County is not successful in obtaining a STP-Urban Grant for Segment 2 or 3A of the CTH U project, as set forth above and on the attachment, the Highway Commissioner and the Village will consider other options that are affordable to both parties that may still achieve the purpose of transferring CTH U to the Village.

{ }

Adopted by the County Board of Wood County, this day of 20 .

County Clerk

County Board Chairman

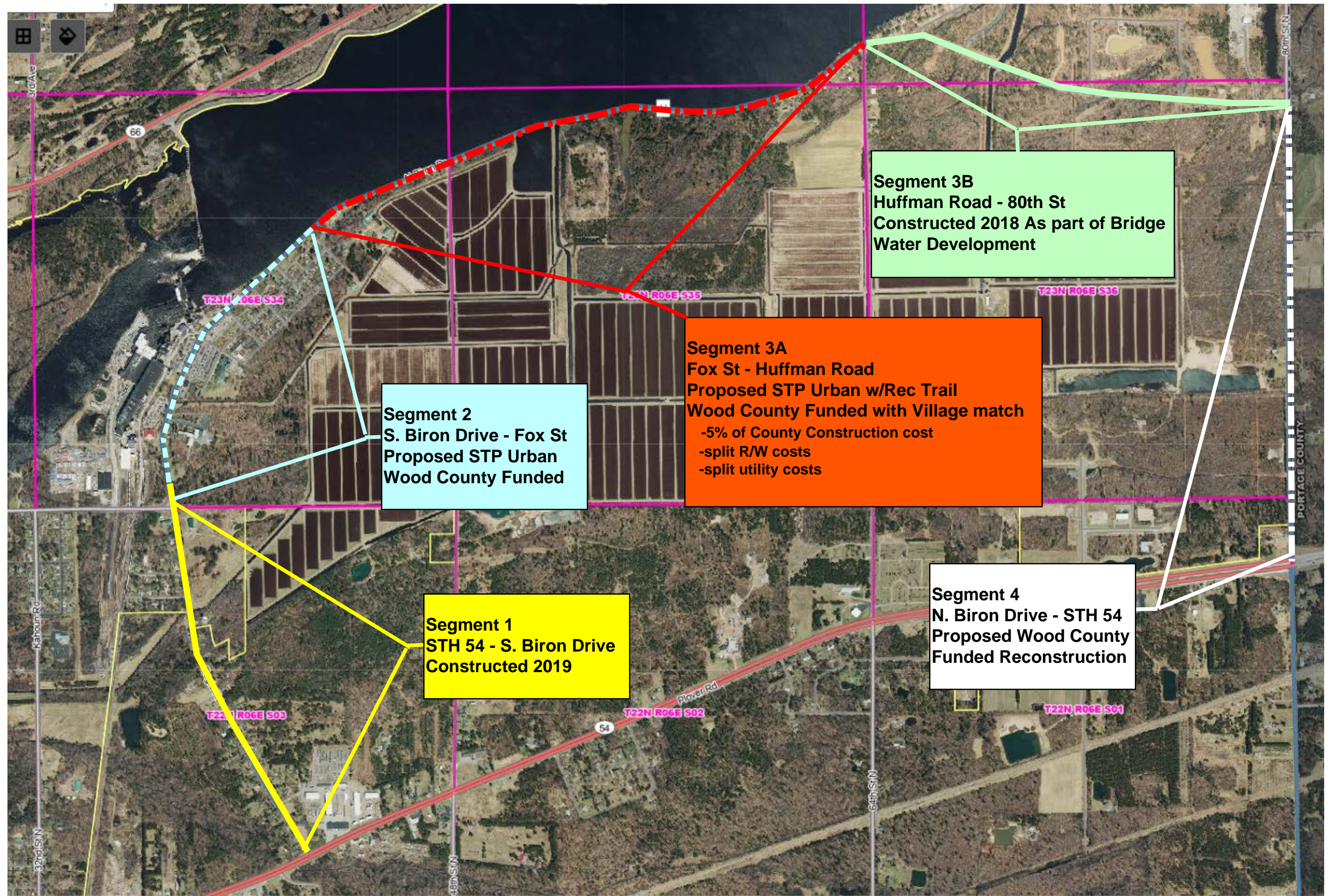



Parks & Forestry Department Reports

April 7, 2022

Director Report, by Chad Schooley

- Powers Bluff offroad bike trail construction bids were due on March 14th. We received 1 bid for the project, from a very reputable contractor in the offroad bike construction profession. I put information submitted by the company, Rock Solid, in the packet. I will bring the bid tally sheet to the meeting for review and possible acceptance. We did not bid out the completion of the gravel surfaced multi-use trail at this time. I will bring cost estimates for this trail to the meeting.
- I am working with ARC Central Inc. on cost estimates for the construction of a new shop at Powers Bluff. The shop design is based off of the Dexter shop, which was designed by ARC Central in 2016. The shop would be constructed on the new property off HWY N, and would allow for removal of the old shop adjacent to the communications tower.
- Completed updating Emergency Action Plans and Inspection, Operations, and Maintenance manuals for the South Park and Dexter Dams. Completed testing of the EAP's on Wednesday, March 30th.
- Moving forward with Rapids Control Systems, and IT, replacing the dam monitoring system at Dexter County Park. This project also includes replacing/updating outdated communications equipment, including moving the South Park and Dexter Park systems onto a new server. This project will result in a higher quality monitoring program, which will be more user friendly, reliable, and secure.
- Continue assisting with reservation system setup review.
- Assisting Emergency Management on grant application materials for the South Park storm shelter project.
- Working on 2023-2027 CIP. A draft summary copy is in the packet.
- Participated in initial interview for LTE II position with Maintenance Program Supervisor.
- Met with Patrick G., Northwoods Peddle and Paddle, for year-end meeting on Powers Bluff concessions. Unfortunately, NPP does not plan on returning for 2023 due to low concession sales the past 2 years. They would reconsider if Wood County would make the following changes: Limit/eliminate allowing carryins, and allow beer sales (HIRC approved for this season but Town of Arpin required reapplication for license which prohibited them from selling this season).
- Two of our long-term employees will be retiring over the next month. Ron Gilson, who has been an LTE, Ranger, Maintenance Worker, and currently the Construction Maintenance Worker, will be retiring on March 31st. Ron has been an FTE for 15 years. Scott Fox will be retiring on April 20th. Scott began as a seasonal maintenance worker, and has been an FTE for almost 42 years. Most of this time Scott has been serving as Lead Maintenance Worker for North Wood County Park and Powers Bluff County Park. Both individuals have been extremely dedicated in their positions, and have been involved in numerous improvement projects within our parks. Their knowledge and dedication will be missed! Wishing them a happy retirement!
- Special Use Permits
 - None at this time

Maintenance Program Supervisor Report, by Dan Vollert

Construction Projects

- Roofs for signs and bulletin boards being prebuilt at North Park. To be installed at any time.
- South Park pit toilet, south of dam, roof repair and interior upgrades.
- South Park Shop snow/ice guard for metal roof purchased and ready to install, weather permitting.
- Dexter Wood Shed's framework and roof is up and awaiting fencing and concrete embutments.
- Nepco Shelter Septic Tank replacement in preliminary planning stage with Advantage Plumbing.

Maintenance Operations

- Winter operations are done for the season.
- Dam monitoring and operation in full swing with snow and iceout. Emergency Action Plan (EAP) updating, training, and testing going on with Wazeecha and Dexter Dams.
- Most park areas are closed for the season. Picnic table repair and building maintenance ongoing.
- Cleaning up trees and debris in all parks. Blowing off roadways, camp pads and mulching operations ongoing.
- Barbed wire fencing between Powers Bluff's original area and new area of park removed.
- Starting to get some equipment into Hightway for Spring Checkups.
- Dexter Park is replacing old park signs with new signage from Rapids Sign.
- Dock installation on Wazeecha, NEPCO, and Dexter Park pending iceout.
- Tree removal and cleanup west of South Park White Beach parking lot. Working with adjacent landowner.

Employee Matters

- Continuing to learn my new role as Maintenance Program Supervisor-ATV/Snowmobile Trail Coordinator.
- New Dexter Park Maintenance Worker, Jeff Okonek on board at Dexter and training in progress.
- Started Process of LTE (Summer Help) Recruitment with HR, Wood County Webpage, Facebook, Area Schools, etc. Most positions are filled.
- Ronald Gilson-Maintenance Construction Worker, has announced his retirement on Friday, April 1st after 15 years. Reviewing job description for future position recruitment.
- Scott Fox-North Wood County Park Lead Worker, has also announced his retirement on Wednesday, April 20th, after almost 43 years. (New Employee Recruitment in Progress)

Snowmobile/ATV

- Attended the AWSC Snowmobile Meeting on March 7, 2022 at the Sherryland Ballroom.
- Little Hemlock bridge completed. (Hwy. bridge crew). Vesper Snow Drifters Club passed along their Thanks and are happy with project. Working on grant reimbursement.
- Hwy H bridge project is completed. (Hwy. bridge crew). Bakerville Sno Rovers. Working on grant reimbursement.
- Moving along with DQ Farms, Auburndale, and Rudolph-Plum Road snowmobile bridge projects-grant applications, permits, etc.
- All Snowmobile Trails are CLOSED in Wood County.

- Assisting in getting Snowmobile Club members hooked up to GTS/SNARS system. Also processing snowmobile club entries into system for reimbursement.

Office Supervisor Report, by Sandra Green

Office:

- I returned from FMLA on 2/15/22. Unfortunately, due to continues medical issues, I went on FMLA again on 3/23/2022. I am back to work half time this week and then full time next week working either from home or at office. Praying this is the last of it.
- We had a training session with Konect, our partner for the new reservation system.
- I attended the WI Governer's Conference on Tourism in mid-March. This is an annual conference, but first one since 2019 due to Covid. It was a great turn-out and I brought back a lot of good information. I will share it with everyone as soon as I am able.
- Continuing to assist with training for Dan Vollert, newly promoted Parks Maintenance Program Supervisor.
- Making great progress on the programming and set up of the camping/shelter/permit reservation system. We're hoping to launch sometime in April.
- Updated website, Travel Wisconsin, Facebook and Instagram with pertinent news.
- Working on the summer/winter brochure as well. Deadling is coming up soon.
- Preparing for year-end Audit notification from Finance prep.
- Scheduled Camp Ranger training session for the new Camping/Shelter reservation system.

Forestry:

- Weekly timber sale billing and processing of wood cutting permit revenues.

Forest Administrator Report, by Fritz Schubert

- Timber Sales: Currently 2 active timber sales: scaled wood, job site inspections, routine timber sale administration. 3 timber sales have gone inactive with wood sitting on landings due to road postings. These will become active and wood will be hauled once postings are lifted.
- Worked with Oakdale Electric Co-op to drop a section of powerline to enable safe tree harvest on contract #792, adjacent to Holst Road and associated power line.
- Worked with Oakdale Electric Co-op to accomplish tree clearing and wood delivery to Dexter Park shop in conjunction with a power line improvement/reroute project along HWY 54.
- Timber sale establishment, compartments 54 and 20.
- Forestry Technician: Has been remarking old timber sales, preforming forest reconnaissance, vehicle maintenance, completing assembly of new shooting benches, partial shooting range clean-up.



P0 Box 139
Copper Harbor MI, 49918

651.238.3292
jon@rocksolidtrails.com
RockSolidTrails.com

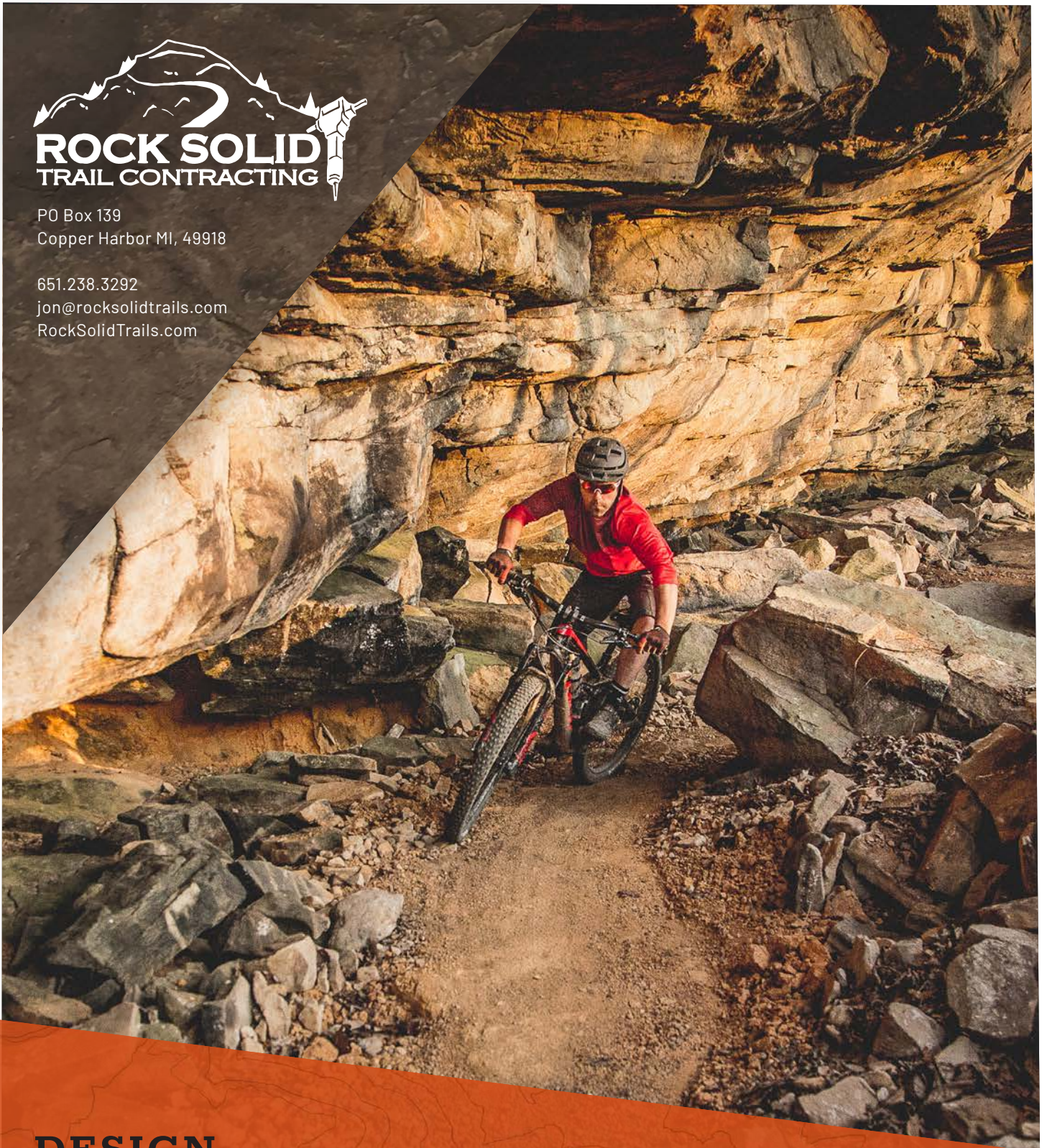

**DESIGN.
CONSTRUCTION.
CONSULTING.**

**POWERS BLUFF PARK TRAIL CONSTRUCTION
03.12.22**

**TO: WOOD COUNTY PARKS & FORESTRY
ATTN: CHAD SCHOOLEY**

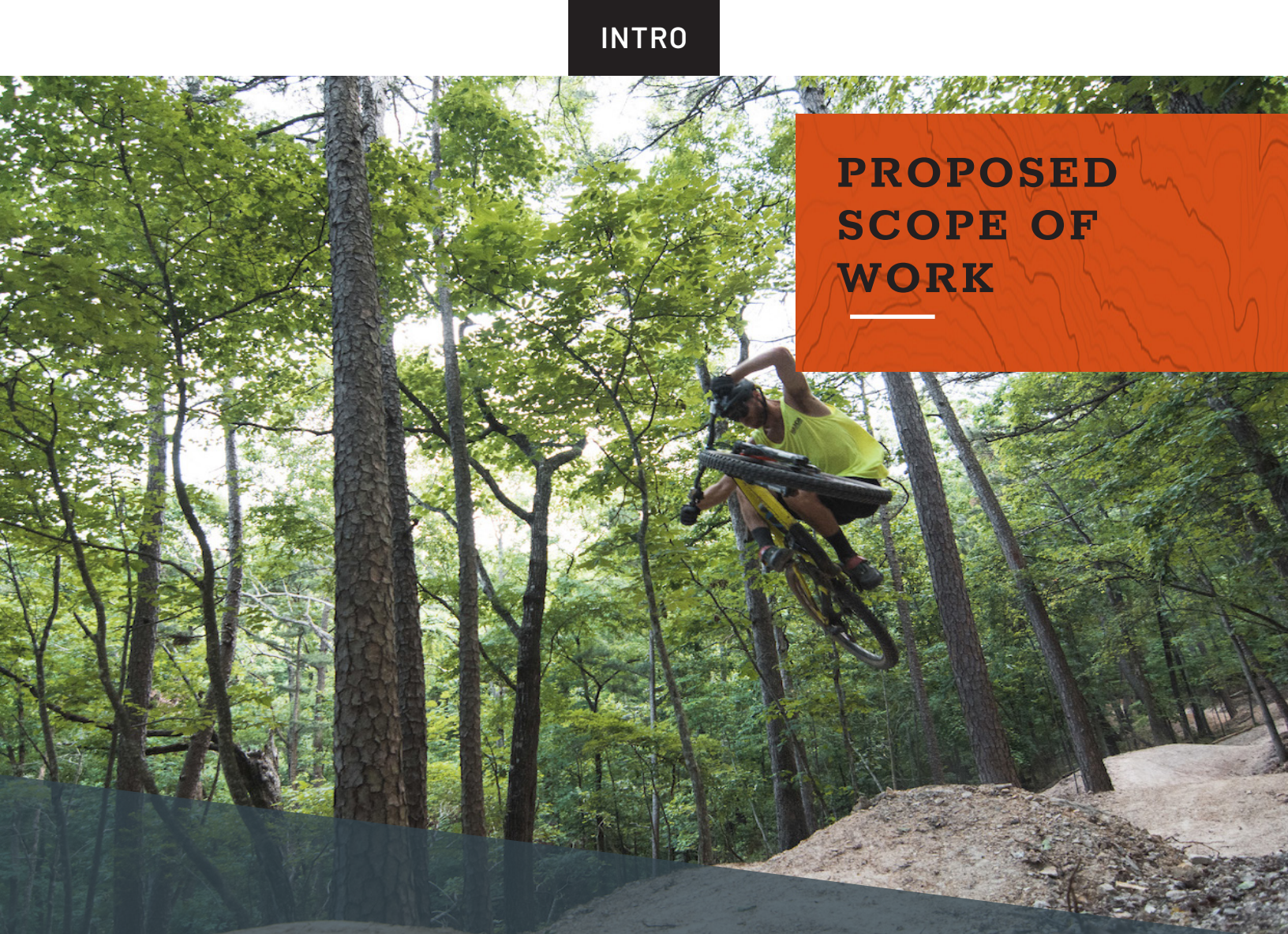
A full-page background image showing a mountain biker in a yellow shirt jumping over a dirt mound in a forest. The biker is in mid-air, with the bike tilted. The forest has many tall, thin trees with green foliage. In the top right corner, there is an orange rectangular overlay with the text 'PROPOSED SCOPE OF WORK' in white, bold, sans-serif font. The text is arranged in three lines: 'PROPOSED', 'SCOPE OF', and 'WORK'. A small white horizontal line is positioned below the word 'WORK'.

PROPOSED SCOPE OF WORK

Rock Solid Trail Contracting, LLC. is pleased to submit this proposal to the Wood County Parks and Forestry Department for trail construction at Powers Bluff County Park. Rock Solid has many employees with roots in central and north east Wisconsin who are eager to take part in a project building out the riding scene in their home state.

Based on guidance from Chad Schooley, information included in the RFP and our experience building in the region, Rock Solid prepared a list of builder identified features. In general, builder identified features would be constructed from dirt, rock or wood. If selected, Rock Solid will present a photographic and visual 'services menu' document to Wood County, which will depict the type, size and configuration of features appropriate for the project in more detail. This document can be used by Rock Solid and Wood County during flagging/design, to choose the locations, type and difficulty of features that will be included in the final scope/design. This approach will allow the builders some creative and professional license (rather than prescribing exact design specifications), to put their own touch on the final features, which is a critical component to a playful trail.

Rock Solid notes that rock armoring is required for many segments. Based on our experience in the region, the suitability of native rock may be limited for this purpose; it is typically round and often difficult/not possible to construct rideable and sustainable features from. Based on guidance from Wood County, Rock Solid will utilize on-site rocks to the greatest extent practicable, but provided a range of imported rock options in the event on-site rock is unsuitable. Rock Solid will charge for imported rock based on market price at the time of construction.



Proper planning is an early key to success when envisioning and developing a signature mountain bike trail destination. Rock Solid has built in time to account for flagging/design into the unit costs for construction of each segment. Prior to construction, Rock Solid will mobilize to the project area to conduct flagging and final design. Rock Solid will use this opportunity to identify final quantities and feature locations.

JUNE - JULY 2022

FLAGGING

Rock Solid envisions that flagging could occur in June and/or July of 2022. Flagging would be conducted by the jobsite foreman, Kyle McGurk, Jon Schubbe or Aaron Rogers. Rock Solid assumes the concept trails presented in this RFP are viable and the final configuration of the flag line will closely resemble to configuration of the mapped concept plan.

JULY - NOVEMBER, 2022

CONSTRUCTION & CREW CONFIGURATION

Rock Solid proposes mobilizing two crews of three to the project area. Each crew will consist of a foreman and mini-excavator operator and two handworkers. Rock Solid envisions that construction could begin in July, 2022 and take place into October or November 2022. Crews would remain onsite & working for the duration of construction.

Based on Rock Solid's Construction Cost Estimate Matrix, Rock Solid estimates the build would take approximately 135 total build days, before incorporating additional builder defined features into the scope. Rock Solid assumes some builder identified features will be added to the scope during the design phase, which would extend length of each crew would remain onsite. Rock Solid assumes additional scope items would still allow for completion of all construction in 2022. However, if the addition of builder defined features extends the build into 2023, Rock Solid would mobilize a crew (or two if necessary) as soon as spring 2023 conditions allow, to complete any remaining work items.

The Rock Solid team has a long roster of talented foreman. Many have roots in Wisconsin or the Upper Peninsula. The builders introduced here are a good representation of the qualifications and experience of all Rock Solid Foreman. Rock Solid may assign different, but similarly qualified employees, based on conditions and availability at the time of construction kickoff.



KYLE MCGURK, GREEN BAY

Foreman, Construction Project Manager

Kyle McGurk has been with Rock Solid since 2017. Kyle quickly demonstrated trail building aptitude and attention to detail; assets he has harnessed to become a trusted foreman on any project. He specializes in a wide range of trail building techniques which include stair building and rock work. Kyle has served as foreman on multiple high profile projects, including Mt Nebo (Russellville, AR), Grandad's Bluff (La Crosse, WI) and Cuyuna State Recreation Area (Ironton, MN).

More recently, Kyle has been serving as lead foreman on large projects where Rock Solid has multiple crews assigned to different tasks, where he has successfully run his own crew to build exceptional trail but also provide oversight and project management to other foreman and crews. Along with his dog ranger, Kyle is typically found on a cross county trail ripping a hardtail. Kyle hails from Green Bay, WI and earned double majors in Electrical Engineering and Computer Engineering from Michigan Technological University in 2016.



NILS HEMPLE, RHINELANDER

Foreman

Nils is one of Rock Solid's foundational employee's, with roots dating to 2014, where he served as a handworker constructing the Mission Creek System in Duluth, MN. His trail building aptitude was recognized as he has worked his way from handworker, to operator, to one of Rock Solid's top foreman. Nils has worked on flow trails, jump trails, XC trails, hand-built trails, and has thousands of square feet of technical rockwork under his belt.

In 2019, Nils served as foreman for the Upper Hixon trail system in La Crosse, Wisconsin, giving him firsthand experience working adjacent to the Grandad's Bluff project area. Most recently Nils was lead foreman on the for the Centennial Park trail system in Fayetteville Arkansas. This exciting 15 mile project includes trails ranging from beginner and intermediate flow, to advanced XC and XC courses which are slated to host world class race events. Nils primarily operates a Kubota U-27 excavator but is equally proficient with a Kubota U-17 excavator when a smaller machine is appropriate.

The Rock Solid team is dedicated to building unique trails that not only have garnered a reputation for being fun-packed, but also for standing the test of time.



ERIK WILLIAMS, GREEN BAY

Foreman

Erik 'E-Dubs' Williams is a Wisconsin native that developed a passion for bikes boards and anything that goes downhill at a young age. "Keep the rubber side down," he will remind you!

Erik began his trail building career in 2016 and joined Rock Solid in 2019. His leadership skills and trail building expertise were quickly recognized as he was promoted to Foreman in July of 2019. During his time with Rock Solid, Erik has assembled a wide range of successful projects in his portfolio, including Redhead, Tioga and Giant's Ridge in the Iron Range of Minnesota and in the Yawkee Unit of the Cuyuna Lakes State Recreation Area. He also played an important role in the build out of Centennial Park in Fayetteville, AR and also was selected to construct trails on a large private estate in the Ozarks. Proficiency in wood work is also among his skill set.

Erik oversaw the construction of an 800'x12' boardwalk at the Trek International Head Quarters in Waterloo, WI and constructed two 36' bridges during the Fall of 2020 in the Sagamore Unit of Cuyuna Lakes State Recreation Area.



JOE DYKSTRA, IRONWOOD

Foreman

Joe Dykstra began trail building began at an early age helping his dad cut and maintain hiking trails across his family's property. He and his friends discovered how much fun it was to ride their BMX bikes down deer paths, eventually swapping out his Haro for a Cannondale mountain bike, and began transforming the family forest into a singletrack MTB trail system.

Joe's construction experience includes building full-scribe log homes for a company in Wisconsin, concrete pouring, and working at a cross country ski resort. Working each of these places familiarized him with using heavy equipment to shape dirt and snow with a well-rounded knowledge of construction.

After a moment of clarity, he moved to Michigan's Upper Peninsula with the intention of building his own log home. Ultimately, it was the fulfillment of this dream that brought him into contact with Rock Solid back in 2018. Since joining the team in April 2018, Joe labored as a handworker and became an assistant foreman on a variety of projects. For the past two years he's been honing his building skills working as a foreman in Fayetteville, AR and Beaver Bay, MN.

While Joe's always appreciated smooth flow trail and getting his tires off the ground his favorite trails are chunky and fast. Think ripping Colorado singletrack, weaving in and out of trees.

All Rock Solid Hand Workers have demonstrated excellence in the use of hand tools and power tools to finish trail tread, in addition to applying them to advanced projects such as rock work, wall building and feature fabrication (see tools list).



KADEN DEGENHARDT

Build Crew

Hometown: Eau Claire, WI

Length of time with Rock Solid: 2+ Years

Key Projects: River Mountain / Two Rivers - Little Rock, AR.

Giants Ridge, Biwabik, MN.

Split Rock MTB Trails - Two Harbors, MN.

Fun Fact: Kaden originally was a motocross rider and transitioned to mountain biking.



TAYLOR MEETZ

Build Crew

Hometown: Oshkosh, WI

Length of time with Rock Solid: 2+Years

Key Projects: Monument Trails - Devils Den SP, Winslow AR.

Split Rock MTB Trails - Two Harbors, MN. (2020 & 2021)

Fun Fact: Taylor originally was a BMX rider and transitioned to mountain biking.

All Rock Solid Hand Workers have demonstrated excellence in the use of hand tools and power tools to finish trail tread, in addition to applying them to advanced projects such as rock work, wall building and feature fabrication (see tools list).



JADON SMITH

Second Operator, Build Crew

Length of time with Rock Solid: 3+ years

Hometown: Ceresco, MI

Key Projects: Keystone Trails - Bentonville, AR.

Split Rock MTB Trails - Two Harbors, MN.



JUSTIN STENHOWER

Build Crew

Length of time with Rock Solid: 2+ years

Hometown: Vestaburg, MI.

Key Projects: Cuyuna Lakes MTB Trails - Crosby, MN.

Devil's Den MTB Trails - Winslow, AR.



LOGAN JACISM

Build Crew

Length of time with Rock Solid: 2+ years

Hometown: Ironwood, MI

Key Projects: Giants Ridge MTB Trails - Biwabik, MN.

Centennial Park at Millsap - Fayetteville, AR.

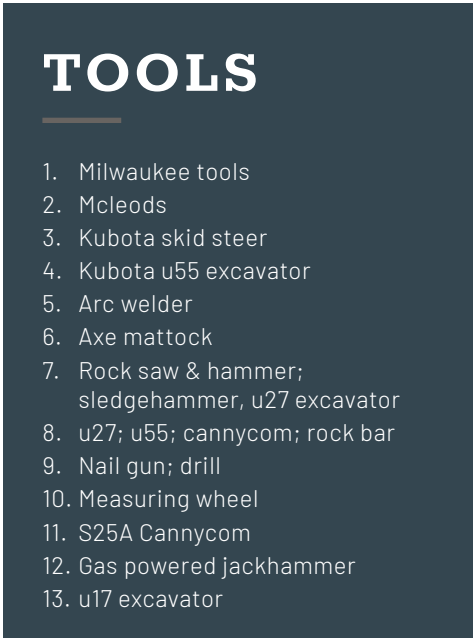
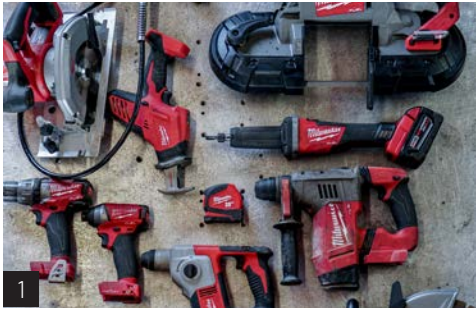

TOOLS

1. Custom cannycom; portable welder
2. Kubota
3. Impact drill
4. Rock hammers & chisel
5. Impact drilling
6. Pins & feathers
7. Grease gun
8. Compactor; teamwork
9. Articulating wheel loader
10. Hard hat
11. Brand spanking new u27
12. Goof balls with hand tools
13. Chip sealer
14. Mcleod; shovel; compactor; fuel

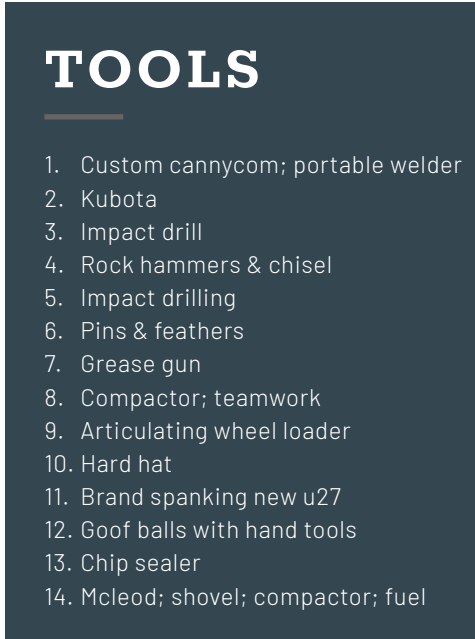

ABOVE & BEYOND

“

“Working with Rock Solid from start to finish is like working with excellence. Their staff’s knowledge and experience of the terrain and finding just the right spot to place a trail is incredible.”

“They don’t just build a trail, they bring the forest to life with what they find in the woods. A crooked tree that others would avoid, they make that a focal point. If the soil isn’t just right, they correct it for trail sustainability. Working with the owner to the builder to the office staff was nothing but ease.

They really know what they are doing and they really love what they do. That makes them the right choice always for building your trails.”

SARAH GURNEY, LITTLE TRAVERSE CONSERVANCY

“Rock Solid’s trail building knowledge and business acumen make them the best in the trail building business.”

“Their team analyzes on-the-ground data to achieve your goals as well as surprise and delight the coming trail users. The construction phase was seamless, which enabled them to keep accurate accounting records and proper timelines.

Our latest project with their team has been a roaring success. The trail system has greatly increased park attendance, which helped launch a NICA chapter with coaches along with a local trail non-profit. It has become a destination in the region and beyond.”

AMBER BROWN, TRAIL PROJECT
MANAGER, ARKANSAS PARKS &
RECREATION FOUNDATION

”



BEGINNER
Flow Trail



INTERMEDIATE
Jump Trail



INTERMEDIATE
Flow Trail



EXPERT
Jump Trail



EXPERT
Technical Trail

SPLIT ROCK

Split Rock Wilds is a destination trail system along the North Shore of Minnesota. This unique and scenic trail system is built on Lake County lands adjacent to the Split Rock Lighthouse State Park. This system was recently highlighted in a [multimedia series prepared by Minnesota Public Radio](#), which was also picked up by [National Public Radio](#). Rock Solid constructed all the trails pictured in this article.

SPLIT ROCK

Where: Two Harbors, MN

When: June 2020 – October 2020
June 2021 – October 2021

Scope: \$1,980,000

The Split Rock Wilds MTB trails are rugged, backcountry trails that will challenge the rider both physically and mentally and reward with beautiful views. The trailhead is at newly built State Park Campground, a perfect staging area for out-of-area riders.

The trails closest to the campground are easier and more approachable for beginners and intermediates. The main trail heads North along a rocky ridgeline and becomes increasingly technical as it weaves in and out of rugged valleys.

In 2021, Rock Solid returned to Split Rock to complete an additional 10 miles of intermediate trails to form a loop with the trail completed in 2019. This 21+ mile loop has become the flagship adventure trail network in the State.

In 2022, Rock Solid will continue the momentum by returning to complete a downhill trail between two existing segments, and a connector to the north trailhead.



“The Split Rock Wilds MTB trails are rugged, backcountry trails that will challenge the rider both physically and mentally and reward with beautiful views.

DAVE CIZMAS, LAKE COUNTRY

Point to Point Advanced Trail

This technical wilderness trail is built with playful features aplenty, including a unique 800' rock bridge at the base of the cliff. With intermediate difficulty, the trail will challenge riders with a dirt berm, a technical rock section, and a giant rock step-up.

SPLIT ROCK

Pine Knob Downhill Trail

Taking advantage of a prominent granite rock outcrop, the technical gravity trail of Pine Knob offers riders breathtaking views, technical rock elements, and wild jumps.



SPLIT ROCK



Base of Pine Knob Trails

This trail is part of the system at the base of Pine Knob near the future campground and alongside Shipwreck Creek. The uphill terrain of this trail features a rock and dirt switchback and is set to open in 2021.

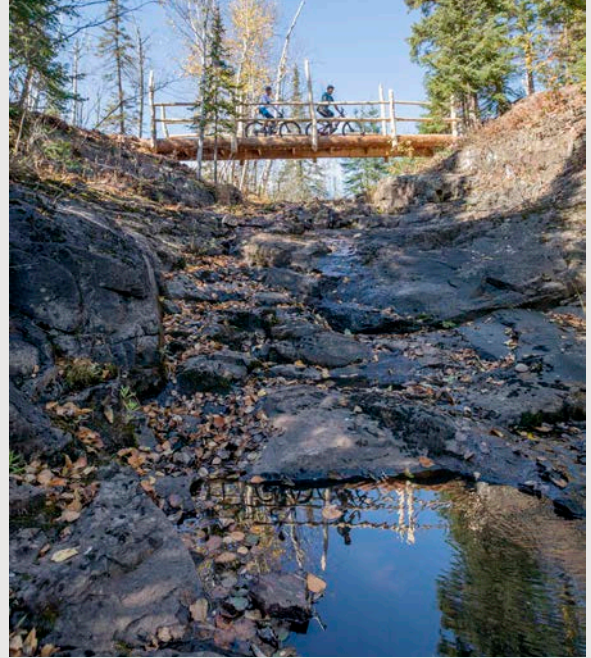

Gateway Bridge

The Gateway Bridge spanning Shipwreck Creek is a completely custom-built wooden bridge that takes riders over rocky and wet terrain. The 36 foot long bridge is constructed from a single spruce log that was split in half and hand hewn with locally milled tamarack decking. Built into the trail is an optional rock roll situated near the campground.

REFERENCE

Lake County Forestry

David Cizmas, Recreation Forester
218.834.8340 | David.Cizmas@co.lake.mn.us

SPLIT ROCK

**Forestry/Land Dept.***Mailing Address*

Lake County Courthouse
601 3rd Ave
Two Harbors, MN 55616

Office Phone: 218-834-8340

To whom it may concern,

In 2020 Lake County Forestry hired Rock Solid Trail Contracting to build phase 1 of the Split Rock Wilds Trail system. This trail system was built on the very rocky and rugged North Shore of Lake Superior. The major challenges to this build were access and terrain. Most of the area required crews to commute by ATV or bicycle to reach the jobsite. The lack of soil and large quantity of rock made for a tough build. The 12 miles of phase 1 was built on time and within budget.

In 2021 Rock Solid returned to build Split Rock Wilds phase 2. The goal of this phase of the project was to create a trail loop throughout the area and increase the trail diversity of the trail system. Adding a trail loop option to improve the trail user experience and open area up to a more diverse range of riders. The Split Rock Wilds Phase 2 was built to be less technical and easier to ride than the trail built in 2020 the terrain is gentler and slightly less rocky. The 9 miles of phase 2 was built on time and within budget.

The crews of Rock Solid Trail Contracting were very professional and easy to work with.

If you have any questions or would like more information about the Split Rock Wilds project, please contact me.

Regards,

Dave Cizmas

Lake County Forestry

David.cizmas@co.lake.mn.us

218-834-8340



INTERMEDIATE
Flow Trail



INTERMEDIATE
Jump Trail



INTERMEDIATE
Hiking Trail



EXPERT
Jump Trail



EXPERT
Technical Trail

HIXON FOREST PARK & GRANDAD'S BLUFF

Rock Solid was honored to participate in trail construction in 2018, 2019, and 2020 at both Hixon Forest Park and nearby Grandad's Bluff in the La Crosse, WI area. Rock Solid constructed ~12 miles of trails between the two. ['Anything but Driftless'](#) is a feature article highlighting these trails in the internationally acclaimed publication, Freehub Magazine. The story was authored by Rock Solid Foreman, Kyle Copeland.

HIXON FOREST PARK & GRANDAD'S BLUFF

Where: La Crosse, WI

When: 2018 - 2020

Scope: \$1,130,000

These trails range in difficulty from intermediate to expert and feature approximately 250-500' of vertical rise.

Since these trails are located in an isolated coulee, they are served by two-way climbing trails and no vehicle shuttle route exists.

These projects are examples of successful grassroots organizing and planning by engaged cyclists and community members. Local organizations Outdoor Recreation Alliance and VeloCity Projects successfully partnered with IMBA Trail Solutions, the City of La Crosse and private sponsors to bring these projects to reality.

Upon completion, these trail systems reclaimed greenspace at the edge of the City which was once regarded by most citizens as a blighted safe haven for unsavory elements of the community, as an asset to improve quality of life and a sense of local pride.



Upper Hixon Forest Park

Upper Hixon Forest Park is located on a bluff complex on the east side of the City of La Crosse, and features a collection of gravity oriented flow and jump trails constructed by Rock Solid.

“ Working with Rock Solid Trail Contracting has always been an excellent experience, from their professionalism on the multiple projects to the diversity of trails they have created. Never before has there been such positive excitement around trail use in our community.

JOSH BLUM, PROJECT PLANNING LEAD, ORA TRAILS



Grandad's Bluff

The Grandad's Bluff project is interconnected with the Hixon Forest Park trails and was completed in 2020. This network features a mix of technical and flow oriented trails with an emphasis on cross country riding. A bonus feature of Grandad's Bluff network, is to serve as a link to the neighborhoods at the foot of the bluff with the trails at Hixon Forest Park.



Nerfherder: Intermediate DH Jump & Flow Trail

This Upper Hixon downhill trail was designed as an intermediate level DH with jumps, berms and rollers. Best resembles a linear pumptrack.



JEDi: Intermediate DH Jump & Flowtech

JEDi is a downhill trail that features drops, large berms, jumps, and rock lines that is easily accessed from the south side of the Upper Hixon parking lot.



Vader: Expert DH Jump Trail

Only master Jedi's dare challenge Vader. High speed sweeping berms. Mandatory gap jumps. A true expert level gravity experience for the Driftless.



Tram: Intermediate Two-way Flow

This Grandad's Bluff two-way intermediate flow trail connects neighborhoods just west of the Bluff with the summit and beyond to the Hixon Forest trails.

HIXON FOREST PARK & GRANDAD'S BLUFF



War Eagle: Expert Two-way Technical

This Grandad's Bluff advanced, two-way technical trail follows the base of exposed limestone cliff bands. Riders will be challenged by the naturally rocky terrain and narrow tread and exhilarated by exposure to steep slopes below the trail.

This combination makes for a signature experience, generally not found elsewhere in the region. This trail features an optional technical line allowing for riders to choose a more advanced route through a rocky section of trail.



Grandad's Hiking Trail: Intermediate Hiking Trail

This trail is exclusively for foot travel. The trail is similar to an intermediate flow purpose built for off-road bicycling but features stair-step-like obstacles and generally lacks in sloped turns.

This trail was designed to provide hikers with an exclusive corridor to avoid negative interactions with cyclists. Hikers and cyclists often share trails without incidents, however, project planners included a hiking only trail in the project design, due to the narrow and steep nature of other trails at Grandad's, which make it more difficult for users to avoid each other.

REFERENCE

Outdoor Recreation Alliance/VeloCity Projects

Jed Olson, Project Manager

320.309.4980 | ibjed@hotmail.com

HIXON FOREST PARK & GRANDAD'S BLUFF



ORA Trails
125 7th St. N
La Crosse WI 54601
www.ORAtrails.org
March 10, 2022

For More info, contact:
Jed Olson
jed@oratrails.org

To Whom It May Concern:

After bringing Rock Solid Trail Contracting to the La Crosse area to work on trail improvement projects in Upper Hixon Forest in 2018 and 2019, the Outdoor Recreation Alliance partnered with Rock Solid to construct a portion of the Gateway Trail System in Grandad Bluff Park again in 2020. The Gateway System is a 6 mile network of shared use trails that provides neighborhood access to the heart of our city while also bringing users through diverse terrains and trail experiences. Although the Gateway Trail System was built from scratch in an area that had no previous trail network, there were still a handful of constraints and tricky logistical challenges. Rock Solid delivered with complete satisfaction and helped build a legacy of recreation in our community.

The trails constructed by Rock Solid range from hike only stone staircases to expert level bike optimized trails. The design and construction are well executed in that they challenge all levels of riders while minimizing user conflict in a shared use setting. The trails were constructed to modern best practices for user experience and physical sustainability. In a time when we are seeing unprecedented weather events, the trails have proven to be well constructed and durable. The trail system has been enjoyed by our community and has been given acclaim by users and media alike.

<https://freehubmag.com/features/anything-driftless>

<https://www.youtube.com/watch?v=Gsl2t-IYvmM>

https://www.youtube.com/watch?v=_6YAEGBBFEY

ORA Trails has been lucky to work with Rock Solid on past projects and we look forward to working with them in future.

Please feel free to reach out for more information-

Jed Olson
Executive Director ORA Trails



BEGINNER
Flow Trail



BEGINNER
Jump Trail



EXPERT
Jump Trail



EXPERT
Technical Trail

GIANT'S RIDGE

Giant's Ridge is one of Northern Minnesota's premier outdoor recreation destinations. This well-established alpine ski and snowboard resort, just outside Biwabik, MN, expanded its portfolio to include lift-access mountain biking in 2020.

Note: The trails close whenever the chairlift is not operating.

GIANT'S RIDGE

Where: Biwabik, MN

When: May 2019 - Feb 2020

Scope: \$823,595

Situated along the Laurentian Divide, Giant's Ridge occupies a prominent granite ridgeline which rises approximately 500' vertical feet above the surrounding landscape of forests, lakes and streams.

This setting allows for trails to take advantage of exposed granite and steep slopes generally absent from other Minnesota trail networks. Access to the summit is on the Sarajevo Express Chairlift, which affords sweeping views of Wynee and Sabin Lakes at the base of the resort and beyond to unbroken forests.

Rock Solid's constructed approximately 1.5 miles of beginner downhill and 1.1 miles of expert downhill trails during 2019 and 2020.



Tadpole: Beginner Flow Trail

This trail starts out mellow and gradually progresses in difficulty throughout the ride. This trail has man-made rollers, berms, rock crossings, and forgiving jump opportunities. This trail provides beginner riders a place to practice and progress before heading to Leap Frog. It is worth noting that while Tadpole is a green trail that is suited for beginners, it can be challenging for riders who are new to downhill mountain biking.

“Rock Solid has trained their foremen and crews well—they work efficiently, leave a clean finished product, and you always get a well-built trail that's a blast to ride! Having worked with 6+ different builders in the last 4 build seasons, I can say that Rock Solid's reputation is indeed Rock Solid!

**BEJI NEFF, DIRECTOR OF MOUNTAIN SPORTS,
GIANT'S RIDGE**



Ribbit One & Two: Beginner Flow & Jump Trail

The first and second of three sections of trail that pop in and out of Tadpole. These sections are designed to give beginners a place to start their downhill mountain bike experience, with an introduction to small berms and table top jumps with ride-arounds on a gentle wide-open trail.



GIANT'S RIDGE

“

"Giant's Ridge is an outstanding Minnesota bike park. With the unique natural terrain and modern infrastructure, it stands above other resorts in the Midwest. While the terrain presented a challenge, the steep slopes, exposed granite and clay/gravel soil provided a rare canvas for creative trail design."

NILS HEMPLE, GIANT'S RIDGE FOREMAN,
ROCK SOLID TRAIL CONTRACTING

”



Goliath: Expert Jump Trail

Don't let the easy start fool you. Goliath is the Giant of the Ridge. The first descent is fast, chundery, and steep. The trail quickly transitions into two behemoth berms. The trail then starts to introduce some large jumps as you weave in and out of the ski runs.

Be sure to be on your "A game" as you cross under the Sarajevo Express, you don't want all your buddies on the lift to see you eat it. The trail stays rowdy all the



Granite Gorge: Expert Technical Trail

Granite Gorge has two lines. The A line takes you down into a gorge formed by two giant slabs of granite, while the B line rolls off the steep, but smooth side of the slab. The trail then crosses a ski run and turns a corner on an incredible granite berm.

After alternating between granite slabs and panels, there are a few short sections of dirt before one final massive rock panel. Then the trail turns to the left, crosses two ski runs, and joins up with the lower section of Goliath.



GIANT'S RIDGE REFERENCE

Iron Range Resources Rehabilitation Board
Scott Linnenburger (of Kay-Linn Enterprises), Project Manager
303.241.3301 | scott@kay-linn.com



Rock Solid frequently constructs bridges and flyovers, usually over water crossings and other bike trails. These bridges vary in size, complexity, and construction type; from straight cedar log bridges to steel bridges with multiple complex curves.

BRIDGE CAPABILITIES

Rock Solid can install pre-engineered or fabricated bridges, although custom work is typically requested. In-house CAD drawing services can be coordinated by Rock Solid with an engineer as needed. Our fabrication crew has extensive capabilities and experience fabricating structures in the field and the shop.

BRIDGE EXAMPLE

UNION CREEK BRIDGE

Where: Grant Township, MI

When: Summer 2020 & 2021

Scope: Rock Solid Community Investment

Rock Solid is currently constructing a bridge over Union Creek along the Keweenaw Point Trail - Owleyes section. The new bridge and trail segment will connect the Summer School Trail within East Bluff Bike Park to the existing Keweenaw Point Trail to the east, making it possible to ride the KPT contiguously all the way to High Rock Bay.

The stone bridge abutments were built in the summer of 2020. Rock Solid has created CAD documents for a new bridge span to be completed in the 2021 Summer build season once weather conditions are more favorable.

A new bridge span of approx. 24' long and 60" wide will be constructed utilizing hand-stripped, locally sourced cedar, including a curved, split log stringer that has already been harvested, roundwood handrails, and milled decking.

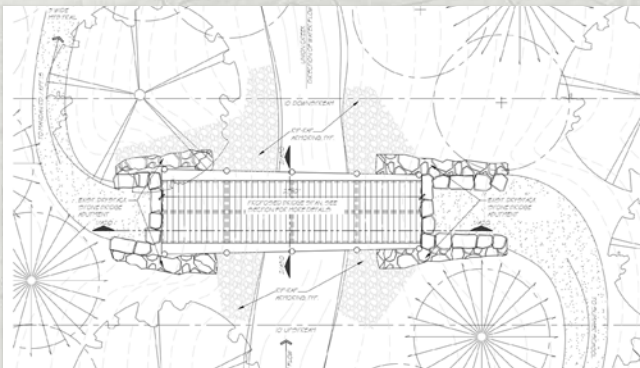
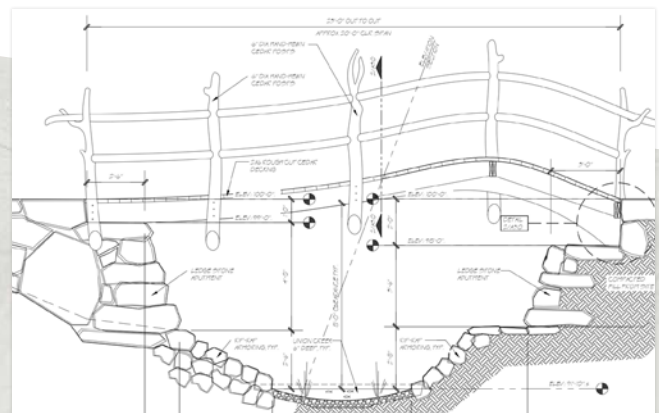
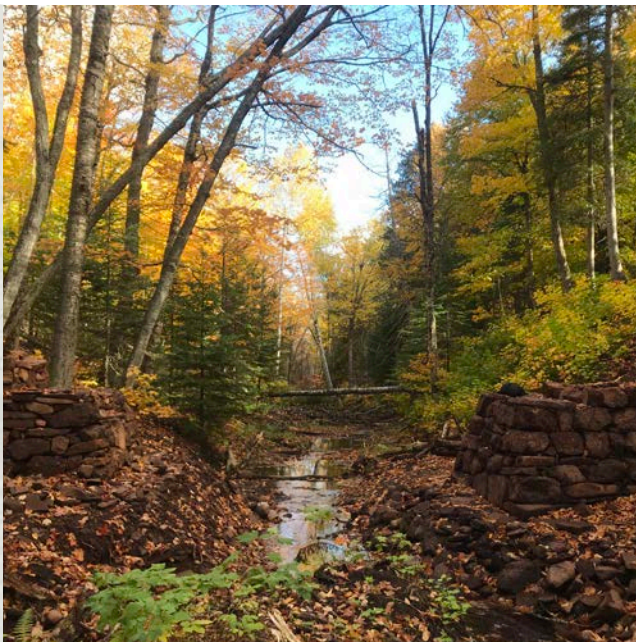

BRIDGE EXAMPLE #2

WHOOPTY WOO BRIDGE

Where: Copper Harbor, MI

When: Fall 2018

Scope: Rock Solid Community Investment
(Approximately \$3,500)

Rock Solid Trail Contracting removed and replaced the West Woopidy Woo trail bridge over Garden Brook in the fall of 2018. The existing bridge had failed prematurely due to washouts caused by spring snowmelt and heavy rain conditions in the area.

New bridge abutments were built with site sourced rock to reinforce the bank and prevent washouts. A new bridge span of approximately 16' long and 30" wide was constructed from hand-stripped, locally sourced cedar, including a split log stringer, roundwood handrails, and milled decking.



REFERENCE

Copper Harbor Trails Club

Nathan Miller, Executive Director
nathan@copperharbortrails.org

BRIDGE EXAMPLE #3

MT. NEBO HWY 155 BRIDGE

Where: Mt. Nebo State Park, Dardanelle, AR
When: 2020
Scope: N/A

Rock Solid constructed a steel bridge approximately 22' in length to enhance the experience of the downhill trail near Highway 155.

The bridge is a compound curved structure bringing the rider near a natural waterfall. Constructed of welded steel, the bridge is engineered with anti-slip deck boards to maximize the lifespan of the structure.



REFERENCE

Arkansas Parks & Recreation Foundation
Amber Chambers, Trail Project Manager
913.653.4059 | amber@arparksfoundation.com



2023-2027 - 5 YEAR CAPITAL IMPROVEMENT PLAN
WOOD COUNTY PARKS & FORESTRY DEPARTMENT

DESCRIPTION	2023				2024				2025				2026				2027			
	#	TL	DS	GR	#	TL	DS	GR	#	TL	DS	GR	#	TL	DS	GR	#	TL	DS	GR
Fleet Vehicle Replacement		\$45,000				\$45,000				\$45,000				\$45,000				\$45,000		
Road/Parking Lot Improvements			\$80,000				\$80,000			\$80,000				\$80,000				\$80,000		
Trail Improvements/Development							\$80,000											\$80,000		
Bulldozer Replacement		\$60,000																		
Tractor Replacement										\$50,000								\$50,000		
Backhoe Replacement														\$60,000						
Playground Replacement							\$50,000							\$50,000						
South Park Shop Improvements			\$50,000																	
South Park Storm Shelter			\$81,000	\$562,000																
Dexter Beach House/Shelter Construction							\$250,000	\$250,000												
Powers Bluff Shop Construction			\$150,000	\$100,000																
Dexter ATV Campground Expansion								\$750,000												
Powers Bluff Trailhead Road/Parking Lot			\$250,000	\$250,000																
Powers Bluff Trailhead Shelter Building										\$500,000	\$500,000									
Powers Bluff Snowmaking Equipment/Pond														\$750,000						
North Park Swimming Pond Construction																		\$100,000		
South Park 2nd Campground Construction														\$1,000,000	\$500,000					
South Park Kayak Launch																		\$50,000	\$50,000	
North Park 2nd Camper Dump Station						\$50,000														
North Park Campsite Electrical 50A Upgrades			\$70,000																	
TOTAL		\$105,000	\$611,000	\$912,000		\$95,000	\$460,000	\$1,000,000		\$95,000	\$580,000	\$500,000		\$105,000	\$1,880,000	\$500,000		\$95,000	\$310,000	\$50,000
		TL	DS	GR		TL	DS	GR		TL	DS	GR		TL	DS	GR		TL	DS	GR

Tax Levy (TL)
Debt Service (DS)
Grant (GR)

Contract Extension Notes – April 2022

#741 Thurs Logging

- Bid April 2016 – original contract expiration: April 1, 2018.
- Contract Extensions: four (current extension expired March 31, 2022). **One extension carried a 5% increase in stumpage.**
- % completion = 17%
- Job constraints: Seasonally wet access, portions of sale area require frozen conditions for access. Oak wilt restriction.
- Considerations: This is the only contract this contractor holds on Wood County Forest. Contractor quality of work on past contracts has been very good. Although logging conditions on this sale were good to excellent the past two winters, contractor did not attempt to operate on this contract. Verso mill closure has resulted in loss of market for many central Wisconsin loggers, especially for aspen and hardwood pulpwood. Mx Hdwd pulpwood was cruised at 44%, and Aspen pulpwood was cruised at 8% of total sale volume.
- Contractor cut one small patch (about 4 acres) just before deer season (fall 2019).
- Total sale area encompasses 23 acres, in 5 small cutting units.
- Contractor has generated **\$0.00** total revenue to the county forest **the past two years.**

Recommendation:

Do not grant contract extension and rebid the remaining timber on this contract. Retain performance bond until reestablishment costs and new bid value is obtained. Once this is determined, then the county may decide to collect all, or a portion of the performance bond as damages.

#744 Delaney Forest Products

- Bid April 2016 – original contract expiration: April 1, 2018.
- Contract extensions: four (current extension expired March 31, 2021). **One contract extension carried a 5% increase in stumpage.**
- % completion = 0%
- Job Constraints: Seasonally wet access, Requires frozen ground for access and to operate, oak wilt restriction, access across private land.
- Considerations: Contractor has completed many Wood County Forest contracts in the past. Contractor currently holds no other contracts on Wood County Forest. Contractor has good history of payments and quality of work is excellent. Although logging conditions on this sale were good to excellent the past two winters, contractor did not attempt to operate on this contract. Verso mill closure has resulted in loss of market for many central Wisconsin loggers, especially for aspen and hardwood pulpwood. Mx Hdwd pulpwood was cruised at 56%, and Aspen pulpwood was cruised at 44% of total sale volume.
- Contractor has generated **\$0.00** total revenue to the county forest **the past two years.**

Recommendation:

Do not grant contract extension and rebid the timber on this contract. Retain performance bond until reestablishment costs and new bid value is obtained. Once this is determined, then the county may decide to collect all, or a portion of the performance bond as damages.

#775 Country Forest Products

- Bid March 2019 – original contract expiration: April 1, 2021.
- Contract Extensions: one.
- % completion = 75%
- Job Constraints: This is the only contract this contractor holds on the Wood County Forest. Seasonally wet access, frozen ground will most likely be necessary for harvest and trucking. Oak wilt restriction. Verso mill closure has resulted in loss of market for many central Wisconsin loggers, especially for aspen and hardwood pulpwood. Aspen pulpwood was cruised at 33%, and Mx Hdwd. Pulpwood was cruised at 49% of total sale volume.
- Total sale area encompasses 44 acres.
- Contractor operated on this sale this past winter. However was unable to complete it due to early thaw and deterioration of access road.
- Contractor has generated **\$28,762.52** total revenue to the county forest in the past year.

Recommendation: Grant contract extension to March 31, 2023 **with NO increase.**

Committee Report

County of Wood

Report of claims for: PARKS & FORESTRY DEPT.

For the period of: MARCH FOR (APRIL HIRC)

For the range of vouchers: 21220101 - 21220183

Voucher	Vendor Name	Nature of Claim	Doc Date	Amount	Paid
21220101	AMAZON CAPITAL SERVICES	Laminate Cartridges for Office	02/23/2022	\$564.85	P
21220102	AMAZON CAPITAL SERVICES	Cardboard Tubes	02/23/2022	\$54.83	P
21220103	MENARDS-MARSHFIELD	Assorted Supplies for PB/NP	02/23/2022	\$40.68	P
21220104	MSC INC	Vinyl Dock Edging for SP	02/23/2022	\$143.97	P
21220105	SCHMIDTY'S GOLF CAR	'12 Yamaha Electric Golf Cart-DP	02/23/2022	\$5,770.00	P
21220106	US BANK	Postage, Mats, Medical Supplies, Etc.	02/23/2022	\$814.48	P
21220107	ACE HARDWARE	Plumbing Items for SP Shop	03/02/2022	\$35.56	P
21220108	ACE HARDWARE	Plumbing Supplies for SP Shop	03/02/2022	\$21.99	P
21220109	ARPIN LIONS CLUB	Ad-Central WI Vintage Snow Race	03/02/2022	\$250.00	P
21220110	DIAMOND BUSINESS GRAPHICS	Tube and Ski Tickets for PB	03/02/2022	\$3,894.54	P
21220111	POWER PAC INC	JD Tractor 4044R, Bucket, Forks	03/02/2022	\$38,788.19	P
21220112	RAPID CONTROL SYSTEMS LLC	Dam Controls Project-50%-DP	03/02/2022	\$8,550.00	P
21220113	RAPIDS RENTAL & SUPPLY	Stihl Helmet and Supplies-SP	03/02/2022	\$123.98	P
21220114	WATER WORKS & LIGHTING COMM	Electric Service for SP Shop	03/02/2022	\$163.48	P
21220115	WATER WORKS & LIGHTING COMM	Electric Service for SP Dam	03/02/2022	\$230.35	P
21220116	WATER WORKS & LIGHTING COMM	Electric Srv-SP-E/SP-O Shelter	03/02/2022	\$39.90	P
21220117	WATER WORKS & LIGHTING COMM	Electric Srv-Cabin, 1st Loop	03/02/2022	\$184.85	P
21220118	WATER WORKS & LIGHTING COMM	Electric Srv-2nd Loop H-Panel	03/02/2022	\$12.36	P
21220119	WATER WORKS & LIGHTING COMM	Electric Service-SP Showers	03/02/2022	\$15.77	P
21220120	WATER WORKS & LIGHTING COMM	Electric Srv-White Beach Pavilion	03/02/2022	\$43.23	P
21220121	WATER WORKS & LIGHTING COMM	Electric Srv-1st Loop Sites-SP	03/02/2022	\$12.36	P
21220122	WATER WORKS & LIGHTING COMM	Electric Service-RSBP at SP	03/02/2022	\$45.08	P
21220123	WATER WORKS & LIGHTING COMM	Electric Srv-2nd Loop Sites-SP	03/02/2022	\$12.36	P
21220124	WATER WORKS & LIGHTING COMM	Electric Srv-3rd Loop Sites-SP	03/02/2022	\$26.48	P
21220125	BUDS CORNER MART	Gas for #767-SP	03/09/2022	\$45.10	P
21220126	BUDS CORNER MART	Gas for #561-SP	03/09/2022	\$77.64	P
21220127	BUDS CORNER MART	Gas for #598-SP	03/09/2022	\$79.31	P
21220128	BUDS CORNER MART	Gas for #533-SP	03/09/2022	\$41.77	P
21220129	GRIFFITH STATE NURSERY	Seedlings for Parks	03/09/2022	\$222.00	P
21220130	LAKESIDE OASIS LLC	Gas for Dexter and Forestry	03/09/2022	\$943.43	P
21220131	OAKDALE ELECTRIC CO	Electric Srv-Bath House-DP	03/09/2022	\$33.22	P
21220132	OAKDALE ELECTRIC CO	Electric Service-DP Dam Area	03/09/2022	\$116.70	P
21220133	OAKDALE ELECTRIC CO	Electric Srv-#3 Vault Area-DP	03/09/2022	\$33.22	P
21220134	OAKDALE ELECTRIC CO	Electric Srv-Shelter, Boat Landing	03/09/2022	\$51.15	P
21220135	OAKDALE ELECTRIC CO	Electric Srv-#2 Shower Area-DP	03/09/2022	\$33.22	P
21220136	OAKDALE ELECTRIC CO	Electric Srv-Smitty Storage-DP	03/09/2022	\$41.22	P
21220137	OAKDALE ELECTRIC CO	Electric Srv-Group Sites Area	03/09/2022	\$38.42	P
21220138	OAKDALE ELECTRIC CO	Electric Srv-Host, Full Sites	03/09/2022	\$33.22	P
21220139	OAKDALE ELECTRIC CO	Electric Srv-#1 Sites, Showers	03/09/2022	\$33.22	P

PARKS & FORESTRY DEPT. - MARCH FOR
(APRIL HIRC)

21220101 - 21220183

21220140	OAKDALE ELECTRIC CO	Electric Srv-Cabin, Dump Area, Etc.	03/09/2022	\$136.44	P
21220141	OAKDALE ELECTRIC CO	Electric Srv-Loop 3 Sites-DP	03/09/2022	\$33.22	P
21220142	OAKDALE ELECTRIC CO	Electric Service for DP Shop	03/09/2022	\$263.15	P
21220143	PITTSVILLE FARM & HOME CENTER	Supplies for Forestry	03/09/2022	\$18.86	P
21220144	PITTSVILLE FARM & HOME CENTER	Supplies for DP	03/09/2022	\$16.97	P
21220145	PITTSVILLE FARM & HOME CENTER	Supplies for NP	03/09/2022	\$9.60	P
21220146	PITTSVILLE FARM & HOME CENTER	Supplies for DP	03/09/2022	\$0.99	P
21220147	POWER PAC INC	Item for DP	03/09/2022	\$43.16	P
21220148	PROVISION PARTNERS	Gas, Diesel-#569,#609-Forestry	03/09/2022	\$363.87	P
21220149	PROVISION PARTNERS	Gas for #581-Forestry	03/09/2022	\$11.74	P
21220150	PROVISION PARTNERS	Gas for #569 & #581-Forestry	03/09/2022	\$61.45	P
21220151	REIGEL PLUMBING & HEATING	Plumbing Item for DP	03/09/2022	\$14.99	P
21220152	WE ENERGIES	Gas Service for SP	03/09/2022	\$10.56	P
21220153	DUVALL HEATING AND HYDRONICS LLC	Firewood Processing for DP	03/09/2022	\$5,971.00	P
21220154	ADVANCE AUTO PARTS (Atlanta GA)	Items for SP Plow Truck	03/16/2022	\$24.76	P
21220155	ALLIANT ENERGY/ WP&L	Electric Srv-ATV Shelter Area	03/16/2022	\$23.91	P
21220156	ALLIANT ENERGY/ WP&L	Electric Srv for Nepco Shelter	03/16/2022	\$240.63	P
21220157	ALLIANT ENERGY/ WP&L	Electric Srv-NP Cabin, Hosts Site	03/16/2022	\$148.39	P
21220158	ALLIANT ENERGY/ WP&L	Electric Srv-NP Water Sites	03/16/2022	\$16.12	P
21220159	ALLIANT ENERGY/ WP&L	Electric Srv-Shelter, Bath House	03/16/2022	\$16.24	P
21220160	ALLIANT ENERGY/ WP&L	Electric Srv-Bridge, Sites-NP	03/16/2022	\$16.12	P
21220161	ALLIANT ENERGY/ WP&L	Electric Srv-Shower & Sites-NP	03/16/2022	\$16.24	P
21220162	ALLIANT ENERGY/ WP&L	Electric Srv-New Shower, Sites	03/16/2022	\$16.12	P
21220163	ALLIANT ENERGY/ WP&L	Electric Srv-Shop, Dump Area	03/16/2022	\$104.25	P
21220164	ALLIANT ENERGY/ WP&L	Electric Srv-Hawthorne Hill Sites-NP	03/16/2022	\$16.12	P
21220165	ALLIANT ENERGY/ WP&L	Electric Service for PB	03/16/2022	\$578.96	P
21220166	AMAZON CAPITAL SERVICES	Waterfree Urinal Cartridges	03/16/2022	\$605.99	P
21220167	AMAZON CAPITAL SERVICES	Reflective Road Triangles	03/16/2022	\$27.98	P
21220168	AMAZON CAPITAL SERVICES	Waterless Urinal Cartridges	03/16/2022	\$258.57	P
21220169	ADVANCE AUTO PARTS - WR Jackson St	Supplies for Skidsteer	03/16/2022	\$46.89	P
21220170	HEITING TERESA	PB Shelter Cancellation	03/16/2022	\$135.00	P
21220171	HOME DEPOT CREDIT SERV (Highway)	Assorted Items	03/16/2022	\$930.38	P
21220172	INSIGHT FS	LP for Nepco	03/16/2022	\$427.81	P
21220173	INSIGHT FS	LP for NP Shop	03/16/2022	\$844.59	P
21220174	INSIGHT FS	LP for PB Shelter	03/16/2022	\$214.08	P
21220175	INSIGHT FS	LP for PB Shop	03/16/2022	\$332.48	P
21220176	INSIGHT FS	LP for DP Shop	03/16/2022	\$500.04	P
21220177	QUALITY DOOR & HARDWARE	Exit Device w/Install-Nepco Shelter	03/16/2022	\$1,368.27	P
21220178	RAPIDS RENTAL & SUPPLY	Supplies for SP	03/16/2022	\$40.97	P
21220179	THOMPSON RHONDA	RSBP Cancellation	03/16/2022	\$135.00	P
21220180	AMAZON CAPITAL SERVICES	Speed Bumps for DP	03/23/2022	\$344.41	P
21220181	ROLYAN BUOYS	Buoys for SP	03/23/2022	\$405.54	P
21220182	US BANK	WPRA Hotel, PB Tow Permits	03/23/2022	\$928.40	
21220183	WASTE MANAGEMENT	Monthly Garbage Service	03/23/2022	\$912.58	P
Grand Total:				\$78,294.97	

Signatures

106

Committee Chair:

Committee Member:

Committee Member:

Committee Member:

Committee Member:

Committee Member:

Committee Member:

Committee Member:

Committee Member:
